

NOTE:
WHEN NEW OVERHEAD SIGNS ARE
REPLACING EXISTING OVERHEAD SIGNS,
MODIFY EXISTING OVERHEAD STRUCTURE
TO ACCOMMODATE NEW SIGNS AND LOCATION
OF HANGERS.

PROVIDE GLARE SCREENS ON NEW OVERHEAD
STRUCTURES AND EXISTING STRUCTURES
WHEN INSTALLING NEW OH SIGNS.

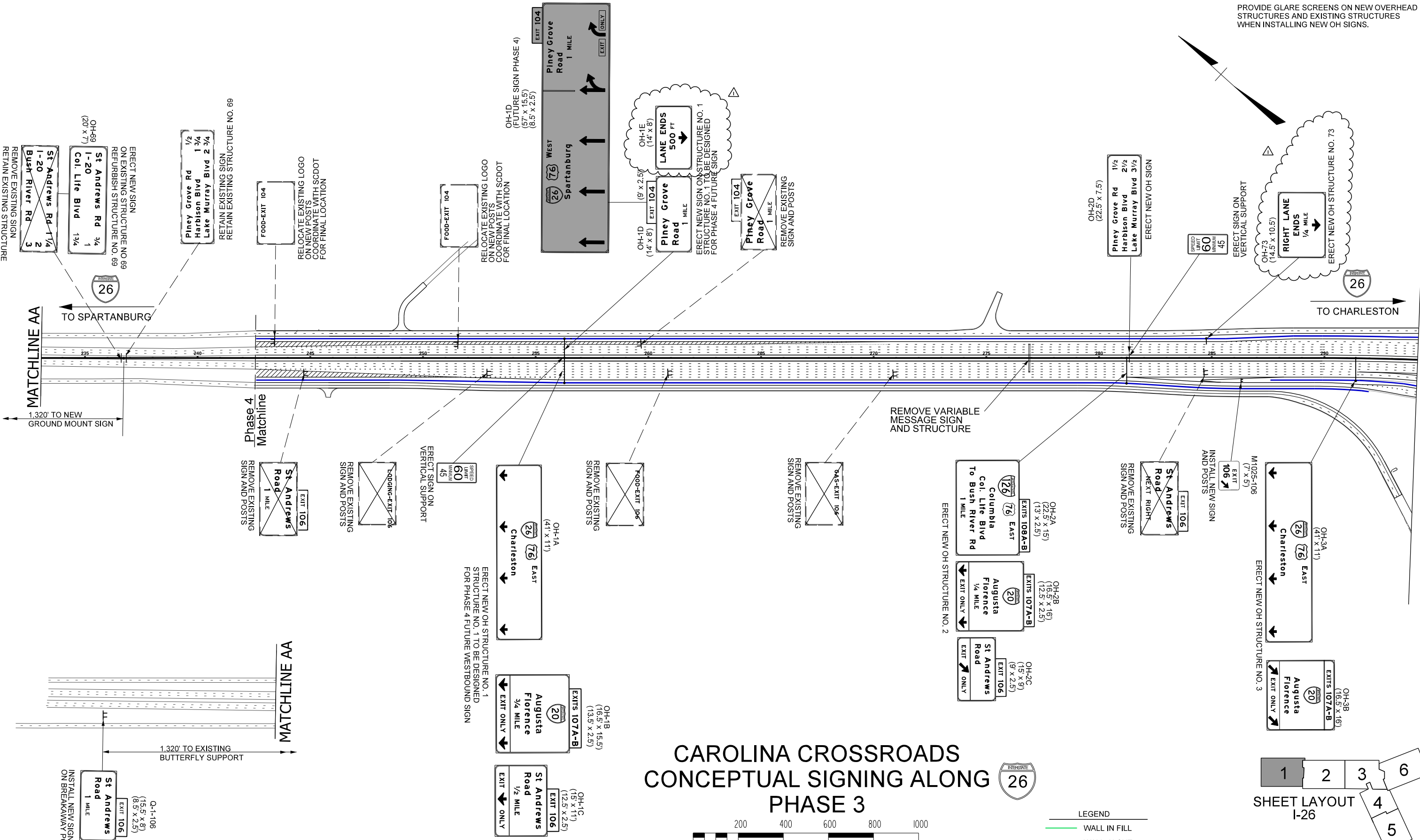

CAROLINA CROSSROADS CONCEPTUAL SIGNING ALONG PHASE 3

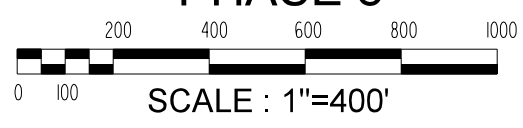

- LEGEND
- WALL IN FILL
 - WALL IN CUT
 - MEDIAN BARRIER

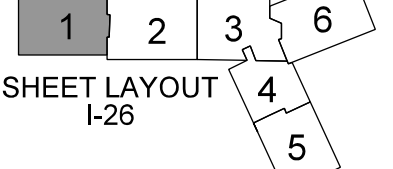

REV. NO.	BY	DATE	DESCRIPTION OF REVISION
1	DOT	07-07-23	ADDED ON STRUCTURES FOR LANE ENDS

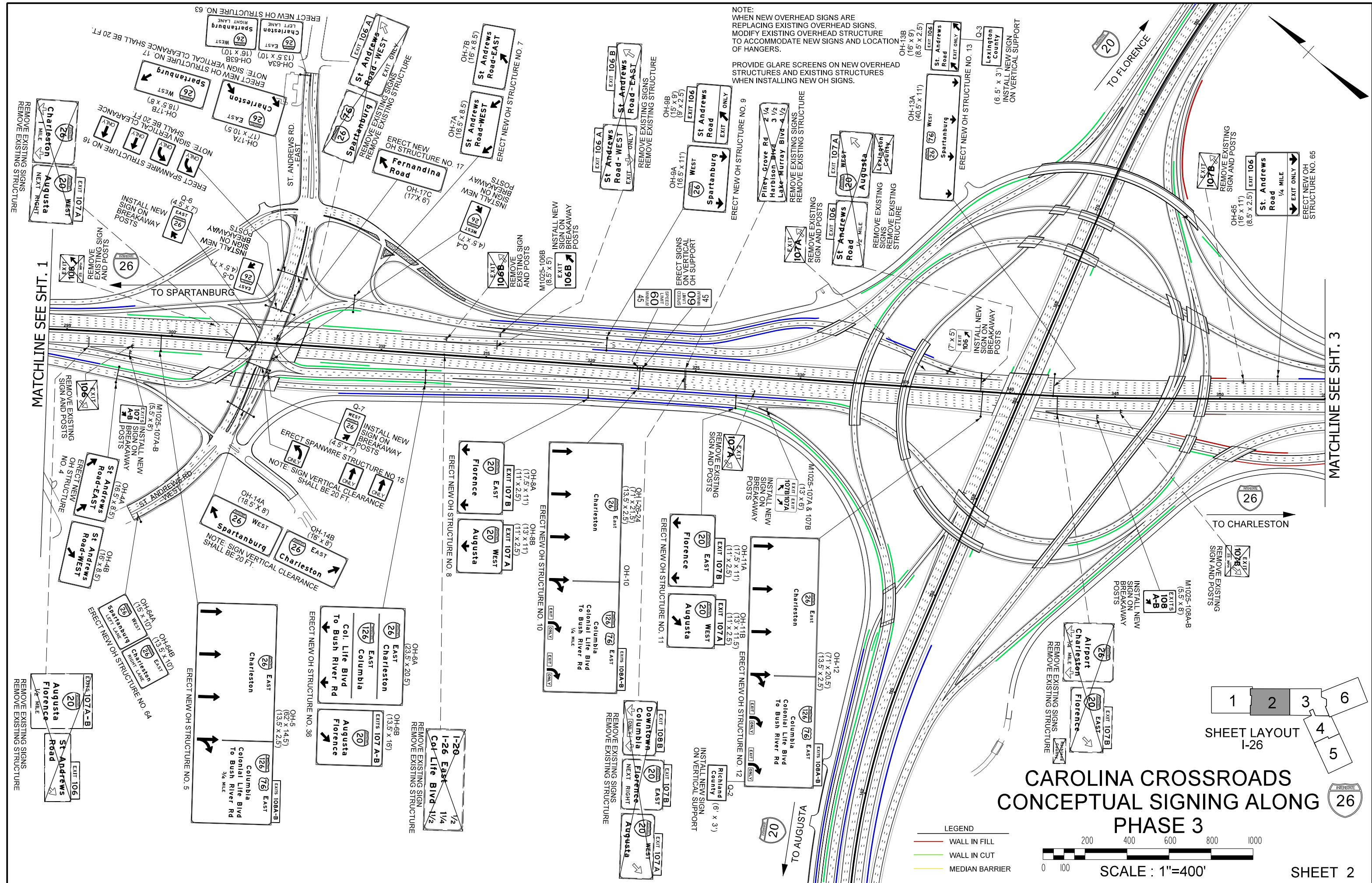

NOTE:
 WHEN NEW OVERHEAD SIGNS ARE REPLACING EXISTING OVERHEAD SIGNS, MODIFY EXISTING OVERHEAD STRUCTURE TO ACCOMMODATE NEW SIGNS AND LOCATION OF HANGERS.

PROVIDE GLARE SCREENS ON NEW OVERHEAD STRUCTURES AND EXISTING STRUCTURES WHEN INSTALLING NEW OH SIGNS.

- LEGEND
- WALL IN FILL
 - WALL IN CUT
 - MEDIAN BARRIER

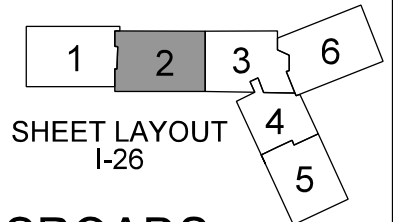
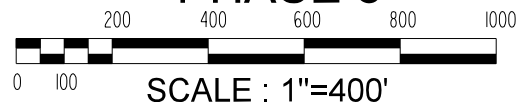

CAROLINA CROSSROADS CONCEPTUAL SIGNING ALONG PHASE 3



MATCHLINE SEE SHT. 1

MATCHLINE SEE SHT. 3

TO SPARTANBURG

TO CHARLESTON

TO AUGUSTA

TO FLORENCE

NOTE:
WHEN NEW OVERHEAD SIGNS ARE REPLACING EXISTING OVERHEAD SIGNS, MODIFY EXISTING OVERHEAD STRUCTURE TO ACCOMMODATE NEW SIGNS AND LOCATION OF HANGERS.

PROVIDE GLARE SCREENS ON NEW OVERHEAD STRUCTURES AND EXISTING STRUCTURES WHEN INSTALLING NEW OH SIGNS.

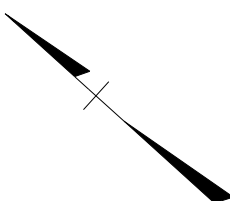

MATCHLINE SEE SHT. 2

MATCHLINE SEE SHT. 6

CAROLINA CROSSROADS CONCEPTUAL SIGNING ALONG PHASE 3

- LEGEND
- WALL IN FILL
 - WALL IN CUT
 - MEDIAN BARRIER

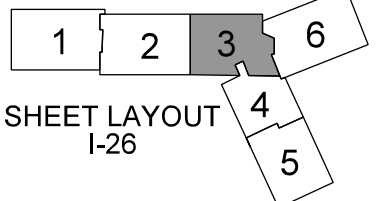
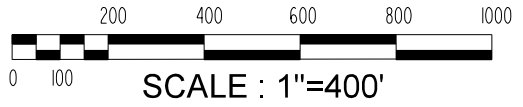

SHEET LAYOUT
I-26

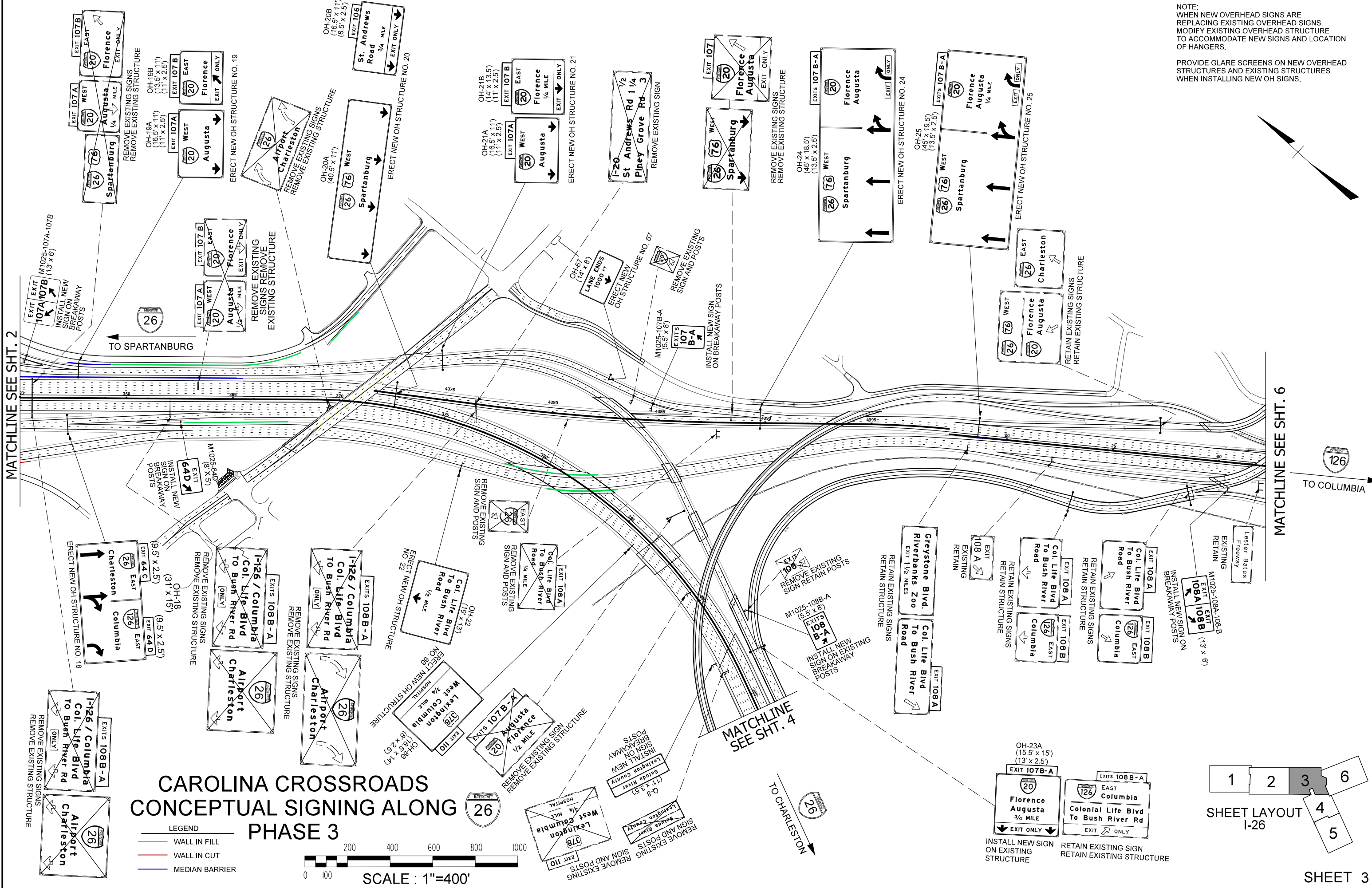

NOTE:
 WHEN NEW OVERHEAD SIGNS ARE REPLACING EXISTING OVERHEAD SIGNS, MODIFY EXISTING OVERHEAD STRUCTURE TO ACCOMMODATE NEW SIGNS AND LOCATION OF HANGERS.
 PROVIDE GLARE SCREENS ON NEW OVERHEAD STRUCTURES AND EXISTING STRUCTURES WHEN INSTALLING NEW OH SIGNS.

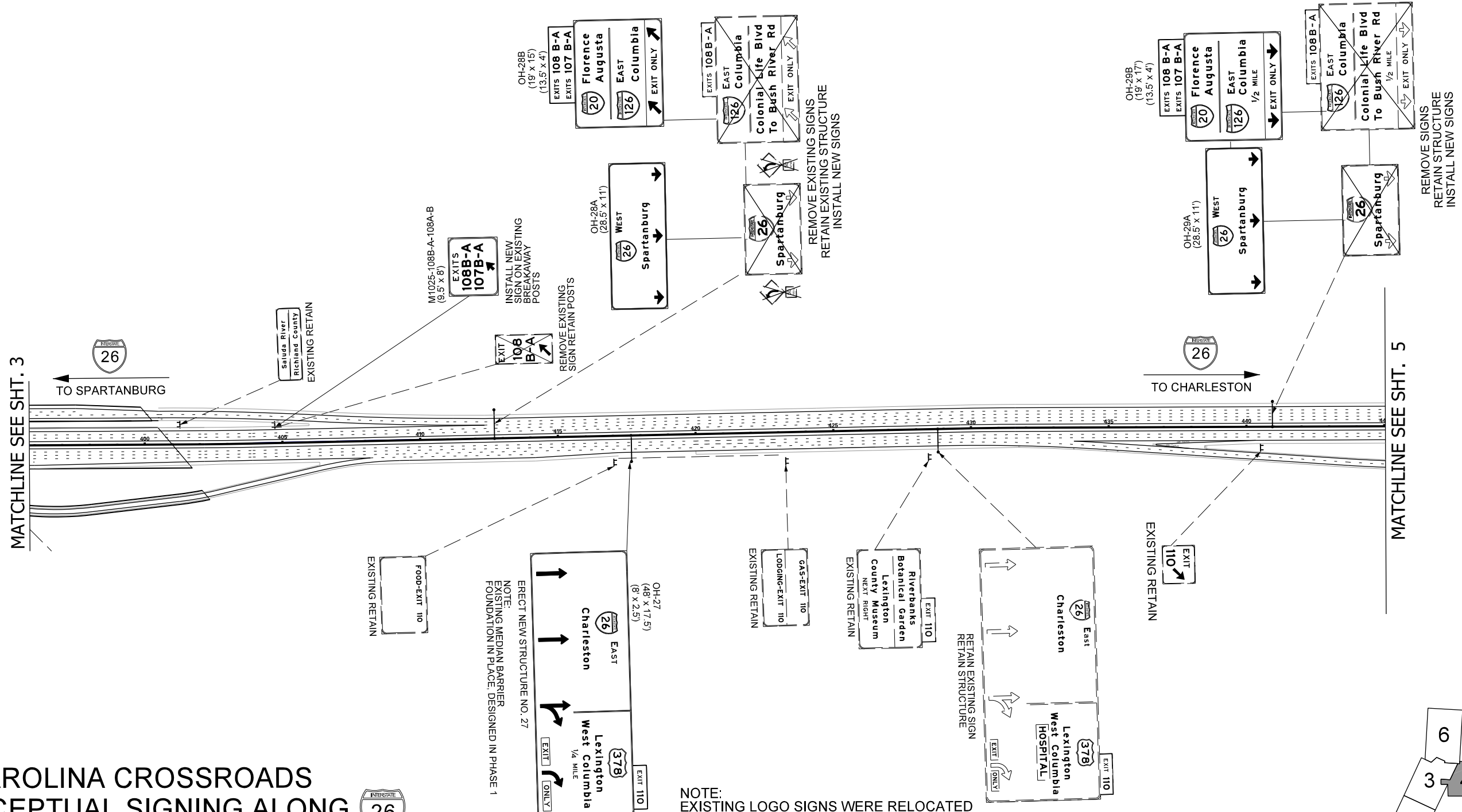

CAROLINA CROSSROADS CONCEPTUAL SIGNING ALONG PHASE 3



- LEGEND**
- WALL IN FILL
 - WALL IN CUT
 - MEDIAN BARRIER



ERECT NEW STRUCTURE NO. 27
 NOTE:
 EXISTING MEDIAN BARRIER FOUNDATION IN PLACE, DESIGNED IN PHASE 1

NOTE:
 EXISTING LOGO SIGNS WERE RELOCATED DURNING PHASE 1 CONSTRUCTION.
 CONTRACTOR SHALL VERIFY LOCATIONS

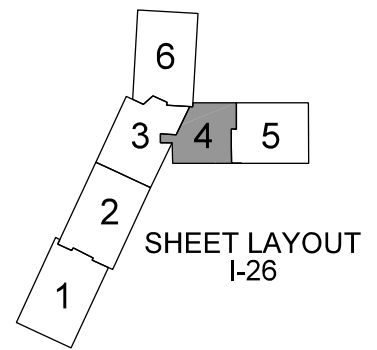

NOTE:
 WHEN NEW OVERHEAD SIGNS ARE REPLACING EXISTING OVERHEAD SIGNS, MODIFY EXISTING OVERHEAD STRUCTURE TO ACCOMMODATE NEW SIGNS AND LOCATION OF HANGERS.
 PROVIDE GLARE SCREENS ON NEW OVERHEAD STRUCTURES AND EXISTING STRUCTURES WHEN INSTALLING NEW OH SIGNS.

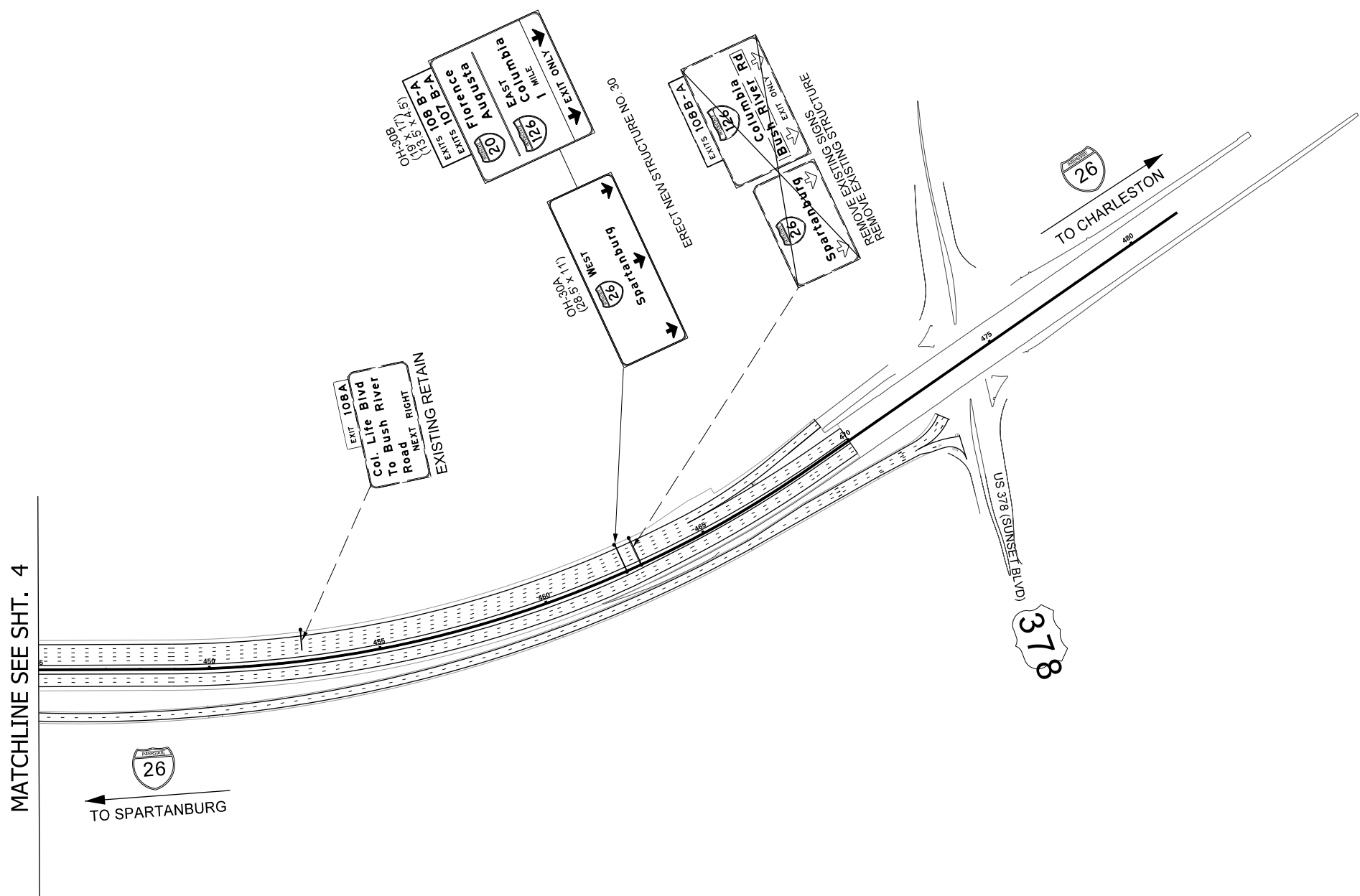
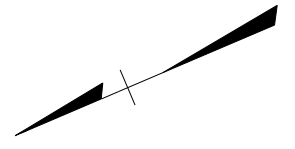

MATCHLINE SEE SHT. 4



CAROLINA CROSSROADS CONCEPTUAL SIGNING ALONG PHASE 3



- LEGEND
- WALL IN FILL
 - WALL IN CUT
 - MEDIAN BARRIER

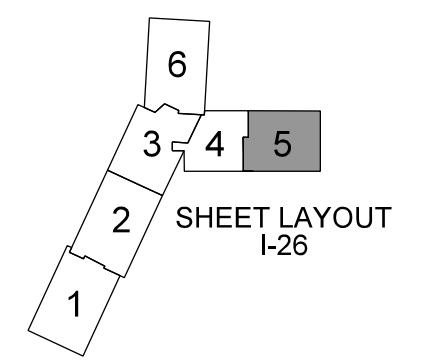
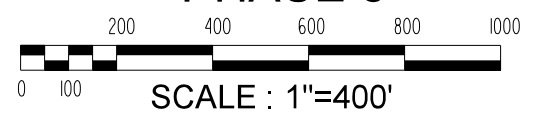

NOTE:
WHEN NEW OVERHEAD SIGNS ARE REPLACING EXISTING OVERHEAD SIGNS, MODIFY EXISTING OVERHEAD STRUCTURE TO ACCOMMODATE NEW SIGNS AND LOCATION OF HANGERS.

PROVIDE GLARE SCREENS ON NEW OVERHEAD STRUCTURES AND EXISTING STRUCTURES WHEN INSTALLING NEW OH SIGNS.

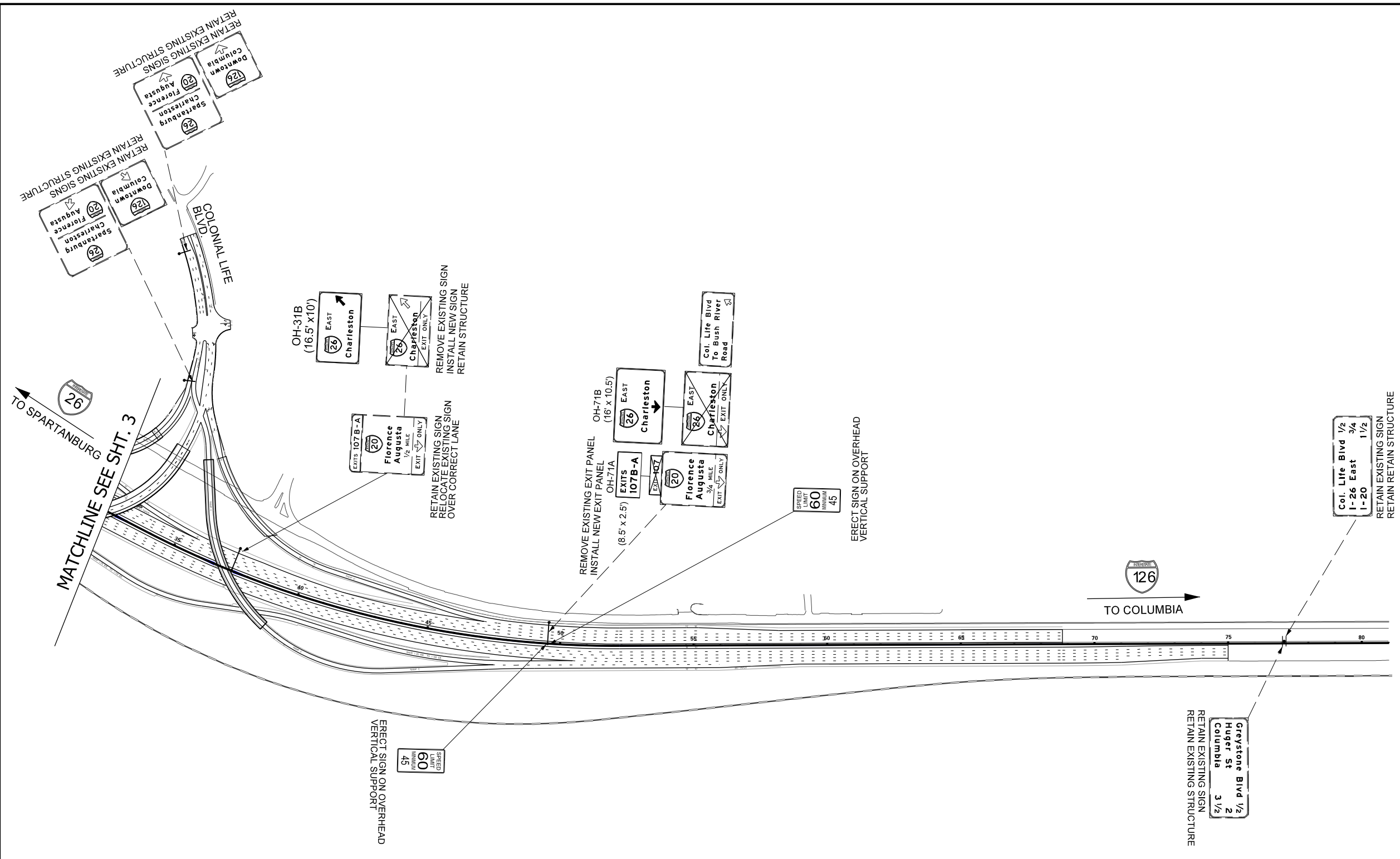
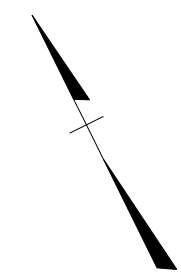

CAROLINA CROSSROADS CONCEPTUAL SIGNING ALONG PHASE 3

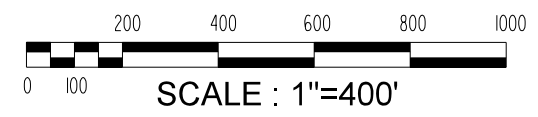
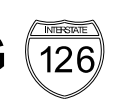

- LEGEND
- WALL IN FILL
 - WALL IN CUT
 - MEDIAN BARRIER

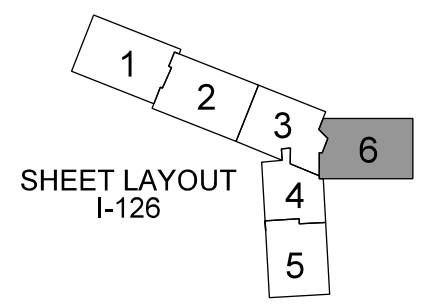

NOTE:
 WHEN NEW OVERHEAD SIGNS ARE REPLACING EXISTING OVERHEAD SIGNS, MODIFY EXISTING OVERHEAD STRUCTURE TO ACCOMMODATE NEW SIGNS AND LOCATION OF HANGERS.

PROVIDE GLARE SCREENS ON NEW OVERHEAD STRUCTURES AND EXISTING STRUCTURES WHEN INSTALLING NEW OH SIGNS.

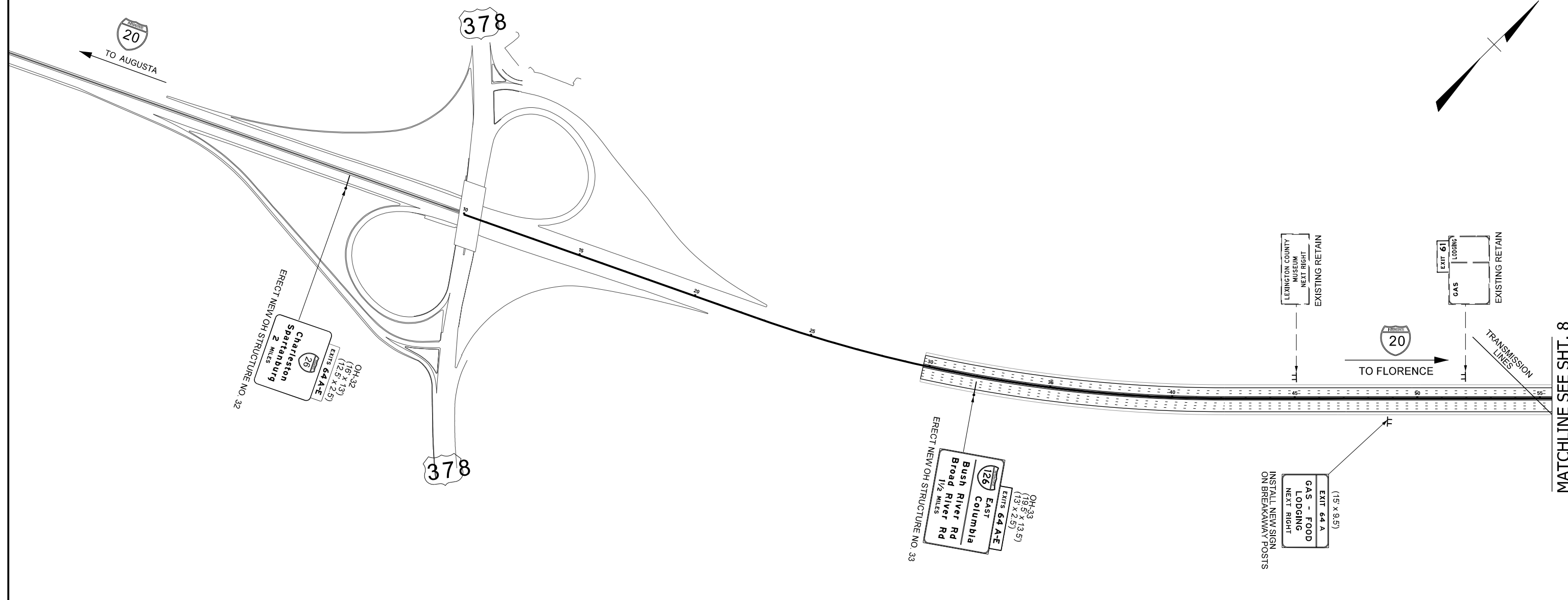
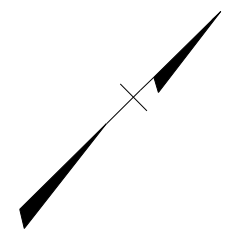

ERECT NEW OH STRUCTURE NO. 32

Charleston Spartanburg
 26 MILES

OH-32
 (16' x 13')
 EXITS 64 A-E
 (12.5' x 2.5')

ERECT NEW OH STRUCTURE NO. 33

126 EAST
 Bush River Rd
 Broad River Rd
 1 1/2 MILES

OH-33
 (16'5" x 13'5")
 EXITS 64 A-E
 (13' x 2.5')

INSTALL NEW SIGN ON BREAKAWAY POSTS

EXIT 64 A
 GAS - FOOD
 LODGING
 NEXT RIGHT

(15' x 9.5')

EXISTING RETAIN

LEXINGTON COUNTY MUSEUM
 MUSEUM
 NEXT RIGHT

EXISTING RETAIN

EXIT 61
 LODGING
 GAS

MATCHLINE SEE SHT. 8

- LEGEND
- WALL IN FILL
 - WALL IN CUT
 - MEDIAN BARRIER

CAROLINA CROSSROADS CONCEPTUAL SIGNING ALONG PHASE 3

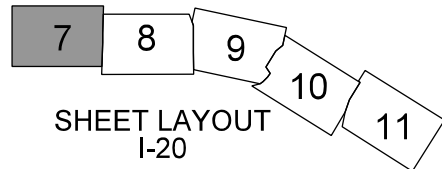
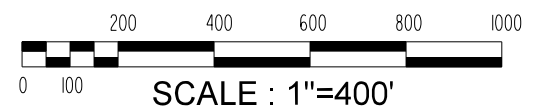

NOTE:
WHEN NEW OVERHEAD SIGNS ARE REPLACING EXISTING OVERHEAD SIGNS, MODIFY EXISTING OVERHEAD STRUCTURE TO ACCOMMODATE NEW SIGNS AND LOCATION OF HANGERS.

PROVIDE GLARE SCREENS ON NEW OVERHEAD STRUCTURES AND EXISTING STRUCTURES WHEN INSTALLING NEW OH SIGNS.

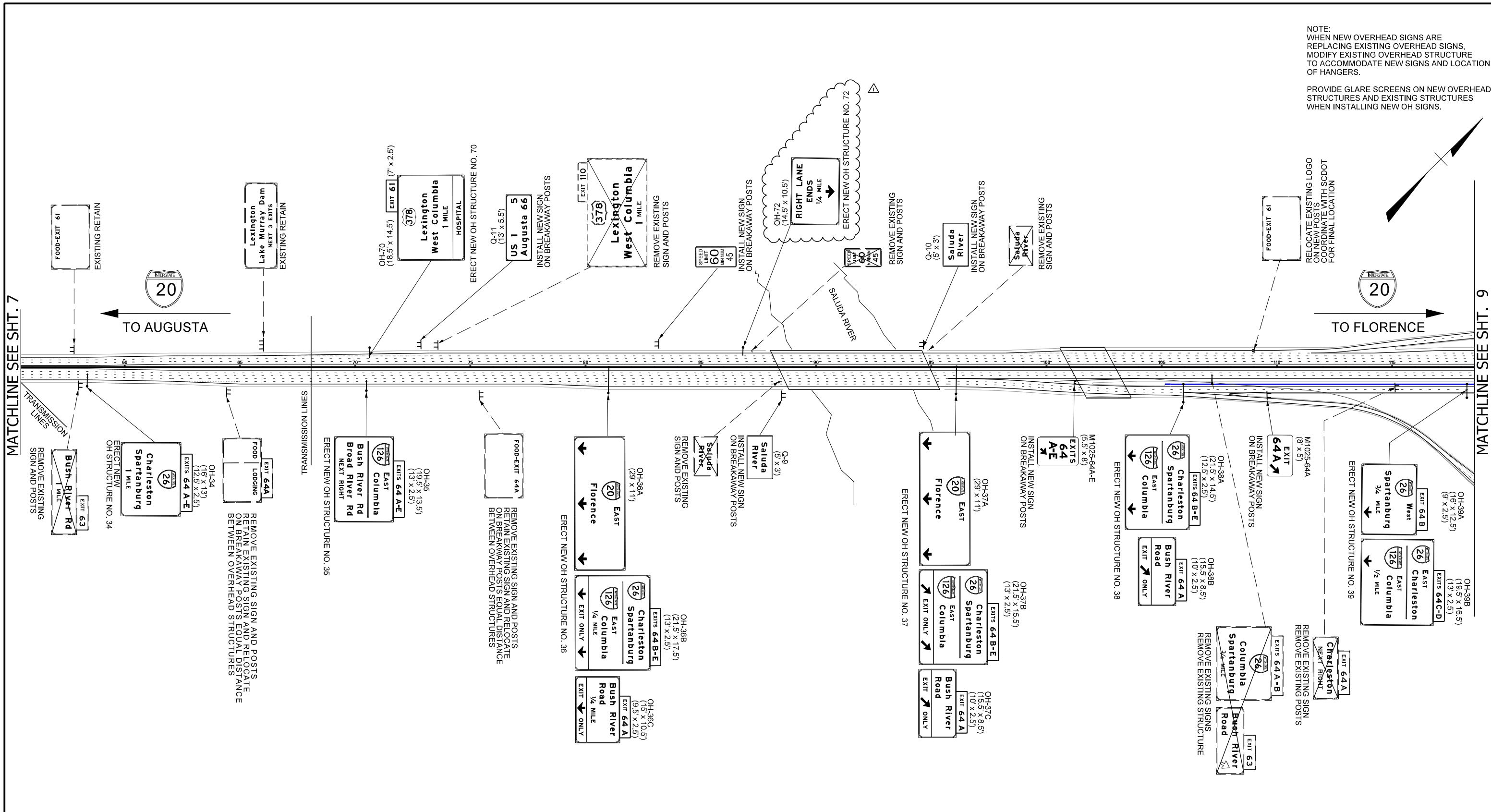

MATCHLINE SEE SHT. 7

MATCHLINE SEE SHT. 9

CAROLINA CROSSROADS CONCEPTUAL SIGNING ALONG PHASE 3

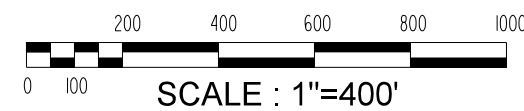

- LEGEND
- WALL IN FILL
 - WALL IN CUT
 - MEDIAN BARRIER

REV. NO.	BY	DATE	DESCRIPTION OF REVISION
1	DOT	01-10-23	ADDED OH STRUCTURES FOR LINE ENDS

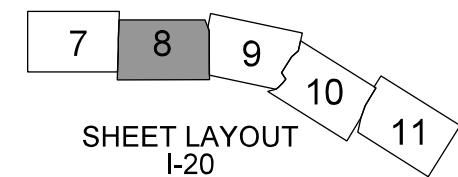

CAROLINA CROSSROADS CONCEPTUAL SIGNING ALONG PHASE 3



- LEGEND**
- WALL IN FILL
 - WALL IN CUT
 - MEDIAN BARRIER

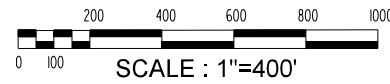

NOTE:
WHEN NEW OVERHEAD SIGNS ARE
REPLACING EXISTING OVERHEAD SIGNS,
MODIFY EXISTING OVERHEAD STRUCTURE
TO ACCOMMODATE NEW SIGNS AND LOCATION
OF HANGERS.

PROVIDE GLARE SCREENS ON NEW OVERHEAD
STRUCTURES AND EXISTING STRUCTURES
WHEN INSTALLING NEW OH SIGNS.

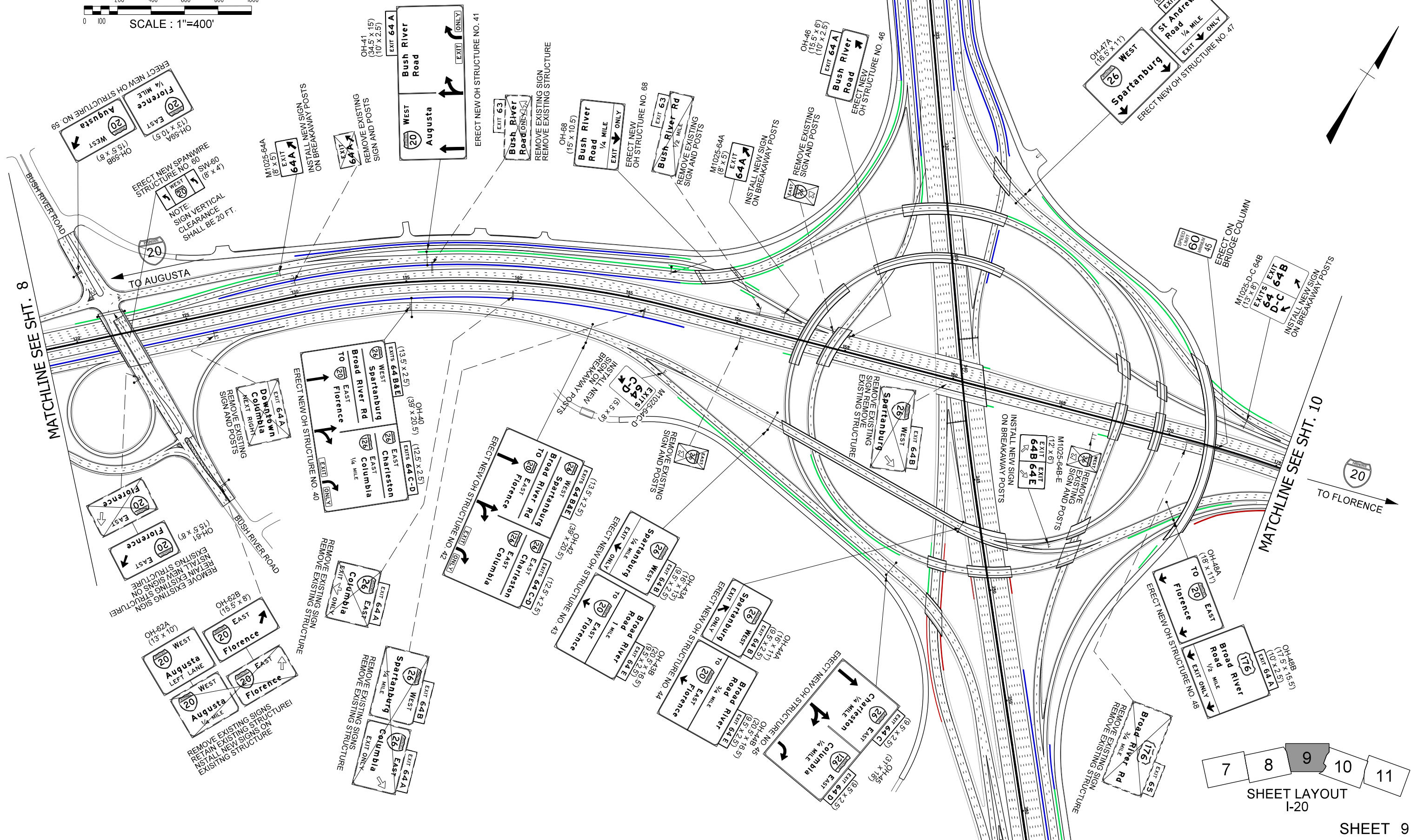
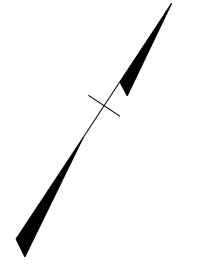

SHEET LAYOUT
I-20

MATCHLINE SEE SHT. 9

MATCHLINE SEE SHT. 11

NOTE:
WHEN NEW OVERHEAD SIGNS ARE REPLACING EXISTING OVERHEAD SIGNS, MODIFY EXISTING OVERHEAD STRUCTURE TO ACCOMMODATE NEW SIGNS AND LOCATION OF HANGERS.

PROVIDE GLARE SCREENS ON NEW OVERHEAD STRUCTURES AND EXISTING STRUCTURES WHEN INSTALLING NEW OH SIGNS.

CAROLINA CROSSROADS CONCEPTUAL SIGNING ALONG PHASE 3

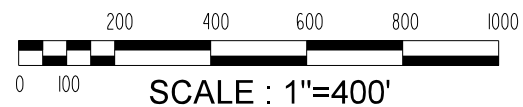

LEGEND

- WALL IN FILL
- WALL IN CUT
- MEDIAN BARRIER

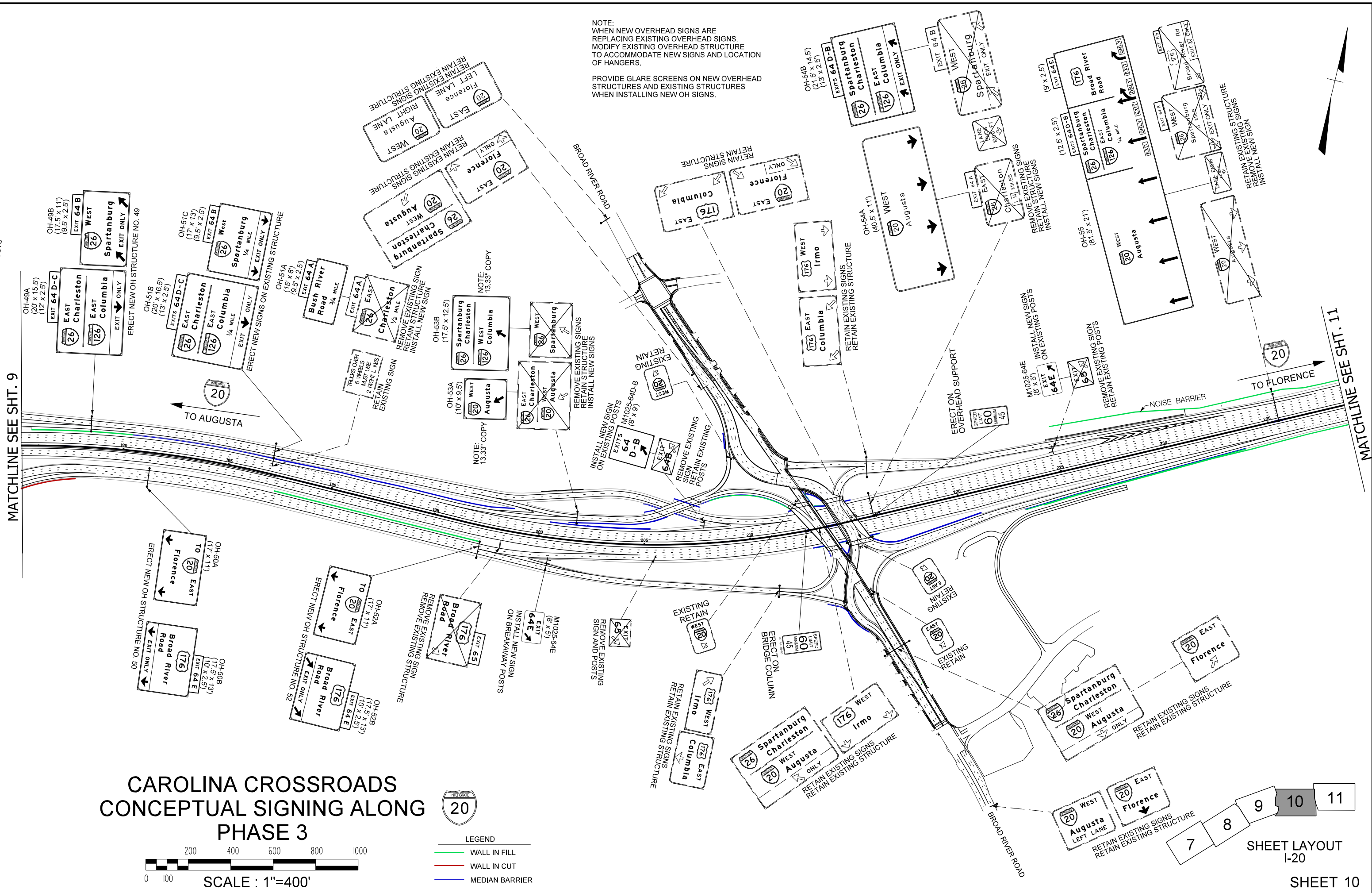

SHEET LAYOUT I-20

SHEET 10

7 8 9 10 11

NOTE:
 WHEN NEW OVERHEAD SIGNS ARE REPLACING EXISTING OVERHEAD SIGNS, MODIFY EXISTING OVERHEAD STRUCTURE TO ACCOMMODATE NEW SIGNS AND LOCATION OF HANGERS.
 PROVIDE GLARE SCREENS ON NEW OVERHEAD STRUCTURES AND EXISTING STRUCTURES WHEN INSTALLING NEW OH SIGNS.



- LEGEND
- WALL IN FILL
 - WALL IN CUT
 - MEDIAN BARRIER

CAROLINA CROSSROADS CONCEPTUAL SIGNING ALONG PHASE 3

