

PLAN

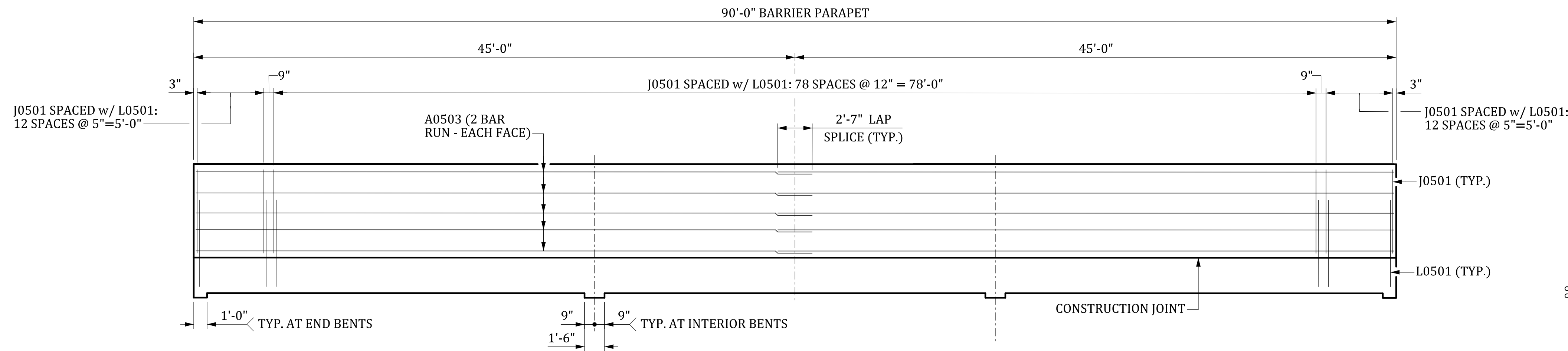

ELEVATION

REINFORCING STEEL SCHEDULE							
MARK	NO.	DIMENSION					LENGTH
		"a"	"b"	"c"	"d"	"e"	
A0401	8	19'-2"					19'-2"
A0501	184	35'-11"					35'-11"
A0502	78	9'-9"					9'-9"
A0503	40	46'-2"					46'-2"
A0601	36	21'-0"					21'-0"
A0801	39	60'-0"					60'-0"
A0802	39	32'-11"					32'-11"
A0901	78	40'-0"					40'-0"
A0902	72	18'-0"					18'-0"
A0903	72	25'-4"					25'-4"
B0501	80	5'-0"	7"				5'-7"
B0601	24	7'-0"	8"				7'-8"
J0501	210	5 1/2"	3'-3"				7'-0"
K0401	40	4 1/2"	1'-2"	1'-2"			4'-3"
KB0401	40	4 1/2"	1'-2"	8"			3'-9"
L0501	210	10"	3'-3"	6 1/4"	3'-3"		7'-11"
SB		2" HT.	AS NECESSARY				
CHCU		8" HT.	AS NECESSARY				
ESTIMATED QUANTITIES							
ITEM	UNIT	90' SPAN					
2.0" SCH. 80 PVC CONDUIT	LF	360.0					
CONCRETE, CLASS 4000	CY	163.2					
REINFORCING STEEL	LB	45,965					
MASH CONCRETE BARRIER PARAPET	LF	180.0					
ELASTOMERIC BEARING ASSEMBLY (FLAT SLAB)	EA	4					

- NOTES:
- CAST THE 90' CONTINUOUS UNIT IN ONE POUR FROM ONE END OF SPAN TO THE OTHER USING A SUITABLE SCREED. USE AN APPROVED RETARDING AGENT AND ESTABLISH AND MAINTAIN A MINIMUM POURING RATE OF 45 CY PER HOUR UNLESS APPROVED OTHERWISE BY THE RCE.
  - DO NOT REMOVE SLAB FALSEWORK UNTIL THE ENTIRE 90' SPAN UNIT HAS BEEN POURED AND CURED ACCORDING TO SECTION 702 OF THE STANDARD SPECIFICATIONS.
  - CAST BARRIER PARAPET CONCRETE AFTER SLAB FALSEWORK HAS BEEN STRUCK.
  - FOR ARMOR PLATE DETAIL, SEE "GENERAL DETAILS" SHEET.
  - FOR TYPICAL SECTION, SECTION THRU BARRIER PARAPET, SLAB BUILD-DOWN DETAILS AND DRAIN DETAILS, SEE "90' FLAT SLAB UNIT (3 SPAN) SUPERSTRUCTURE DETAILS" SHEET.
  - FOR SLAB DRAIN LOCATIONS, SEE "BRIDGE PLAN AND PROFILE" SHEET.
  - FOR REINFORCING BENDING DETAILS, SEE "REINFORCING BENDING DETAILS" SHEETS.
  - ⊘ MASH BARRIER PARAPET
  - ⊘ ALTERNATE SPLICE LOCATIONS ON ALTERNATE BARS AT BENTS 2 AND 3.

CONSULTANT NAME/LOGO

SOUTH CAROLINA  
 DEPARTMENT OF TRANSPORTATION

**90' FLAT SLAB UNIT (3 SPAN)  
 SUPERSTRUCTURE  
 (34'-0" ROADWAY)**

COUNTY: ##### ROUTE: #####

THIS DRAWING IS FURNISHED FOR INFORMATION ONLY. ALL DIMENSIONS SHOWN ARE SHEET SPECIFIC. ANY USE OF THIS DESIGN AND DRAWING, INCLUDING DIMENSIONS, MUST BE CHECKED BY THE USER'S ENGINEER TO ENSURE DESIGN IS ADEQUATE FOR THE INTENDED USE. ALL DRAWINGS MUST BE SIGNED AND SEALED BY A SOUTH CAROLINA REGISTERED PROFESSIONAL ENGINEER WHEN USED.

REV.	BY	CHK.	DATE	DESCRIPTION OF REVISION

REVIEWED	CTM	GCM	12-23
QUAN.	CTM	MWB	12-23
DR.	SJA	DPP	10-23
DES.	BY	CHK.	DATE

M:\Breceland\6/26/2024 4:29:18 PM 702\_FS\_090.dgn

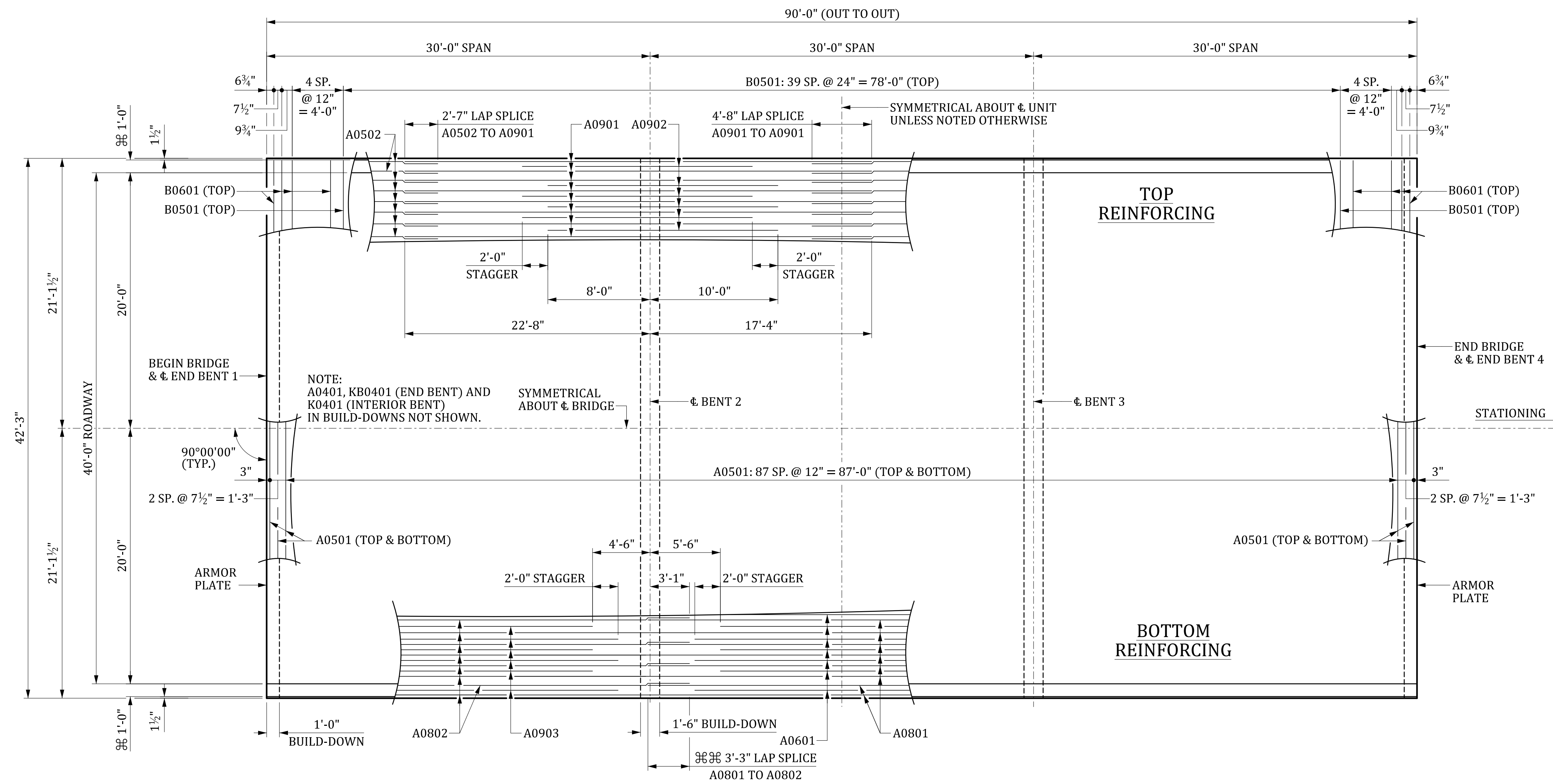

PLAN

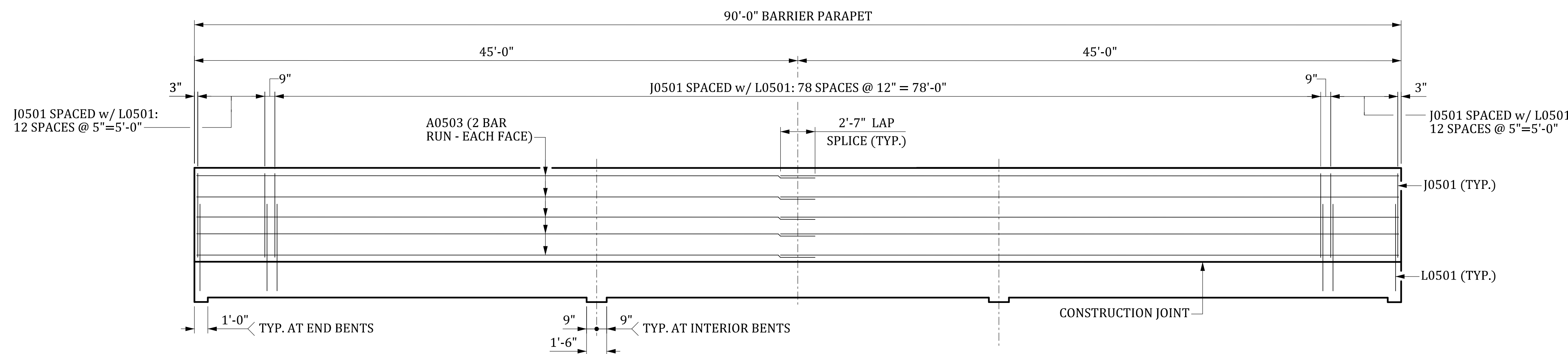

ELEVATION

REINFORCING STEEL SCHEDULE							
MARK	NO.	DIMENSION					LENGTH
		"a"	"b"	"c"	"d"	"e"	
A0401	8	25'-2"					25'-2"
A0501	184	41'-11"					41'-11"
A0502	90	9'-9"					9'-9"
A0503	40	46'-2"					46'-2"
A0601	42	21'-0"					21'-0"
A0801	45	60'-0"					60'-0"
A0802	45	32'-11"					32'-11"
A0901	90	40'-0"					40'-0"
A0902	84	18'-0"					18'-0"
A0903	84	25'-4"					25'-4"
B0501	80	5'-0"	7"				5'-7"
B0601	24	7'-0"	8"				7'-8"
J0501	210	5 1/2"	3'-3"				7'-0"
K0401	52	4 1/2"	1'-2"	1'-2"			4'-3"
KB0401	52	4 1/2"	1'-2"	8"			3'-9"
L0501	210	10"	3'-3"	6 1/4"	3'-3"		7'-11"
SB		2" HT.	AS NECESSARY				
CHCU		8" HT.	AS NECESSARY				

ESTIMATED QUANTITIES		
ITEM	UNIT	90' SPAN
2.0" SCH. 80 PVC CONDUIT	LF	360.0
CONCRETE, CLASS 4000	CY	190.4
REINFORCING STEEL	LB	52,411
MASH CONCRETE BARRIER PARAPET	LF	180.0
ELASTOMERIC BEARING ASSEMBLY (FLAT SLAB)	EA	4

NOTES:

CAST THE 90' CONTINUOUS UNIT IN ONE POUR FROM ONE END OF SPAN TO THE OTHER USING A SUITABLE SCREED. USE AN APPROVED RETARDING AGENT AND ESTABLISH AND MAINTAIN A MINIMUM POURING RATE OF 45 CY PER HOUR UNLESS APPROVED OTHERWISE BY THE RCE.

DO NOT REMOVE SLAB FALSEWORK UNTIL THE ENTIRE 90' SPAN UNIT HAS BEEN POURED AND CURED ACCORDING TO SECTION 702 OF THE STANDARD SPECIFICATIONS.

CAST BARRIER PARAPET CONCRETE AFTER SLAB FALSEWORK HAS BEEN STRUCK.

FOR ARMOR PLATE DETAIL, SEE "GENERAL DETAILS" SHEET.

FOR TYPICAL SECTION, SECTION THRU BARRIER PARAPET, SLAB BUILD-DOWN DETAILS AND DRAIN DETAILS, SEE "90' FLAT SLAB UNIT (3 SPAN) SUPERSTRUCTURE DETAILS" SHEET.

FOR SLAB DRAIN LOCATIONS, SEE "BRIDGE PLAN AND PROFILE" SHEET.

FOR REINFORCING BENDING DETAILS, SEE "REINFORCING BENDING DETAILS" SHEETS.

⊗ MASH BARRIER PARAPET

⊗ ALTERNATE SPLICE LOCATIONS ON ALTERNATE BARS AT BENTS 2 AND 3.

CONSULTANT NAME/LOGO

SOUTH CAROLINA DEPARTMENT OF TRANSPORTATION

**90' FLAT SLAB UNIT (3 SPAN) SUPERSTRUCTURE (40'-0" ROADWAY)**

COUNTY: ##### ROUTE: #####

THIS DRAWING IS FURNISHED FOR INFORMATION ONLY. ALL DIMENSIONS SHOWN ARE SHEET SPECIFIC. ANY USE OF THIS DESIGN AND DRAWING, INCLUDING DIMENSIONS, MUST BE CHECKED BY THE USER'S ENGINEER TO ENSURE DESIGN IS ADEQUATE FOR THE INTENDED USE. ALL DRAWINGS MUST BE SIGNED AND SEALED BY A SOUTH CAROLINA REGISTERED PROFESSIONAL ENGINEER WHEN USED.

REV.	BY	CHK.	DATE	DESCRIPTION OF REVISION

  

REVIEWED	CTM	GCM	12-23
QUAN.	CTM	MWB	12-23
DR.	SJA	DPP	10-23
DES.	BY	CHK.	DATE

M:\Breedland\6/26/2024 4:29:19 PM 702\_FS\_090.dgn

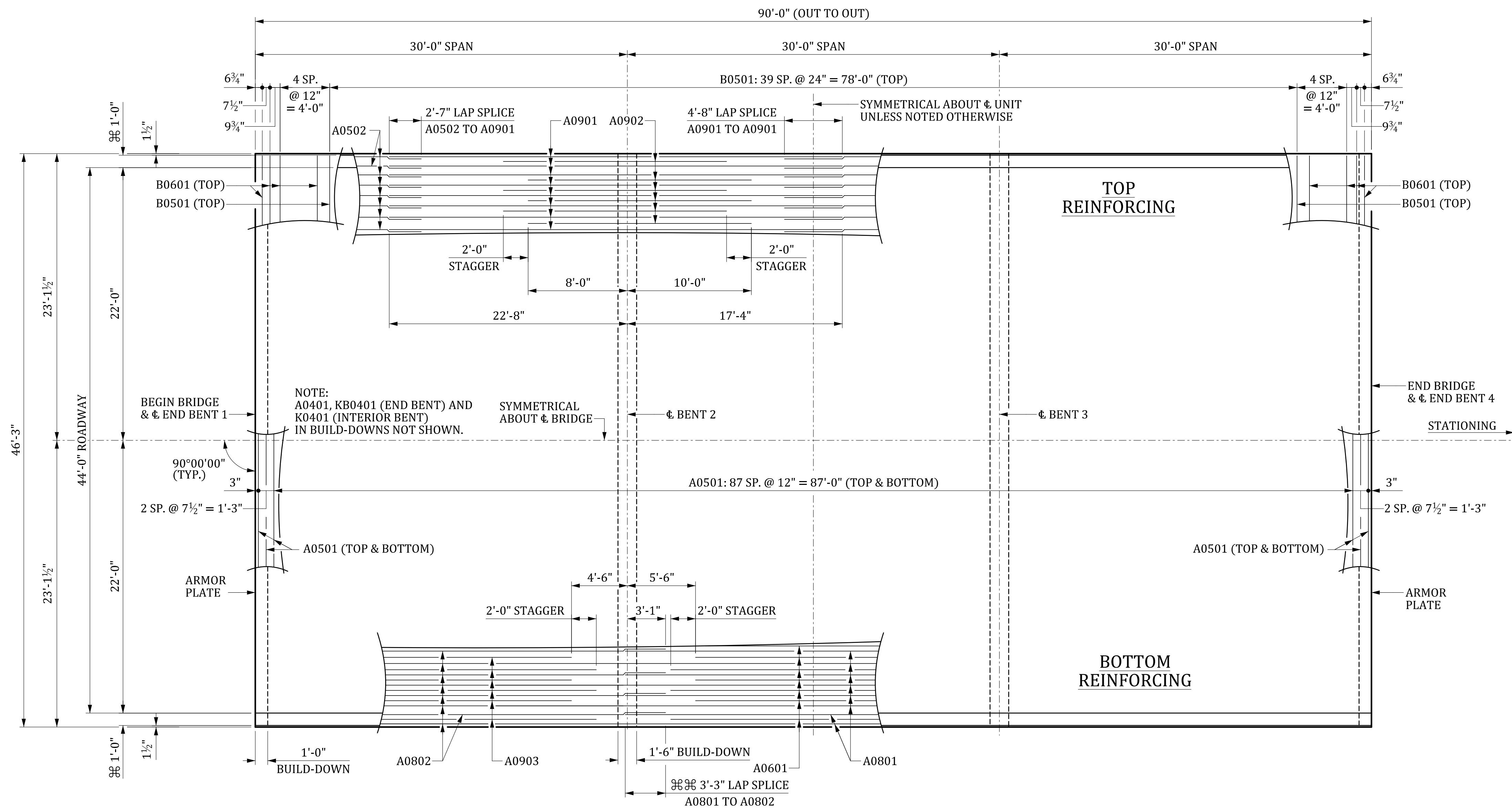

PLAN

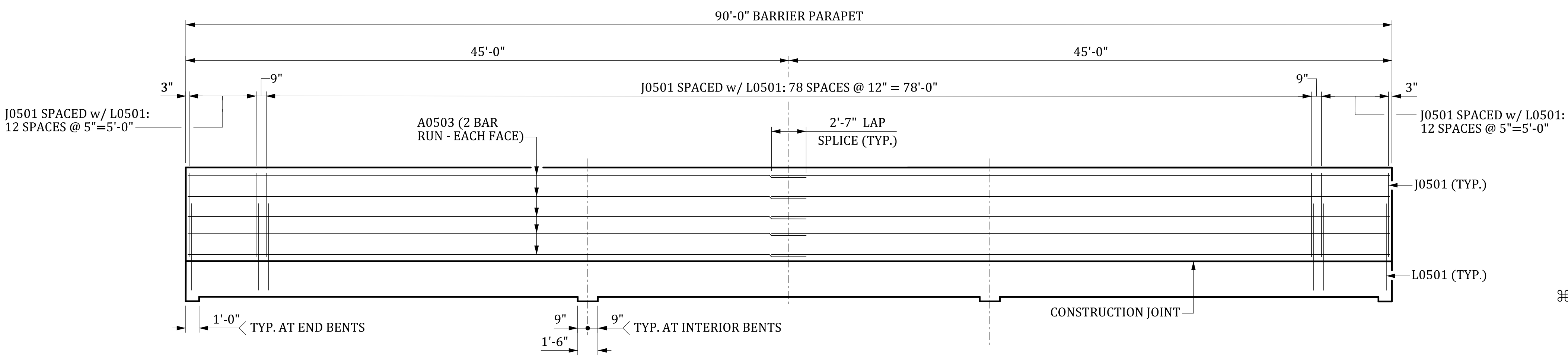

ELEVATION

REINFORCING STEEL SCHEDULE							
MARK	NO. REQ'D	DIMENSION					LENGTH
		"a"	"b"	"c"	"d"	"e"	
A0401	8	29'-2"					29'-2"
A0501	184	45'-11"					45'-11"
A0502	98	9'-9"					9'-9"
A0503	40	46'-2"					46'-2"
A0601	46	21'-0"					21'-0"
A0801	49	60'-0"					60'-0"
A0802	49	32'-11"					32'-11"
A0901	98	40'-0"					40'-0"
A0902	92	18'-0"					18'-0"
A0903	92	25'-4"					25'-4"
B0501	80	5'-0"	7"				5'-7"
B0601	24	7'-0"	8"				7'-8"
J0501	210	5 1/2"	3'-3"				7'-0"
K0401	60	4 1/2"	1'-2"	1'-2"			4'-3"
KB0401	60	4 1/2"	1'-2"	8"			3'-9"
L0501	210	10"	3'-3"	6 1/4"	3'-3"		7'-11"
SB		2" HT.	AS NECESSARY				
CHCU		8" HT.	AS NECESSARY				
ESTIMATED QUANTITIES							
ITEM	UNIT	90' SPAN					
2.0" SCH. 80 PVC CONDUIT	LF	360.0					
CONCRETE, CLASS 4000	CY	208.6					
REINFORCING STEEL	LB	56,709					
MASH CONCRETE BARRIER PARAPET	LF	180.0					
ELASTOMERIC BEARING ASSEMBLY (FLAT SLAB)	EA	4					

NOTES:

CAST THE 90' CONTINUOUS UNIT IN ONE POUR FROM ONE END OF SPAN TO THE OTHER USING A SUITABLE SCREED. USE AN APPROVED RETARDING AGENT AND ESTABLISH AND MAINTAIN A MINIMUM POURING RATE OF 45 CY PER HOUR UNLESS APPROVED OTHERWISE BY THE RCE.

DO NOT REMOVE SLAB FALSEWORK UNTIL THE ENTIRE 90' SPAN UNIT HAS BEEN POURED AND CURED ACCORDING TO SECTION 702 OF THE STANDARD SPECIFICATIONS.

CAST BARRIER PARAPET CONCRETE AFTER SLAB FALSEWORK HAS BEEN STRUCK.

FOR ARMOR PLATE DETAIL, SEE "GENERAL DETAILS" SHEET.

FOR TYPICAL SECTION, SECTION THRU BARRIER PARAPET, SLAB BUILD-DOWN DETAILS AND DRAIN DETAILS, SEE "90' FLAT SLAB UNIT (3 SPAN) SUPERSTRUCTURE DETAILS" SHEET.

FOR SLAB DRAIN LOCATIONS, SEE "BRIDGE PLAN AND PROFILE" SHEET.

FOR REINFORCING BENDING DETAILS, SEE "REINFORCING BENDING DETAILS" SHEETS.

$\text{M}$  MASH BARRIER PARAPET

$\text{A}$  ALTERNATE SPLICE LOCATIONS ON ALTERNATE BARS AT BENTS 2 AND 3.

CONSULTANT NAME/LOGO

SOUTH CAROLINA DEPARTMENT OF TRANSPORTATION

**90' FLAT SLAB UNIT (3 SPAN) SUPERSTRUCTURE (44'-0" ROADWAY)**

COUNTY: ###-### ROUTE: ###-###

THIS DRAWING IS FURNISHED FOR INFORMATION ONLY. ALL DIMENSIONS SHOWN ARE SHEET SPECIFIC. ANY USE OF THIS DESIGN AND DRAWING, INCLUDING DIMENSIONS, MUST BE CHECKED BY THE USER'S ENGINEER TO ENSURE DESIGN IS ADEQUATE FOR THE INTENDED USE. ALL DRAWINGS MUST BE SIGNED AND SEALED BY A SOUTH CAROLINA REGISTERED PROFESSIONAL ENGINEER WHEN USED.

REV.	BY	CHK.	DATE	DESCRIPTION OF REVISION

REVIEWED	CTM	GCM	12-23
QUAN.	CTM	MWB	12-23
DR.	SJA	DPP	10-23
DES.	BY	CHK.	DATE

MBreeland 6/26/2024 4:29:21 PM 702\_FS\_090.dgn