

REINFORCING STEEL SCHEDULE						
MARK	NO. REQ'D	DIMENSION				LENGTH
		"a"	"b"	"c"	"d"	
A0401	6	19'-2"				19'-2"
A0501	124	35'-11"				35'-11"
A0502	78	12'-5"				12'-5"
A0503	20	59'-8"				59'-8"
A0801	39	59'-8"				59'-8"
A0901	72	24'-10"				24'-10"
A0902	39	40'-0"				40'-0"
A1001	36	19'-0"				19'-0"
B0501	50	5'-0"	7"			5'-7"
B0601	24	7'-0"	8"			7'-8"
J0501	150	5½"	3'-3"			7'-0"
K0401	20	4½"	1'-2"	1'-2"		4'-3"
KB0401	40	4½"	1'-2"	8"		3'-9"
L0501	150	10"	3'-3"	6½"	3'-3"	7'-11"
SB		2" HT.				AS NECESSARY
CHCU		8" HT.				AS NECESSARY
ESTIMATED QUANTITIES						
ITEM	UNIT	60' SPAN				
2.0" SCH. 80 PVC CONDUIT	LF	240.0				
CONCRETE, CLASS 4000	CY	108.9				
REINFORCING STEEL	LB	30,574				
MASH CONCRETE BARRIER PARAPET	LF	120.0				
ELASTOMERIC BEARING ASSEMBLY (FLAT SLAB)	EA	3				

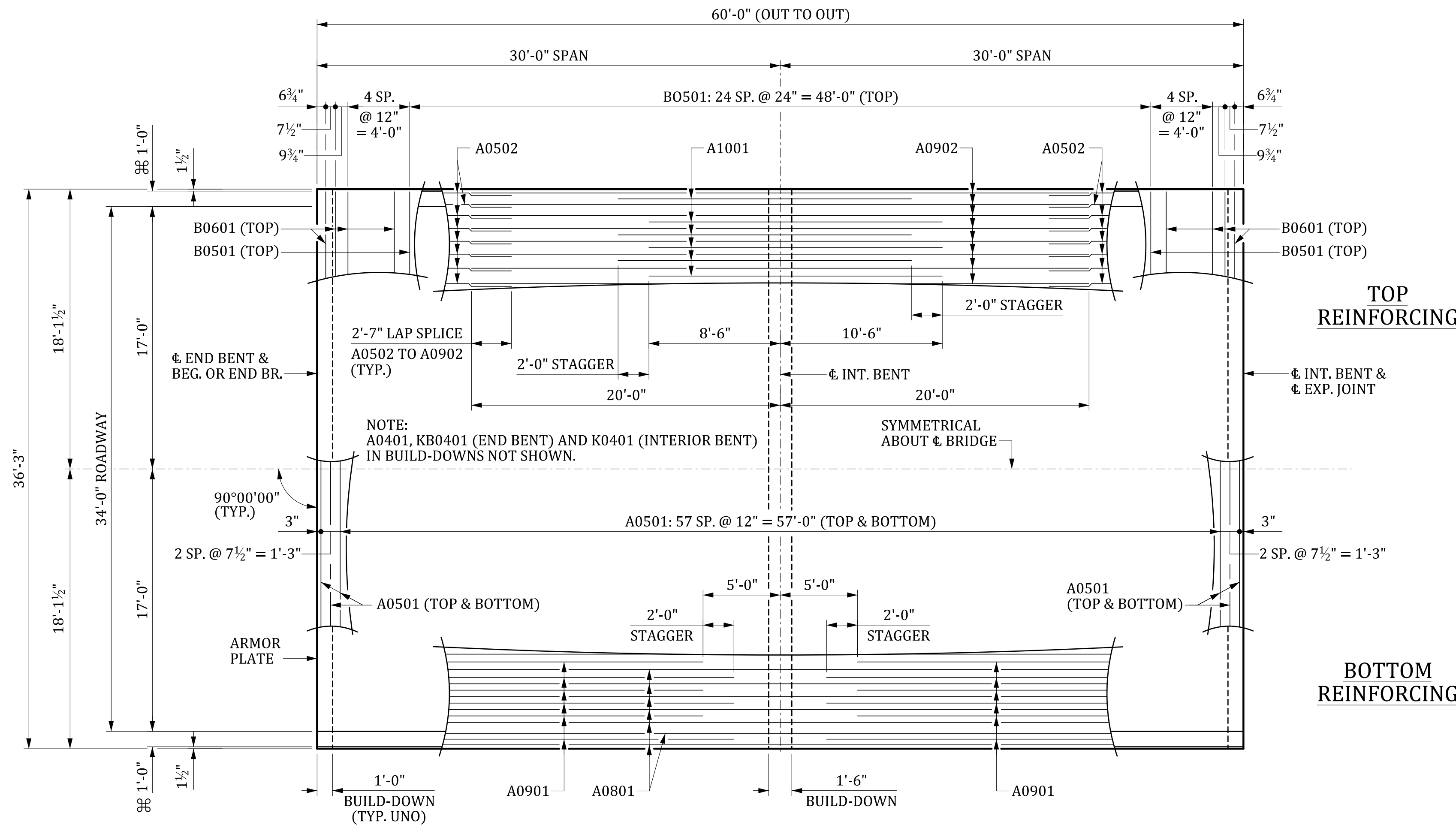

PLAN

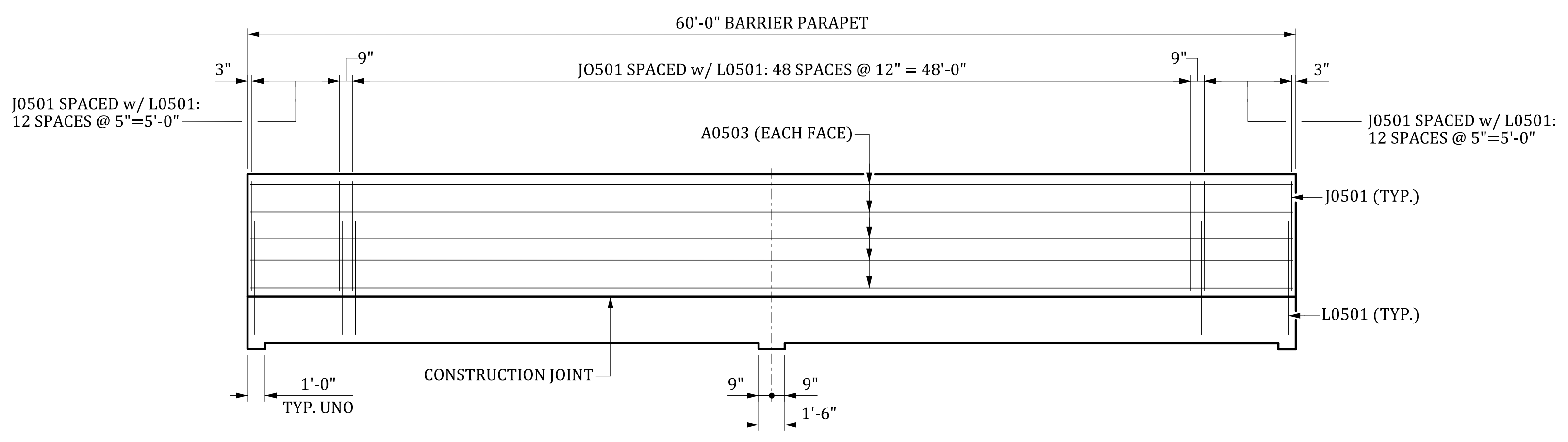

ELEVATION

NOTES:

CAST THE 60' CONTINUOUS UNIT IN ONE POUR FROM ONE END OF SPAN TO THE OTHER USING A SUITABLE SCREED. USE AN APPROVED RETARDING AGENT AND ESTABLISH AND MAINTAIN A MINIMUM POURING RATE OF 45 CY PER HOUR UNLESS APPROVED OTHERWISE BY THE RCE.

DO NOT REMOVE SLAB FALSEWORK UNTIL THE ENTIRE 60' SPAN UNIT HAS BEEN POURED AND CURED ACCORDING TO SECTION 702 OF THE STANDARD SPECIFICATIONS.

CAST BARRIER PARAPET CONCRETE AFTER SLAB FALSEWORK HAS BEEN STRUCK.

FOR ARMOR PLATE DETAIL, SEE "GENERAL DETAILS" SHEET.

FOR TYPICAL SECTION, SECTION THRU BARRIER PARAPET, SLAB BUILD-DOWN DETAILS AND DRAIN DETAILS, SEE "60' FLAT SLAB UNIT (END SPAN) SUPERSTRUCTURE DETAILS" SHEET.

FOR SLAB DRAIN LOCATIONS, SEE "BRIDGE PLAN AND PROFILE" SHEET.

FOR REINFORCING BENDING DETAILS, SEE "REINFORCING BENDING DETAILS" SHEETS.

UNO - UNLESS NOTED OTHERWISE

⊘ MASH BARRIER PARAPET

REV.	BY	CHK.	DATE	DESCRIPTION OF REVISION

REVIEWED	CTM	GCM	11-23
QUAN.	CTM	MWB	11-23
DR.	SJA	DPP	10-23
DES.	BY	CHK.	DATE

THIS DRAWING IS FURNISHED FOR INFORMATION ONLY. ALL DIMENSIONS SHOWN ARE SHEET SPECIFIC. ANY USE OF THIS DESIGN AND DRAWING, INCLUDING DIMENSIONS, MUST BE CHECKED BY THE USER'S ENGINEER TO ENSURE DESIGN IS ADEQUATE FOR THE INTENDED USE. ALL DRAWINGS MUST BE SIGNED AND SEALED BY A SOUTH CAROLINA REGISTERED PROFESSIONAL ENGINEER WHEN USED.

CONSULTANT NAME/LOGO

SOUTH CAROLINA
 DEPARTMENT OF TRANSPORTATION

**60' FLAT SLAB UNIT (END SPAN)
 SUPERSTRUCTURE**
 (34'-0" ROADWAY)

COUNTY: ##### ROUTE: #####

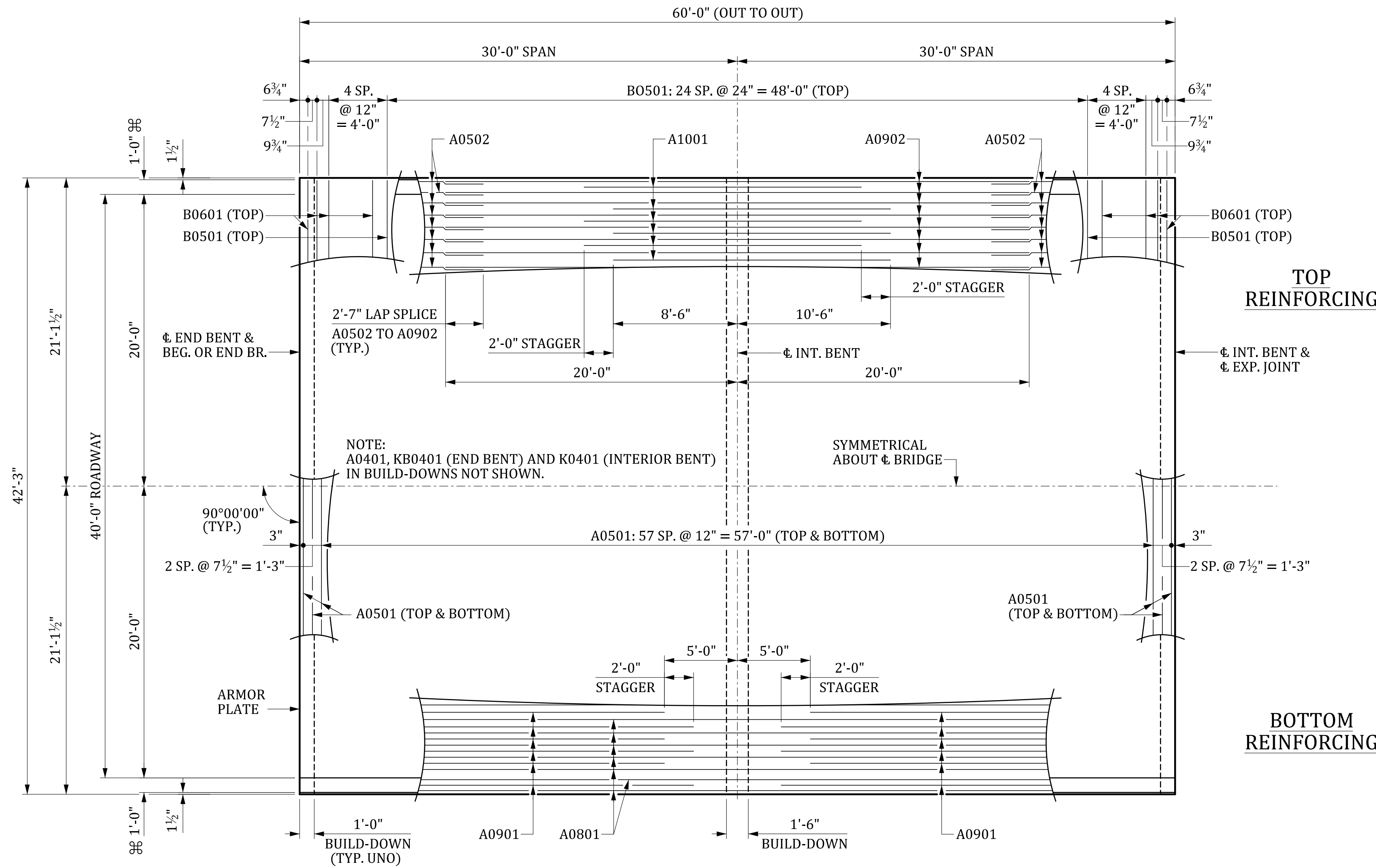

PLAN

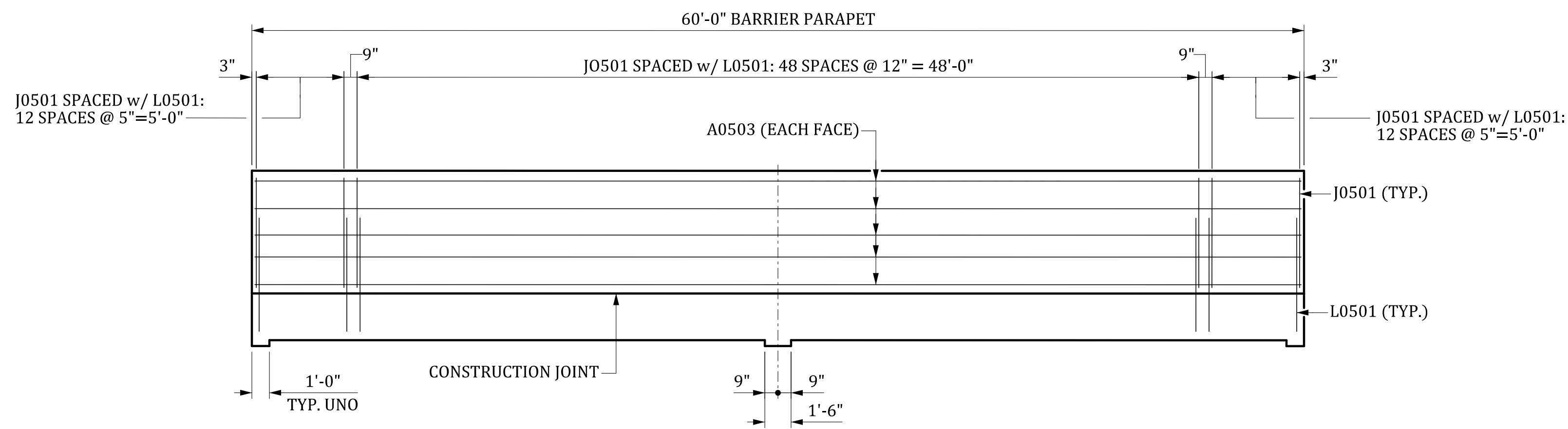

ELEVATION

REINFORCING STEEL SCHEDULE							
MARK	NO. REQ'D	DIMENSION					LENGTH
		"a"	"b"	"c"	"d"	"e"	
A0401	6	25'-2"				25'-2"	
A0501	124	41'-11"				41'-11"	
A0502	90	12'-5"				12'-5"	
A0503	20	59'-8"				59'-8"	
A0801	45	59'-8"				59'-8"	
A0901	84	24'-10"				24'-10"	
A0902	45	40'-0"				40'-0"	
A1001	42	19'-0"				19'-0"	
B0501	50	5'-0"	7"			5'-7"	
B0601	24	7'-0"	8"			7'-8"	
J0501	150	5 1/2"	3'-3"			7'-0"	
K0401	26	4 1/2"	1'-2"	1'-2"		4'-3"	
KB0401	52	4 1/2"	1'-2"	8"		3'-9"	
L0501	150	10"	3'-3"	6 1/4"	3'-3"	7'-11"	
SB		2" HT.	AS NECESSARY				
CHCU		8" HT.	AS NECESSARY				
ESTIMATED QUANTITIES							
ITEM	UNIT	60' SPAN					
2.0" SCH. 80 PVC CONDUIT	LF	240.0					
CONCRETE, CLASS 4000	CY	127.0					
REINFORCING STEEL	LB	34,853					
MASH CONCRETE BARRIER PARAPET	LF	120.0					
ELASTOMERIC BEARING ASSEMBLY (FLAT SLAB)	EA	3					

NOTES:

CAST THE 60' CONTINUOUS UNIT IN ONE POUR FROM ONE END OF SPAN TO THE OTHER USING A SUITABLE SCREED. USE AN APPROVED RETARDING AGENT AND ESTABLISH AND MAINTAIN A MINIMUM POURING RATE OF 45 CY PER HOUR UNLESS APPROVED OTHERWISE BY THE RCE.

DO NOT REMOVE SLAB FALSEWORK UNTIL THE ENTIRE 60' SPAN UNIT HAS BEEN POURED AND CURED ACCORDING TO SECTION 702 OF THE STANDARD SPECIFICATIONS.

CAST BARRIER PARAPET CONCRETE AFTER SLAB FALSEWORK HAS BEEN STRUCK.

FOR ARMOR PLATE DETAIL, SEE "GENERAL DETAILS" SHEET.

FOR TYPICAL SECTION, SECTION THRU BARRIER PARAPET, SLAB BUILD-DOWN DETAILS AND DRAIN DETAILS, SEE "60' FLAT SLAB UNIT (END SPAN) SUPERSTRUCTURE DETAILS" SHEET.

FOR SLAB DRAIN LOCATIONS, SEE "BRIDGE PLAN AND PROFILE" SHEET.

FOR REINFORCING BENDING DETAILS, SEE "REINFORCING BENDING DETAILS" SHEETS.

UNO - UNLESS NOTED OTHERWISE

⊘ MASH BARRIER PARAPET

REV.	BY	CHK.	DATE	DESCRIPTION OF REVISION

REVIEWED	CTM	GCM	11-23
QUAN.	CTM	MWB	11-23
DR.	SJA	DPP	10-23
DES.	BY	CHK.	DATE

THIS DRAWING IS FURNISHED FOR INFORMATION ONLY. ALL DIMENSIONS SHOWN ARE SHEET SPECIFIC. ANY USE OF THIS DESIGN AND DRAWING, INCLUDING DIMENSIONS, MUST BE CHECKED BY THE USER'S ENGINEER TO ENSURE DESIGN IS ADEQUATE FOR THE INTENDED USE. ALL DRAWINGS MUST BE SIGNED AND SEALED BY A SOUTH CAROLINA REGISTERED PROFESSIONAL ENGINEER WHEN USED.

CONSULTANT NAME/LOGO
SOUTH CAROLINA DEPARTMENT OF TRANSPORTATION
60' FLAT SLAB UNIT (END SPAN) SUPERSTRUCTURE (40'-0" ROADWAY)
COUNTY: #### ROUTE: ####

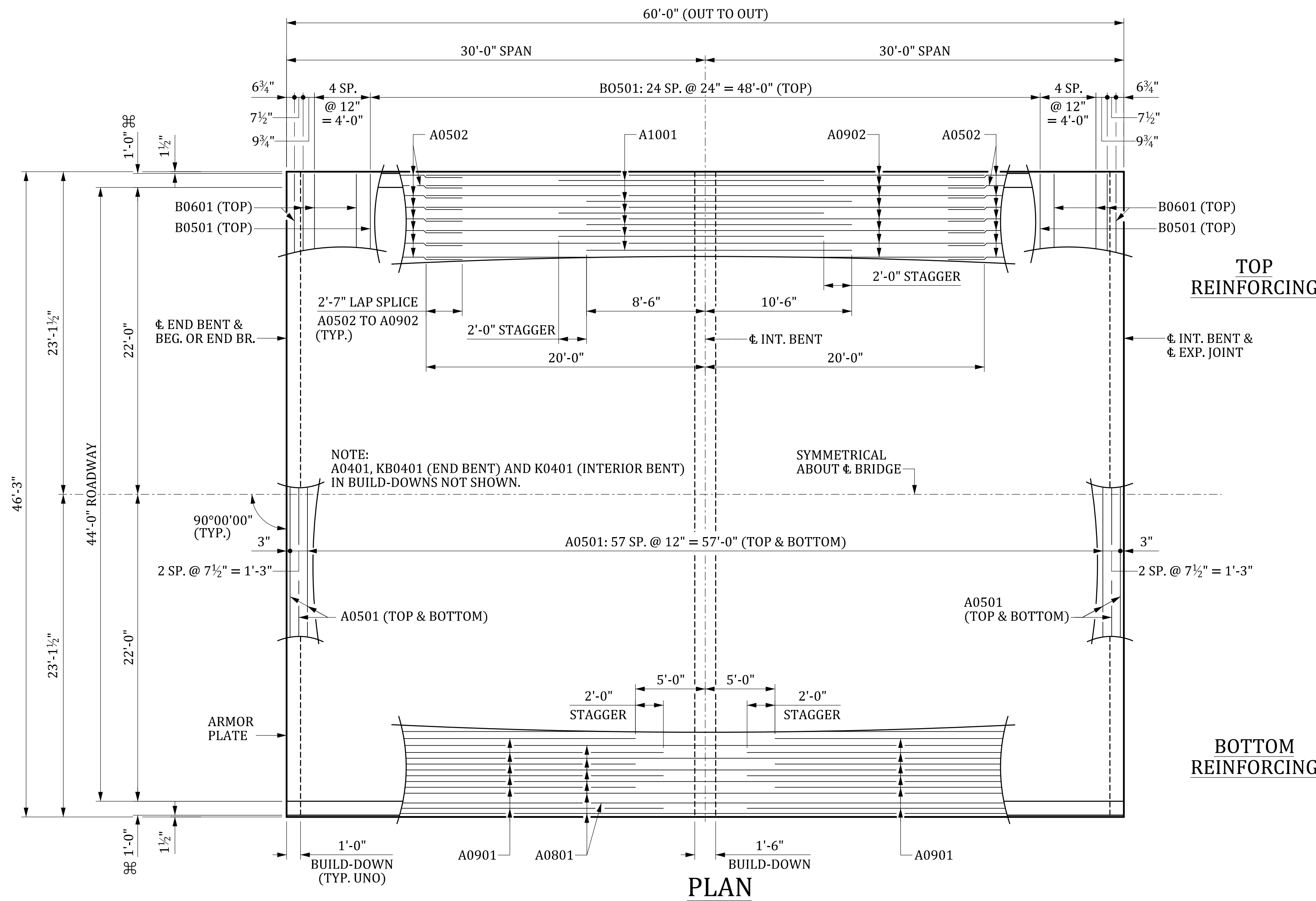

PLAN

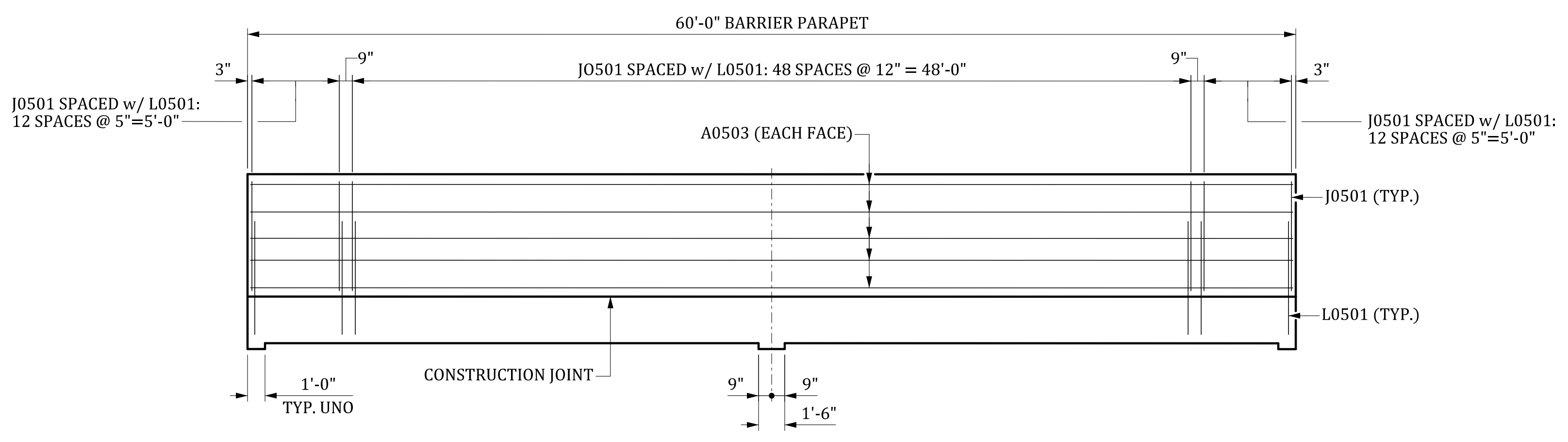

ELEVATION

REINFORCING STEEL SCHEDULE							
MARK	NO. REQ'D	DIMENSION					LENGTH
		"a"	"b"	"c"	"d"	"e"	
A0401	6	29'-2"					29'-2"
A0501	124	45'-11"					45'-11"
A0502	98	12'-5"					12'-5"
A0503	20	59'-8"					59'-8"
A0801	49	59'-8"					59'-8"
A0901	92	24'-10"					24'-10"
A0902	49	40'-0"					40'-0"
A1001	46	19'-0"					19'-0"
B0501	50	5'-0"	7"				5'-7"
B0601	24	7'-0"	8"				7'-8"
J0501	150	5½"	3'-3"				7'-0"
K0401	30	4½"	1'-2"	1'-2"			4'-3"
KB0401	60	4½"	1'-2"	8"			3'-9"
L0501	150	10"	3'-3"	6½"	3'-3"		7'-11"
SB	2" HT. AS NECESSARY						
CHCU	8" HT. AS NECESSARY						
ESTIMATED QUANTITIES							
ITEM	UNIT	60' SPAN					
2.0" SCH. 80 PVC CONDUIT	LF	240.0					
CONCRETE, CLASS 4000	CY	139.2					
REINFORCING STEEL	LB	37,704					
MASH CONCRETE BARRIER PARAPET	LF	120.0					
ELASTOMERIC BEARING ASSEMBLY (FLAT SLAB)	EA	3					

NOTES:

CAST THE 60' CONTINUOUS UNIT IN ONE POUR FROM ONE END OF SPAN TO THE OTHER USING A SUITABLE SCREED. USE AN APPROVED RETARDING AGENT AND ESTABLISH AND MAINTAIN A MINIMUM POURING RATE OF 45 CY PER HOUR UNLESS APPROVED OTHERWISE BY THE RCE.

DO NOT REMOVE SLAB FALSEWORK UNTIL THE ENTIRE 60' SPAN UNIT HAS BEEN POURED AND CURED ACCORDING TO SECTION 702 OF THE STANDARD SPECIFICATIONS.

CAST BARRIER PARAPET CONCRETE AFTER SLAB FALSEWORK HAS BEEN STRUCK.

FOR ARMOR PLATE DETAIL, SEE "GENERAL DETAILS" SHEET.

FOR TYPICAL SECTION, SECTION THRU BARRIER PARAPET, SLAB BUILD-DOWN DETAILS AND DRAIN DETAILS, SEE "60' FLAT SLAB UNIT (END SPAN) SUPERSTRUCTURE DETAILS" SHEET.

FOR SLAB DRAIN LOCATIONS, SEE "BRIDGE PLAN AND PROFILE" SHEET.

FOR REINFORCING BENDING DETAILS, SEE "REINFORCING BENDING DETAILS" SHEETS.

UNO - UNLESS NOTED OTHERWISE

⊘ MASH BARRIER PARAPET

REV.	BY	CHK.	DATE	DESCRIPTION OF REVISION

REVIEWED	CTM	GCM	11-23
QUAN.	CTM	MWB	11-23
DR.	SJA	DPP	10-23
DES.	BY	CHK.	DATE

THIS DRAWING IS FURNISHED FOR INFORMATION ONLY. ALL DIMENSIONS SHOWN ARE SHEET SPECIFIC. ANY USE OF THIS DESIGN AND DRAWING, INCLUDING DIMENSIONS, MUST BE CHECKED BY THE USER'S ENGINEER TO ENSURE DESIGN IS ADEQUATE FOR THE INTENDED USE. ALL DRAWINGS MUST BE SIGNED AND SEALED BY A SOUTH CAROLINA REGISTERED PROFESSIONAL ENGINEER WHEN USED.

CONSULTANT NAME/LOGO

SOUTH CAROLINA
 DEPARTMENT OF TRANSPORTATION

**60' FLAT SLAB UNIT (END SPAN)
 SUPERSTRUCTURE
 (44'-0" ROADWAY)**

COUNTY: ##### ROUTE: #####