

REINFORCING STEEL SCHEDULE						
MARK	NO. REQ'D	DIMENSION				LENGTH
		"a"	"b"	"c"	"d"	
A0401	4	19'-2"	---	---	---	19'-2"
A0501	64	35'-11"	---	---	---	35'-11"
A0502	59	29'-8"	---	---	---	29'-8"
A0901	75	29'-8"	---	---	---	29'-8"
B0501	44	5'-0"	7"	---	---	5'-7"
J0501	90	5½"	3'-3"	---	---	7'-0"
KB0401	40	4½"	1'-6"	8"	---	4'-5"
L0501	90	10"	3'-7"	6¼"	3'-7"	8'-7"
SB	2" HT.		AS NECESSARY			
CHCU	12½" HT.		AS NECESSARY			
ESTIMATED QUANTITIES						
ITEM	UNIT	30' SPAN				
2.0" SCH. 80 PVC CONDUIT	LF	120.0				
CONCRETE, CLASS 4000	CY	68.0				
REINFORCING STEEL	LB	13,677				
MASH CONCRETE BARRIER PARAPET	LF	60.0				
ELASTOMERIC BEARING ASSEMBLY (FLAT SLAB)	EA	2				

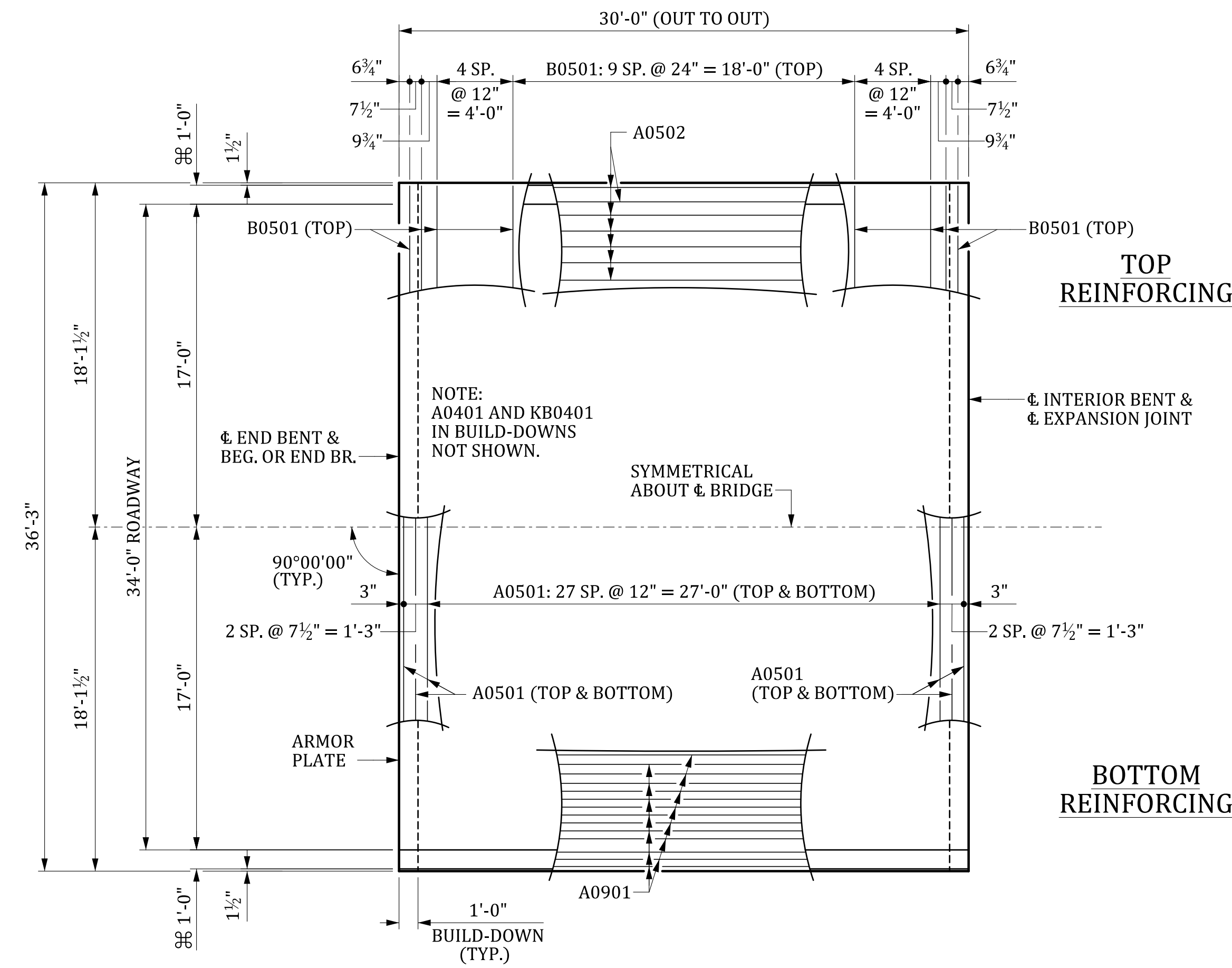

PLAN

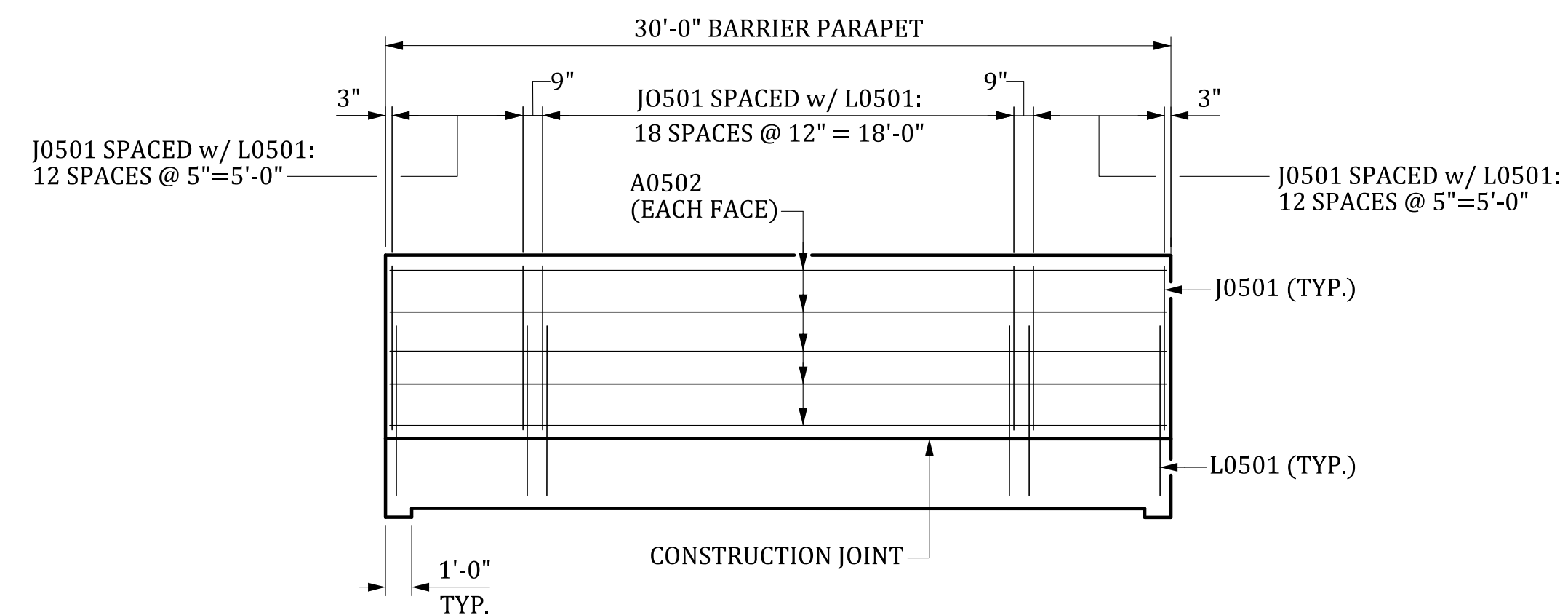

ELEVATION

NOTES:

CAST THE 30' UNIT IN ONE POUR FROM ONE END OF SPAN TO THE OTHER USING A SUITABLE SCREED. USE AN APPROVED RETARDING AGENT AND ESTABLISH AND MAINTAIN A MINIMUM POURING RATE OF 45 CY PER HOUR UNLESS APPROVED OTHERWISE BY THE RCE.

DO NOT REMOVE SLAB FALSEWORK UNTIL THE ENTIRE 30' SPAN UNIT HAS BEEN POURED AND CURED ACCORDING TO SECTION 702 OF THE STANDARD SPECIFICATIONS.

CAST BARRIER PARAPET CONCRETE AFTER SLAB FALSEWORK HAS BEEN STRUCK.

FOR ARMOR PLATE DETAIL, SEE "GENERAL DETAILS" SHEET.

FOR TYPICAL SECTION, SECTION THRU BARRIER PARAPET, SLAB BUILD-DOWN DETAILS AND DRAIN DETAILS, SEE "30' FLAT SLAB UNIT (END SPAN) SUPERSTRUCTURE DETAILS" SHEET.

FOR SLAB DRAIN LOCATIONS, SEE "BRIDGE PLAN AND PROFILE" SHEET.

FOR REINFORCING BENDING DETAILS, SEE "REINFORCING BENDING DETAILS" SHEETS.

☞ MASH BARRIER PARAPET

REV.	BY	CHK.	DATE	DESCRIPTION OF REVISION

REVIEWED	CTM	GCM	11-23
QUAN.	CTM	MWB	11-23
DR.	SJA	DPP	10-23
DES.	BY	CHK.	DATE

THIS DRAWING IS FURNISHED FOR INFORMATION ONLY. ALL DIMENSIONS SHOWN ARE SHEET SPECIFIC. ANY USE OF THIS DESIGN AND DRAWING, INCLUDING DIMENSIONS, MUST BE CHECKED BY THE USER'S ENGINEER TO ENSURE DESIGN IS ADEQUATE FOR THE INTENDED USE. ALL DRAWINGS MUST BE SIGNED AND SEALED BY A SOUTH CAROLINA REGISTERED PROFESSIONAL ENGINEER WHEN USED.

CONSULTANT NAME/LOGO	
SOUTH CAROLINA DEPARTMENT OF TRANSPORTATION	
30' FLAT SLAB UNIT (END SPAN) SUPERSTRUCTURE (34'-0" ROADWAY)	
COUNTY: ####	ROUTE: ####

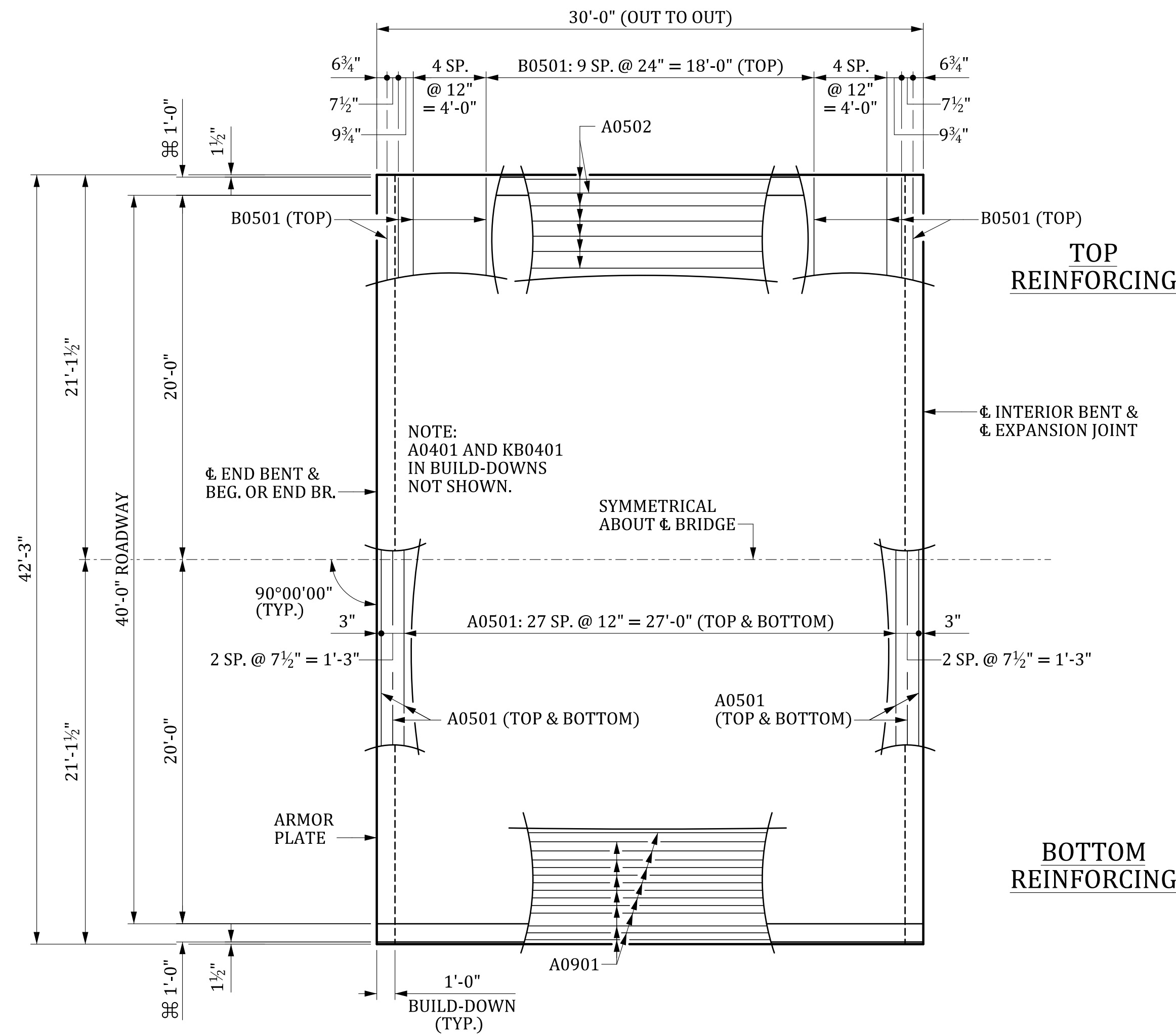

PLAN

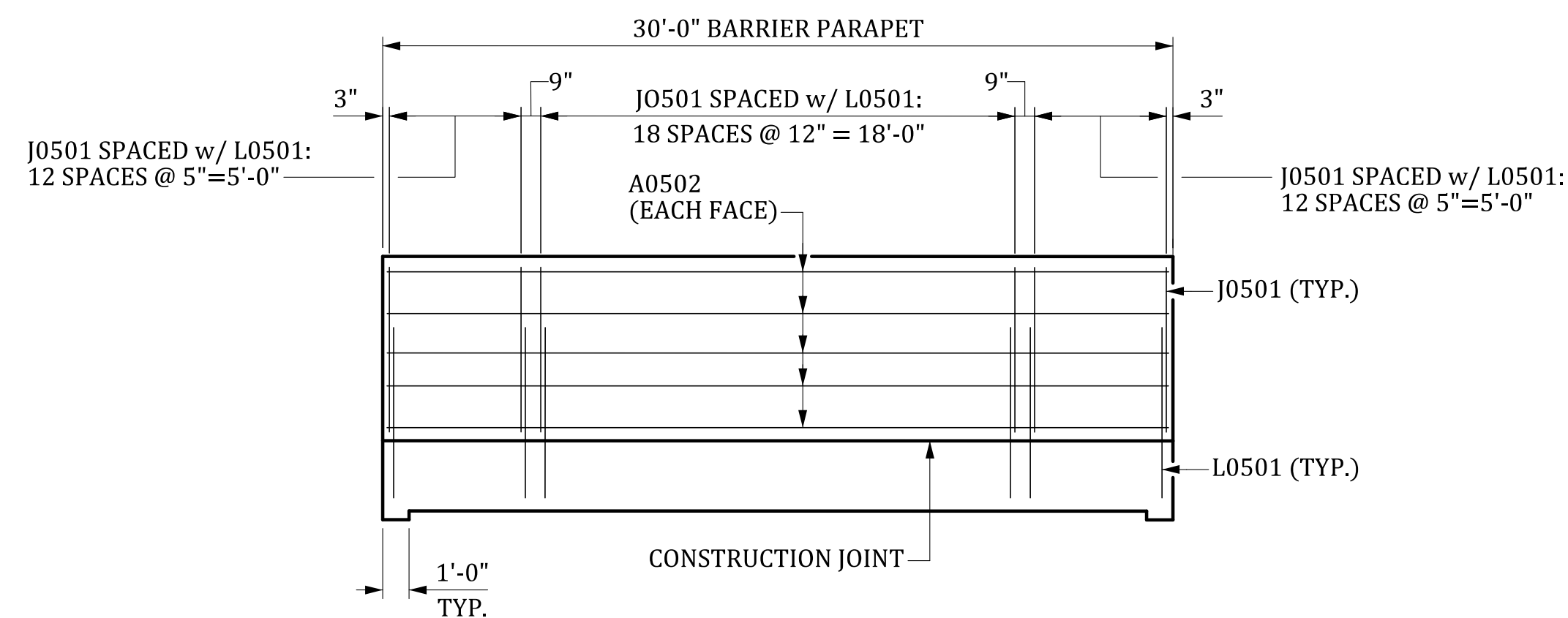

ELEVATION

REINFORCING STEEL SCHEDULE						
MARK	NO. REQ'D	DIMENSION				LENGTH
		"a"	"b"	"c"	"d"	
A0401	4	25'-2"	---	---	---	25'-2"
A0501	64	41'-11"	---	---	---	41'-11"
A0502	65	29'-8"	---	---	---	29'-8"
A0901	87	29'-8"	---	---	---	29'-8"
B0501	44	5'-0"	7"	---	---	5'-7"
J0501	90	5 1/2"	3'-3"	---	---	7'-0"
KB0401	52	4 1/2"	1'-6"	8"	---	4'-5"
L0501	90	10"	3'-7"	6 1/4"	3'-7"	8'-7"
SB	2" HT.		AS NECESSARY			
CHCU	12 1/2" HT.		AS NECESSARY			
ESTIMATED QUANTITIES						
ITEM	UNIT	30' SPAN				
2.0" SCH. 80 PVC CONDUIT	LF	120.0				
CONCRETE, CLASS 4000	CY	79.3				
REINFORCING STEEL	LB	15,523				
MASH CONCRETE BARRIER PARAPET	LF	60.0				
ELASTOMERIC BEARING ASSEMBLY (FLAT SLAB)	EA	2				

NOTES:

CAST THE 30' UNIT IN ONE POUR FROM ONE END OF SPAN TO THE OTHER USING A SUITABLE SCREED. USE AN APPROVED RETARDING AGENT AND ESTABLISH AND MAINTAIN A MINIMUM POURING RATE OF 45 CY PER HOUR UNLESS APPROVED OTHERWISE BY THE RCE.

DO NOT REMOVE SLAB FALSEWORK UNTIL THE ENTIRE 30' SPAN UNIT HAS BEEN POURED AND CURED ACCORDING TO SECTION 702 OF THE STANDARD SPECIFICATIONS.

CAST BARRIER PARAPET CONCRETE AFTER SLAB FALSEWORK HAS BEEN STRUCK.

FOR ARMOR PLATE DETAIL, SEE "GENERAL DETAILS" SHEET.

FOR TYPICAL SECTION, SECTION THRU BARRIER PARAPET, SLAB BUILD-DOWN DETAILS AND DRAIN DETAILS, SEE "30' FLAT SLAB UNIT (END SPAN) SUPERSTRUCTURE DETAILS" SHEET.

FOR SLAB DRAIN LOCATIONS, SEE "BRIDGE PLAN AND PROFILE" SHEET.

FOR REINFORCING BENDING DETAILS, SEE "REINFORCING BENDING DETAILS" SHEETS.

☞ MASH BARRIER PARAPET

REV.	BY	CHK.	DATE	DESCRIPTION OF REVISION

REVIEWED	CTM	GCM	11-23

THIS DRAWING IS FURNISHED FOR INFORMATION ONLY. ALL DIMENSIONS SHOWN ARE SHEET SPECIFIC. ANY USE OF THIS DESIGN AND DRAWING, INCLUDING DIMENSIONS, MUST BE CHECKED BY THE USER'S ENGINEER TO ENSURE DESIGN IS ADEQUATE FOR THE INTENDED USE. ALL DRAWINGS MUST BE SIGNED AND SEALED BY A SOUTH CAROLINA REGISTERED PROFESSIONAL ENGINEER WHEN USED.

CONSULTANT NAME/LOGO	
SOUTH CAROLINA DEPARTMENT OF TRANSPORTATION	
30' FLAT SLAB UNIT (END SPAN) SUPERSTRUCTURE (40'-0" ROADWAY)	
COUNTY: ####	ROUTE: ####

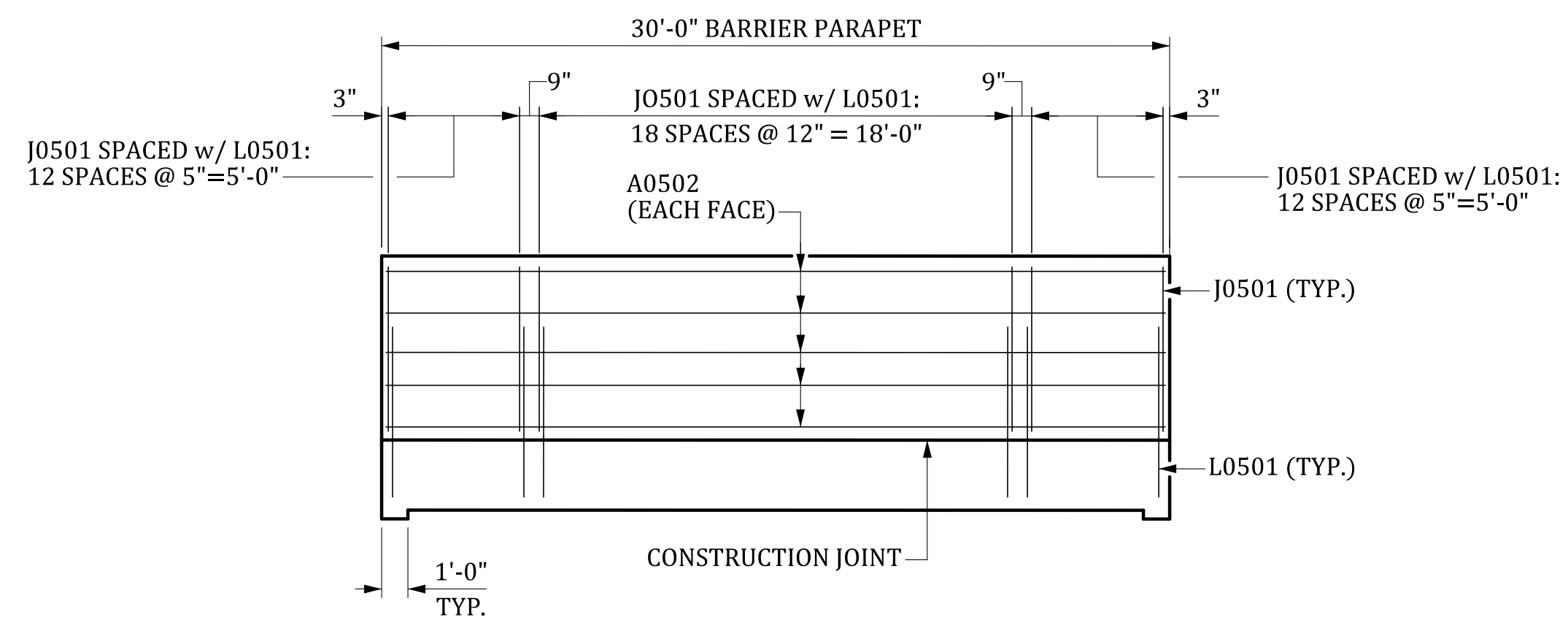
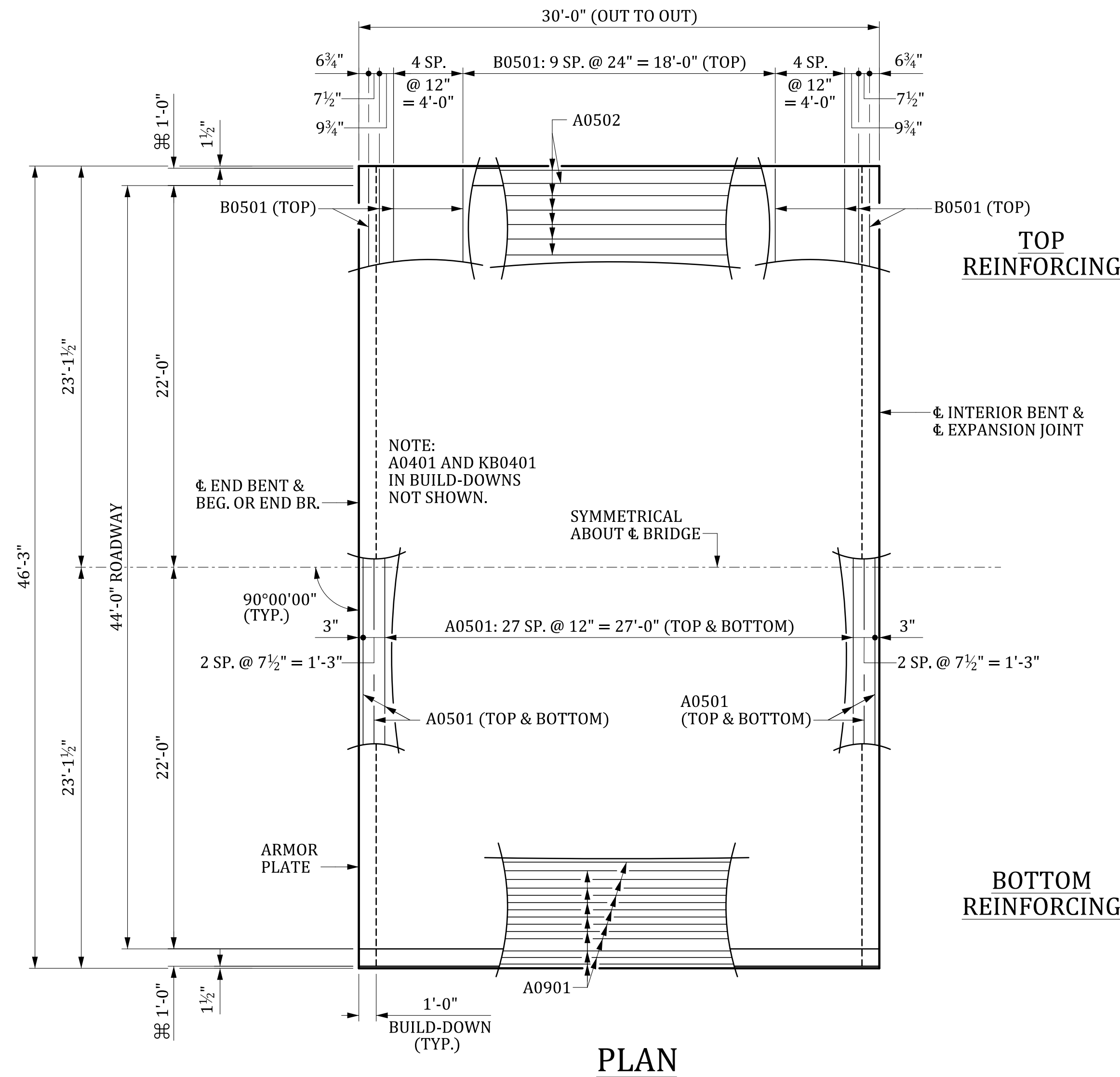

REINFORCING STEEL SCHEDULE						
MARK	NO. REQ'D	DIMENSION				LENGTH
		"a"	"b"	"c"	"d"	
A0401	4	29'-2"	---	---	---	29'-2"
A0501	64	45'-11"	---	---	---	45'-11"
A0502	69	29'-8"	---	---	---	29'-8"
A0901	95	29'-8"	---	---	---	29'-8"
B0501	44	5'-0"	7"	---	---	5'-7"
J0501	90	5½"	3'-3"	---	---	7'-0"
KB0401	60	4½"	1'-6"	8"	---	4'-5"
L0501	90	10"	3'-7"	6½"	3'-7"	8'-7"
SB	2" HT.		AS NECESSARY			
CHCU	12½" HT.		AS NECESSARY			
ESTIMATED QUANTITIES						
ITEM	UNIT	30' SPAN				
2.0" SCH. 80 PVC CONDUIT	LF	120.0				
CONCRETE, CLASS 4000	CY	86.9				
REINFORCING STEEL	LB	16,756				
MASH CONCRETE BARRIER PARAPET	LF	60.0				
ELASTOMERIC BEARING ASSEMBLY (FLAT SLAB)	EA	2				

NOTE:
A0401 AND KB0401
IN BUILD-DOWNS
NOT SHOWN.

SYMMETRICAL
ABOUT ϕ BRIDGE

ARMOR
PLATE

NOTES:

CAST THE 30' UNIT IN ONE POUR FROM ONE END OF SPAN TO THE OTHER USING A SUITABLE SCREED. USE AN APPROVED RETARDING AGENT AND ESTABLISH AND MAINTAIN A MINIMUM POURING RATE OF 45 CY PER HOUR UNLESS APPROVED OTHERWISE BY THE RCE.

DO NOT REMOVE SLAB FALSEWORK UNTIL THE ENTIRE 30' SPAN UNIT HAS BEEN POURED AND CURED ACCORDING TO SECTION 702 OF THE STANDARD SPECIFICATIONS.

CAST BARRIER PARAPET CONCRETE AFTER SLAB FALSEWORK HAS BEEN STRUCK.

FOR ARMOR PLATE DETAIL, SEE "GENERAL DETAILS" SHEET.

FOR TYPICAL SECTION, SECTION THRU BARRIER PARAPET, SLAB BUILD-DOWN DETAILS AND DRAIN DETAILS, SEE "30' FLAT SLAB UNIT (END SPAN) SUPERSTRUCTURE DETAILS" SHEET.

FOR SLAB DRAIN LOCATIONS, SEE "BRIDGE PLAN AND PROFILE" SHEET.

FOR REINFORCING BENDING DETAILS, SEE "REINFORCING BENDING DETAILS" SHEETS.

\otimes MASH BARRIER PARAPET

REV.	BY	CHK.	DATE	DESCRIPTION OF REVISION

REVIEWED	CTM	GCM	11-23
QUAN.	CTM	MWB	11-23
DR.	SJA	DPP	10-23
DES.	BY	CHK.	DATE

THIS DRAWING IS FURNISHED FOR INFORMATION ONLY. ALL DIMENSIONS SHOWN ARE SHEET SPECIFIC. ANY USE OF THIS DESIGN AND DRAWING, INCLUDING DIMENSIONS, MUST BE CHECKED BY THE USER'S ENGINEER TO ENSURE DESIGN IS ADEQUATE FOR THE INTENDED USE. ALL DRAWINGS MUST BE SIGNED AND SEALED BY A SOUTH CAROLINA REGISTERED PROFESSIONAL ENGINEER WHEN USED.

CONSULTANT NAME/LOGO	
SOUTH CAROLINA DEPARTMENT OF TRANSPORTATION	
30' FLAT SLAB UNIT(END SPAN) SUPERSTRUCTURE (44'-0" ROADWAY)	
COUNTY: ####	ROUTE: ####