



REPLY TO
ATTENTION OF

DEPARTMENT OF THE ARMY
CHARLESTON DISTRICT, CORPS OF ENGINEERS
69-A HAGOOD AVENUE
CHARLESTON, SOUTH CAROLINA 29403-5107

JAN 11 2017

Regulatory Division

Ms. Siobhan O. Gordon
South Carolina Department of Transportation
Post Office Box 191
Columbia, South Carolina 29202-0191

Dear Ms. Gordon:

This letter is in response to an email dated December 16, 2016, requesting to modify authorization number SAC-2015-0155-DS, issued on December 12, 2016. The modification consists of changes to the required compensatory mitigation to allow for the purchase of a minimum of 50% stream restoration credits. The original Pre-Construction Notification (PCN) was received on October 3, 2016, and determined complete on December 2, 2016. By submittal of the PCN, you requested verification that the proposed project is authorized by Department of the Army (DA) General Permit No. SAC 2015-1280.

The PCN contains the following identifying information for this project. The work affecting jurisdictional waters of the United States, is part of an overall project known as the Interstate 77 Widening and Rehabilitation project. The project involves the placement of fill material, specifically for the replacement of an outfall pipe and the placement of rip-rap pads for scour protection at culvert ends, into 0.05-acre of jurisdictional wetlands and 151 linear feet (0.07-acre) of jurisdictional tributaries, all of which are permanent impacts, and 0.127-acre of temporary clearing impacts to jurisdictional wetlands for construction access. The project is located on Interstate 77, between mile markers 15 and 27, in Columbia and Blythewood, Richland County, South Carolina (Latitude: 34.054575°N, Longitude: -80.922825°W). The PCN also includes the following supplemental information:

- a. Thirty sheets of drawings, entitled "Site Location Map, Application by SCDOT, Project ID P027002: I-77 Widening and Rehabilitation (MM15-MM27), Richland County, SC", sheet 1 of 31, dated August 2016 and "Sheet Layout, Application by SCDOT, Project ID P027002: I-77 Widening and Rehabilitation (MM15-MM27), Richland County, SC", sheets 3 through 31 of 31, dated August 2016, as revised October 27, 2016 (Sheets 17, 21, 25, & 26) and November 18, 2016 (Sheets 8, 9, 11, 12, 13, & 20). (Previously Sent)

- b. A mitigation plan that includes the purchase of 262.75 stream credits from the Mill Creek Mitigation Bank and 90.85 stream credits from the Sandy Fork Mitigation Bank, of which at least 50% of the total must be restoration credits.
- c. A delineation of special aquatic sites (SAC-2015-00155-DS, issued July 28, 2015).
- d. General Permit Assessment Form dated September 30, 2016, and a Biological Survey for Threatened and Endangered Species dated January 21, 2015, both updated November 22, 2016 and November 18, 2016, respectively.

Based on a review of the PCN, including the supplemental information indicated above and additional information submitted as requested, it has been determined that the proposed activity will result in minimal individual and cumulative adverse environmental effects and is not contrary to the public interest. Furthermore, the activity meets the terms and conditions of DA General Permit No. SAC 2015-1280.

For this authorization to remain valid, the project must comply with all conditions listed in the SCDOT General Permit No. SAC 2015-1280, dated July 20, 2016, and the following special conditions:

1. That as compensatory mitigation for permanent impacts to streams, the permittee agrees to purchase 262.75 stream credits from the Mill Creek Mitigation Bank and 90.85 stream credits from the Sandy Fork Mitigation Bank, of which at least 50% of the total must be restoration credits, and submit evidence of the purchase of the required credits to both the Corps of Engineers and SCDHEC prior to commencement of the authorized work.
2. This verification does not authorize any additional impact, either temporary or permanent, in jurisdictional waters of the U.S., including wetlands, than what is stated above. This verification authorizes permanent impacts to 0.05-acre of wetlands and 151 linear feet (0.07-acre) of tributaries and temporary impacts to 0.127-acre of wetlands for construction access.
3. No safety zone clearing in jurisdictional waters of the U.S., including wetlands, is authorized by this permit verification.
4. Areas cleared within jurisdictional waters of the U.S., including wetlands, for construction access must be restored to pre-construction grades and vegetated with an appropriate wetland seed mix immediately after project construction. Construction access areas within jurisdictional waters of the U.S., including wetlands, are not authorized to be maintained beyond project construction.
5. To ensure passage of aquatic organisms during low-flow conditions, all rip-rap placed on stream beds below the ordinary high water mark must be placed such that the top of the rip-rap stone is at the existing bottom elevation of the stream.

6. Construction along those portions of roadway over Lake Windsor, between Stations 1247+75 to 1250+00, must take place from pile supported platforms and/or trestles. No fill or other structures (i.e., coffer dams, sheet pile walls, fill roads, etc.), excavation, grubbing, or mechanized land clearing are authorized for construction access in this area.
7. All wetland areas, other than those authorized for impact by this verification, must be protected with blaze orange fencing during construction activities. The fencing may be removed after construction within waters of the U.S., including wetlands, is complete.
8. The excavation of accumulated sediments within drainage ditches may be exempt from DA permitting requirements under Section 404(f) of the Clean Water Act found at 33 CFR 323.4(a)(3), provided that:
 - a. The ditch is an existing, functional drainage ditch;
 - b. The maintenance activity is limited to the physical preservation of the original, as-built configuration of the drainage ditch to restore the original function and the approximate capacity of the ditch. Removal of material and re-contouring of the ditch should be in accordance with the historical design and function of that ditch (i.e., the ditch must not be substantially deepened so as to drain additional areas);
 - c. The maintenance activity does not include ditch relocation, ditch conversion to pipe, etc.; and,
 - d. The maintenance activity does not involve any activity whose purpose is to convert an area of waters of the U.S. into a use to which it was not previously subject or where the flow or circulation of waters of the U.S. may be impaired or the reach of such waters reduced.
9. That the construction, use, and maintenance of the authorized activity is in accordance with the information given in the PCN and any revised information provided, including the supplemental information listed above, and is subject to any conditions or restrictions imposed by this letter.
10. That the permittee shall submit the attached signed compliance certification to the Corps within 30 days following completion of the authorized work.
11. That appropriate soil and erosion control methods will be used at all times during construction activities. Prior to the initiation of the project, sediment barriers such as silt fencing, hay bales or other suitable devices will be placed between the adjacent wetlands or waterways and the project construction and staging areas. All erosion control methods will be regularly inspected and maintained in functional order during the course of the project. All exposed soils, in the project

area and staging area will be contained during construction activities and permanently stabilized upon the completion of the project. Once initiated, construction will be carried to completion in an expeditious manner in order to minimize the period of disturbance.

12. That any and all construction and/or demolition materials removed in conjunction with this project be disposed of at an appropriate upland location.

This verification is valid until DA General Permit No. SAC 2015-1280 expires on July 20, 2021, and **supersedes** the previously issued DA permit/verification for this project issued on December 12, 2016. Your cooperation in the protection and preservation of our navigable waters and natural resources is appreciated. In all future correspondence concerning this matter, please refer to our file number SAC-2015-00155-DS. A copy of this letter is being forwarded to certain State and/or Federal agencies for their information. If you have any questions concerning this matter, please contact John N. Policarpo, Project Manager, at 843-329-8043, or at john.n.policarpo@usace.army.mil.

Sincerely,

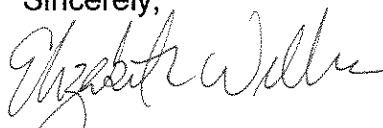

Elizabeth G. Williams
Chief, Special Projects Branch

Copy Furnished:

Mr. John Collum
Tidewater, A JMT Division
P.O. Box 8902
Columbia, South Carolina 29202



REPLY TO
ATTENTION OF

DEPARTMENT OF THE ARMY
CHARLESTON DISTRICT, CORPS OF ENGINEERS
69-A HAGOOD AVENUE
CHARLESTON, SOUTH CAROLINA 29403-5107

DEC 12 2016

Regulatory Division

Ms. Siobhan O. Gordon
South Carolina Department of Transportation
Post Office Box 191
Columbia, South Carolina 29202-0191

RECEIVED
DEC 15 2016
Environmental Management
SCDOT

Dear Ms. Gordon:

This letter is in response to a Pre-Construction Notification (PCN) received on October 3, 2016, and determined complete on December 2, 2016. By submittal of the PCN, you requested verification that the proposed project is authorized by Department of the Army (DA) General Permit No. SAC 2015-1280.

The PCN contains the following identifying information for this project. The work affecting jurisdictional waters of the United States, is part of an overall project known as the Interstate 77 Widening and Rehabilitation project. The project involves the placement of fill material, specifically for the replacement of an outfall pipe and the placement of rip-rap pads for scour protection at culvert ends, into 0.05-acre of jurisdictional wetlands and 151 linear feet (0.07-acre) of jurisdictional tributaries, all of which are permanent impacts, and 0.127-acre of temporary clearing impacts to jurisdictional wetlands for construction access. The project is located on Interstate 77, between mile markers 15 and 27, in Columbia and Blythewood, Richland County, South Carolina (Latitude: 34.054575°N, Longitude: -80.922825°W). The PCN also includes the following supplemental information:

- a. Thirty sheets of drawings, entitled "Site Location Map, Application by SCDOT, Project ID P027002: I-77 Widening and Rehabilitation (MM15-MM27), Richland County, SC", sheet 1 of 31, dated August 2016 and "Sheet Layout, Application by SCDOT, Project ID P027002: I-77 Widening and Rehabilitation (MM15-MM27), Richland County, SC", sheets 3 through 31 of 31, dated August 2016, as revised October 27, 2016 (Sheets 17, 21, 25, & 26) and November 18, 2016 (Sheets 8, 9, 11, 12, 13, & 20).
- b. A mitigation plan that includes the purchase of 262.75 stream restoration credits from the Mill Creek Mitigation Bank and 90.85 stream restoration credits from the Sandy Fork Mitigation Bank.

- c. A delineation of special aquatic sites (SAC-2015-00155-DS, issued July 28, 2015).
- d. General Permit Assessment Form dated September 30, 2016, and a Biological Survey for Threatened and Endangered Species dated January 21, 2015, both updated November 22, 2016 and November 18, 2016, respectively.

Based on a review of the PCN, including the supplemental information indicated above and additional information submitted as requested, it has been determined that the proposed activity will result in minimal individual and cumulative adverse environmental effects and is not contrary to the public interest. Furthermore, the activity meets the terms and conditions of DA General Permit No. SAC 2015-1280.

For this authorization to remain valid, the project must comply with all conditions listed in the SCDOT General Permit No. SAC 2015-1280, dated July 20, 2016, and the following special conditions:

1. That as compensatory mitigation for permanent impacts to streams, the permittee agrees to purchase 262.75 stream restoration credits from the Mill Creek Mitigation Bank and 90.85 stream restoration credits from the Sandy Fork Mitigation Bank and submit evidence of the purchase of the required credits to both the Corps of Engineers and SCDHEC prior to commencement of the authorized work.
2. This verification does not authorize any additional impact, either temporary or permanent, in jurisdictional waters of the U.S., including wetlands, than what is stated above. This verification authorizes permanent impacts to 0.05-acre of wetlands and 151 linear feet (0.07-acre) of tributaries and temporary impacts to 0.127-acre of wetlands for construction access.
3. No safety zone clearing in jurisdictional waters of the U.S., including wetlands, is authorized by this permit verification.
4. Areas cleared within jurisdictional waters of the U.S., including wetlands, for construction access must be restored to pre-construction grades and vegetated with an appropriate wetland seed mix immediately after project construction. Construction access areas within jurisdictional waters of the U.S., including wetlands, are not authorized to be maintained beyond project construction.
5. To ensure passage of aquatic organisms during low-flow conditions, all rip-rap placed on stream beds below the ordinary high water mark must be placed such that the top of the rip-rap stone is at the existing bottom elevation of the stream.
6. Construction along those portions of roadway over Lake Windsor, between Stations 1247+75 to 1250+00, must take place from pile supported platforms and/or trestles. No fill or other structures (i.e., coffer dams, sheet pile walls, fill

roads, etc.), excavation, grubbing, or mechanized land clearing are authorized for construction access in this area.

7. All wetland areas, other than those authorized for impact by this verification, must be protected with blaze orange fencing during construction activities. The fencing may be removed after construction within waters of the U.S., including wetlands, is complete.
8. The excavation of accumulated sediments within drainage ditches may be exempt from DA permitting requirements under Section 404(f) of the Clean Water Act found at 33 CFR 323.4(a)(3), provided that:
 - a. The ditch is an existing, functional drainage ditch;
 - b. The maintenance activity is limited to the physical preservation of the original, as-built configuration of the drainage ditch to restore the original function and the approximate capacity of the ditch. Removal of material and re-contouring of the ditch should be in accordance with the historical design and function of that ditch (i.e., the ditch must not be substantially deepened so as to drain additional areas);
 - c. The maintenance activity does not include ditch relocation, ditch conversion to pipe, etc.; and,
 - d. The maintenance activity does not involve any activity whose purpose is to convert an area of waters of the U.S. into a use to which it was not previously subject or where the flow or circulation of waters of the U.S. may be impaired or the reach of such waters reduced.
9. That the construction, use, and maintenance of the authorized activity is in accordance with the information given in the PCN and any revised information provided, including the supplemental information listed above, and is subject to any conditions or restrictions imposed by this letter.
10. That the permittee shall submit the attached signed compliance certification to the Corps within 30 days following completion of the authorized work.
11. That appropriate soil and erosion control methods will be used at all times during construction activities. Prior to the initiation of the project, sediment barriers such as silt fencing, hay bales or other suitable devices will be placed between the adjacent wetlands or waterways and the project construction and staging areas. All erosion control methods will be regularly inspected and maintained in functional order during the course of the project. All exposed soils, in the project area and staging area will be contained during construction activities and permanently stabilized upon the completion of the project. Once initiated,

construction will be carried to completion in an expeditious manner in order to minimize the period of disturbance.

12. That any and all construction and/or demolition materials removed in conjunction with this project be disposed of at an appropriate upland location.

This verification is valid until DA General Permit No. SAC 2015-1280 expires on July 20, 2021, and supersedes all previously issued DA permits or verifications for this project. Your cooperation in the protection and preservation of our navigable waters and natural resources is appreciated. In all future correspondence concerning this matter, please refer to our file number SAC-2015-00155-DS. A copy of this letter is being forwarded to certain State and/or Federal agencies for their information. If you have any questions concerning this matter, please contact John N. Policarpo, Project Manager, at 843-329-8043, or at john.n.policarpo@usace.army.mil.

Sincerely,



Elizabeth G. Williams
Chief, Special Projects Branch

Enclosures:

Permit Drawings

SCDOT General Permit General Conditions

Compliance Certification Form

Copy Furnished:

Mr. John Collum

Tidewater, A JMT Division

P.O. Box 8902

Columbia, South Carolina 29202

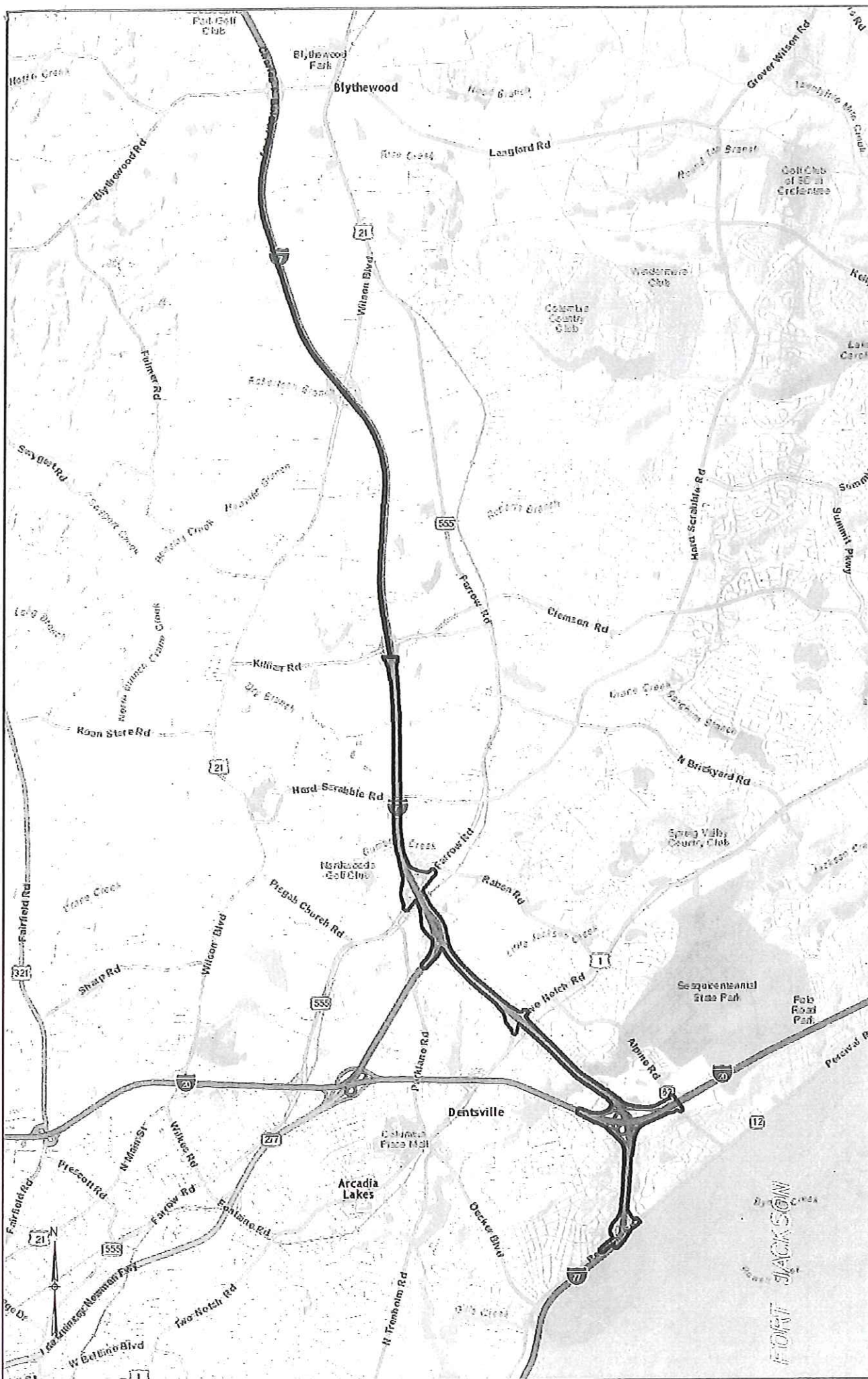

APPLICATION BY SCDOT
 PROJECT ID P027002: I-77 WIDENING
 AND REHABILITATION (MM15-MM27)
 RICHLAND COUNTY, SC
 DATE: 8/2016
 SHEET: 1 OF 31
 REVISION DATE:



SITE LOCATION MAP PERMITTED PLANS



 PROJECT AREA

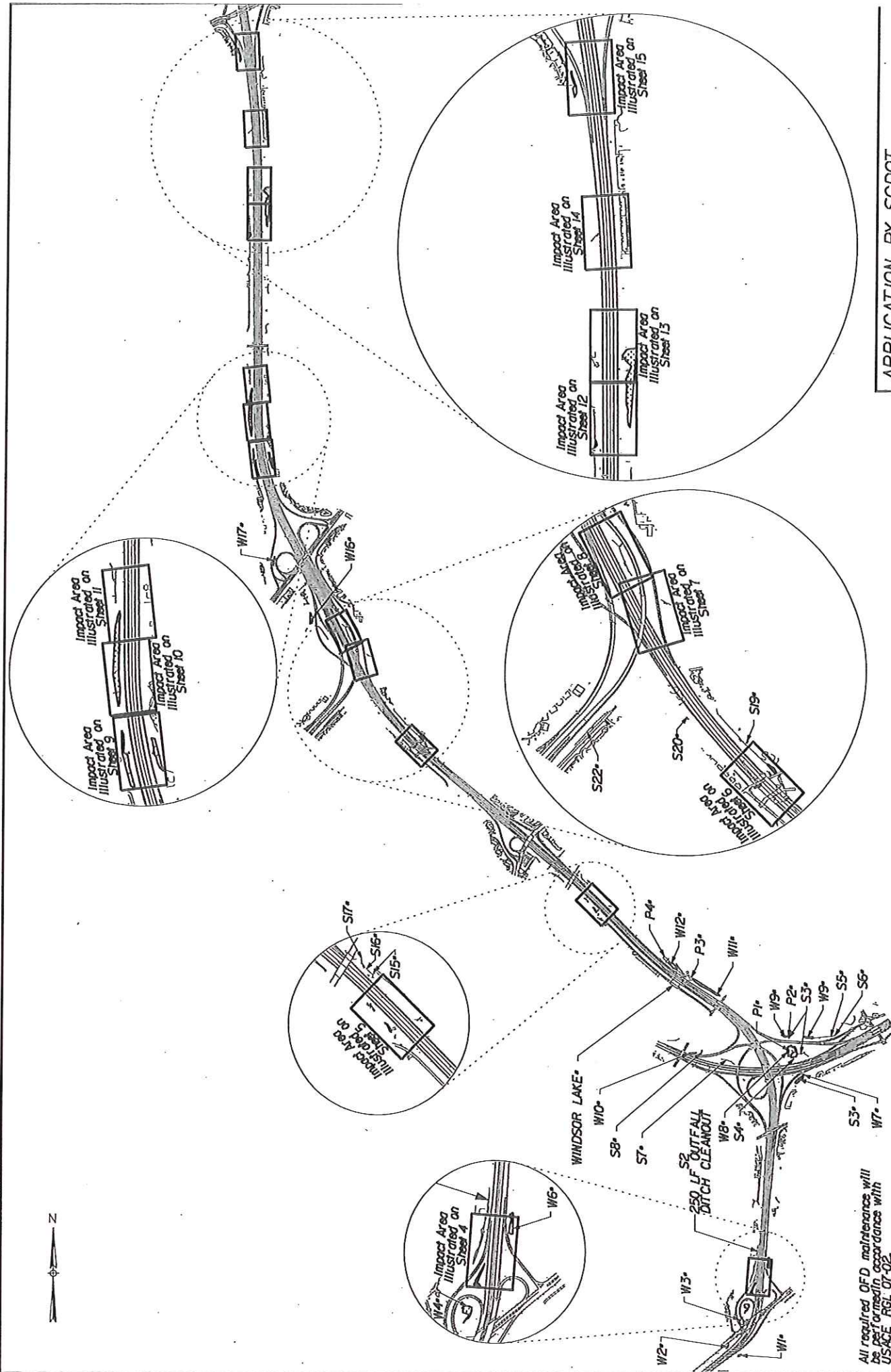

PERMITTED PLANS

SHEET LAYOUT

APPLICATION BY SCDOT
PROJECT ID P027002: I-77 WIDENING
AND REHABILITATION (MM15-MM27)
RICHLAND COUNTY, SC
DATE: 8/2016
SHEET: 3 OF 31
REVISION DATE:

All required OFD maintenance will be performed in accordance with USACE RCL 07-02.

• DENOTES NO IMPACT

IMPACTS THIS SHEET
WETLAND FILL ----- ACRES
TRIBUTARY ARMOR 5. LF
TRIBUTARY ARMOR 0.002 ACRES
WETLAND BACKFILL ----- ACRES



STREAM 2
5 LF ARMOR
4 CY
REPLACE 8 LF
18" PIPE (NP-0332)
WITHIN IMPACT

APPLICATION BY SCDOT
PROJECT ID P027002: I-77 WIDENING
AND REHABILITATION (MM15-MM27)
RICHLAND COUNTY, SC
DATE: 8/2016
SHEET: 4 OF 31
REVISION DATE:

WETLAND 6 /
(NO IMPACT)
CLEANOUT 7 LF INSIDE CULVERT
All required OFD maintenance will be performed
In accordance with USACE RGL 07-02.

All required OFD maintenance will be performed in accordance with USACE RGL 07-02.

LEGEND

| | |
|---|------------------------|
| --- | LIMITS OF CONSTRUCTION |
| -.-.- | STREAM LIMITS |
|  | RIPRAP |
|  | WETLANDS |

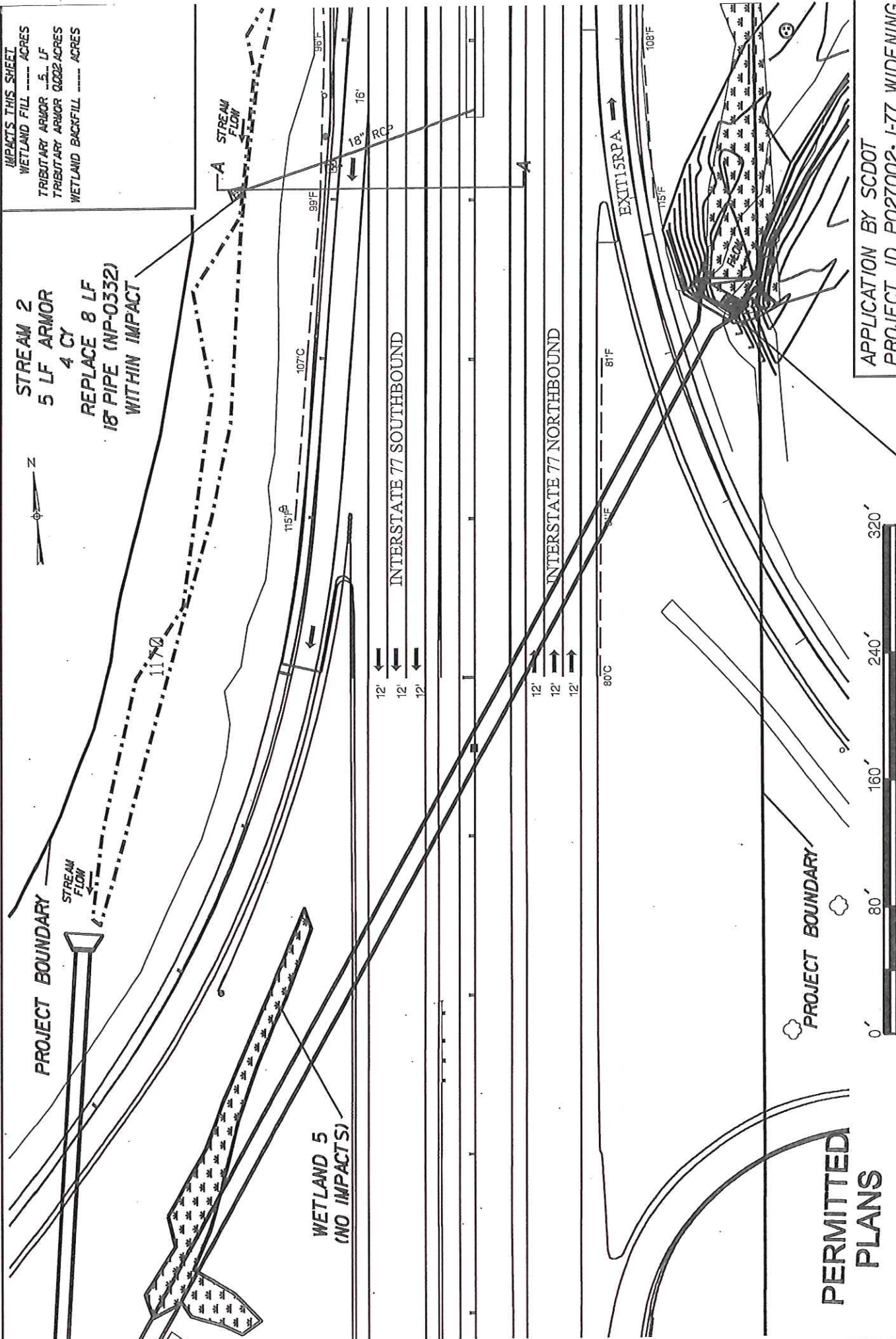

IMPACTS THIS SHEET
 WETLAND FILL --- ACRES
 TRIBUTARY ARMOR 33 LF
 TRIBUTARY ARMOR 0005 ACRES
 WETLAND BACKFILL --- ACRES

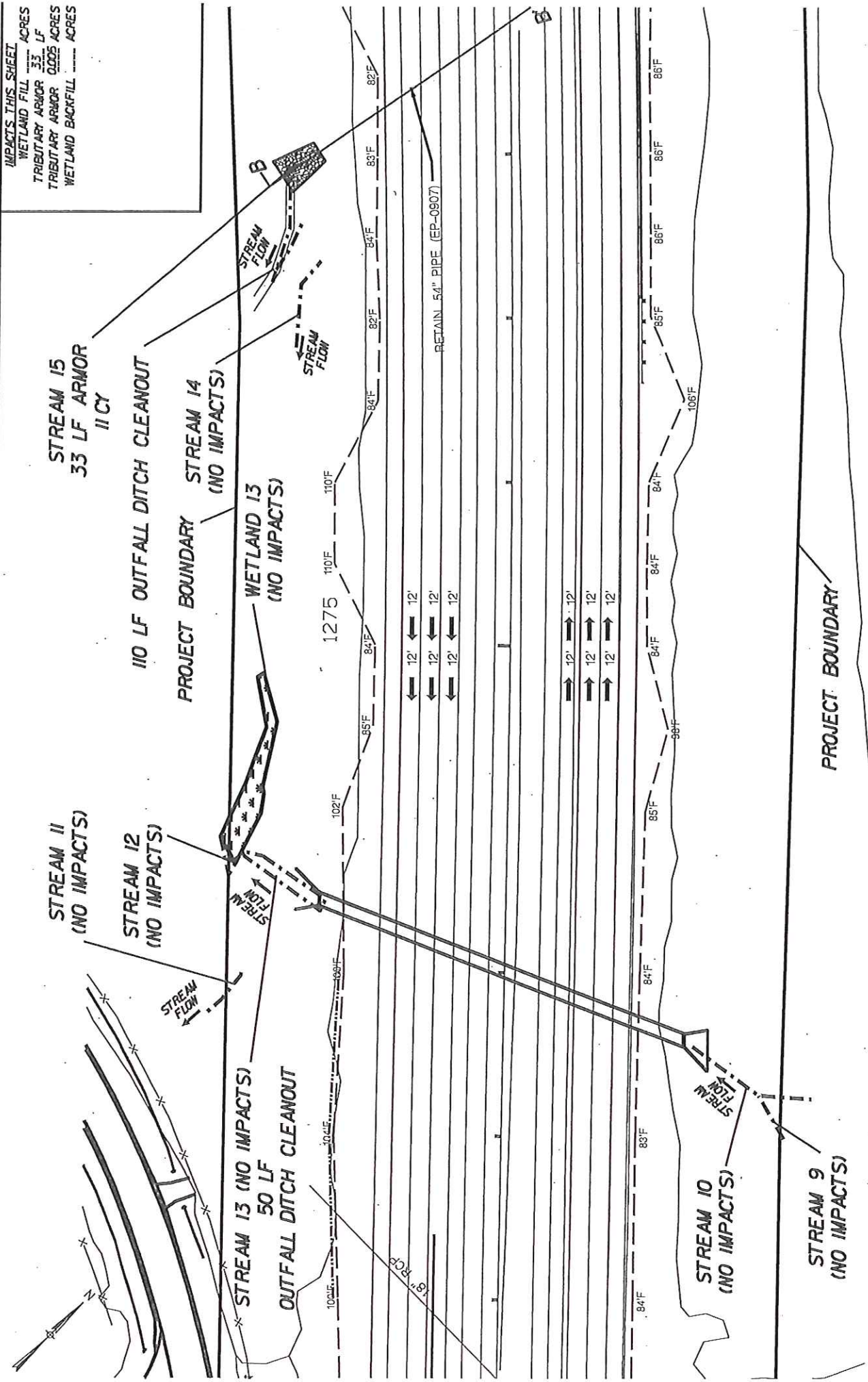

APPLICATION BY SCDOT
 PROJECT ID P027002: I-77 WIDENING
 AND REHABILITATION (MM15-MM27)
 RICHLAND COUNTY, SC
 DATE: 8/2016
 SHEET: 5 OF 31
 REVISION DATE:

PERMITTED PLANS



All required OFD maintenance will be performed
 in accordance with USACE RGL 07-02.

LEGEND

- LIMITS OF CONSTRUCTION
- STREAM LIMITS
- RIPRAP
- WETLANDS

IMPACTS THIS SHEET
 WETLAND FILL --- ACRES
 TRIBUTARY ARMOR 15 LF
 TRIBUTARY ARMOR 0.01 ACRES
 WETLAND BACKFILL --- ACRES

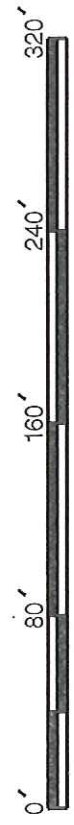
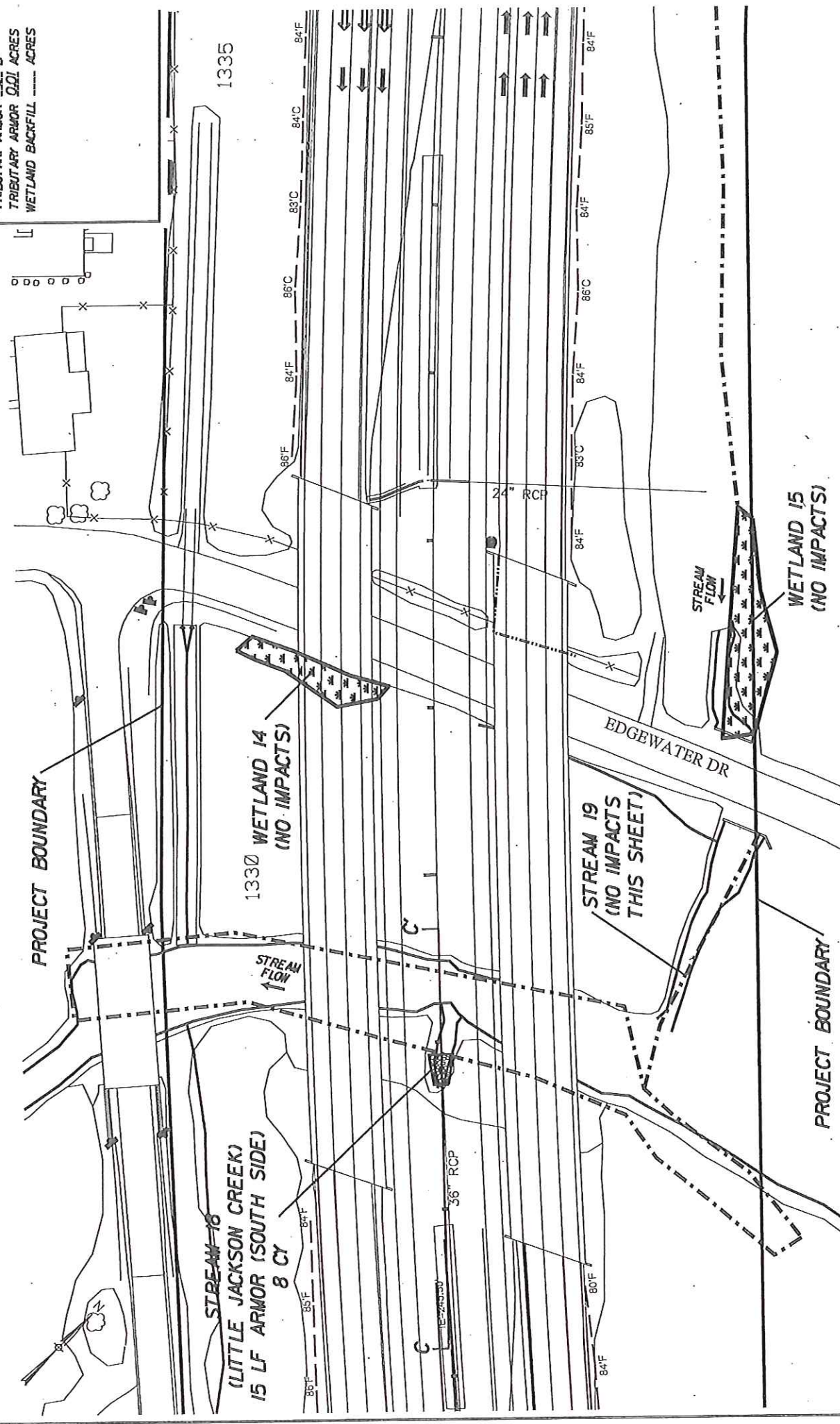

PERMITTED PLANS

| | |
|------------------------|---------|
| LEGEND | |
| LIMITS OF CONSTRUCTION | --- |
| STREAM LIMITS | --- |
| RIPRAP | ---X--- |
| WETLANDS | ---X--- |

APPLICATION BY SCDOT
 PROJECT ID P027002: I-77 WIDENING
 AND REHABILITATION (MM15-MM27)
 RICHLAND COUNTY, SC
 DATE: 8/2016
 SHEET: 6 OF 31
 REVISION DATE:

IMPACTS THIS SHEET
 WETLAND FILL ----- ACRES
 TRIBUTARY ARMOR 15 LF
 TRIBUTARY ARMOR 002 ACRES
 WETLAND BACKFILL ----- ACRES



APPLICATION BY SCDOT
 PROJECT ID P027002: I-77 WIDENING
 AND REHABILITATION (MM15-MM27)
 RICHLAND COUNTY, SC
 DATE: 8/2016
 SHEET: 7 OF 31
 REVISION DATE:

PERMITTED PLANS

LEGEND

- LIMITS OF CONSTRUCTION
- STREAM LIMITS
- RIPRAP
- WETLANDS

--- LIMITS OF CONSTRUCTION

--- STREAM LIMITS

--- RIPRAP

--- WETLANDS

All required OFD maintenance will be performed
 in accordance with USACE RGL 07-02.

PERMITTED PLANS

LEGEND
LIMITS OF
CONSTRUCTION
STREAM LIMITS
RIPRAP
WETLANDS

IMPACTS THIS SHEET
WETLAND FILL 0.018 ACRES
TRIBUTARY ARMOR 1.5 LF
TRIBUTARY ARMOR 0.012 ACRES
WETLAND BACKFILL 0.012 ACRES

47 LF OUTFALL DITCH CLEANOUT
75 CY

STREAM 24 (CUMBUSS CREEK)
(NO IMPACTS)
1410

1410

WETLAND 18
(NO IMPACTS)
1405

1405

INTERSTATE 77 SOUTHBOUND

INTERSTATE 77 NORTHBOUND

STREAM 23 (CUMBUSS CREEK)
1.5 LF ARMOR OUTSIDE OF WETLAND 19
26 CY

26 CY

764 SF RIPRAP FILL
0.018 ACRES
37 CY

37 CY

(STREAM 23 WITHIN IMPACT)
TREE CUTTING FOR
— TEMPORARY CONSTRUCTION
ACCESS 0.036 AC.



PERMITTED PLANS

All required OFD maintenance will be performed
in accordance with USACE RGL 07-02.

| LEGEND |
|----------------------------|
| --- LIMITS OF CONSTRUCTION |
| - - - - - STREAM LIMITS |
| ▨ RIPRAP |
| ▨ WETLANDS |

APPLICATION BY SCDOT
PROJECT ID P027002: I-77 WIDENING
AND REHABILITATION (MM15-MM27)
RICHLAND COUNTY, SC
DATE: 8/2016
SHEET: 9 OF 31
REVISION DATE: 11/18/16

IMPACTS THIS SHEET
 WETLAND FILL 0.002 ACRES
 TRIBUTARY ARMOR LF
 TRIBUTARY ARMOR ACRES
 WETLAND BACKFILL 0.001 ACRES

40 SF (0.001 ACRES) EXCAVATE
 AND BACKFILL 3 CY REMOVE AND
 REPLACE 8 LF - 24" PIPE (NP-1821)
 STREAM 25
 (NO IMPACTS THIS SHEET)

180 LF OUTFALL DITCH CLEANOUT
 30 CY

PROJECT
 BOUNDARY

WETLAND 20
 162 SF RIPRAP FILL
 0.002 ACRES
 6 CY

1415
 100°F

1420
 98°F

INTERSTATE 77 SOUTHBOUND

INTERSTATE 77 NORTHBOUND

24" RCP
 24" RCP

PROJECT BOUNDARY

PARKING

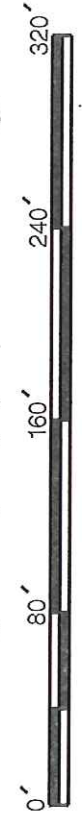

LEGEND

| | |
|-----|------------------------|
| --- | LIMITS OF CONSTRUCTION |
| --- | STREAM LIMITS |
| ▨ | RIPRAP |
| ▨ | WETLANDS |

PERMITTED PLANS

All required OFD maintenance will be performed
 in accordance with USACE RGL 07-02.

APPLICATION BY SCDOT
 PROJECT ID P027002: I-77 WIDENING
 AND REHABILITATION (MM15-MM27)
 RICHLAND COUNTY, SC
 DATE: 8/2016
 SHEET: 10 OF 31
 REVISION DATE:

IMPACTS THIS SHEET
 WETLAND FILL 0.003 ACRES
 TRIBUTARY ARMOR LF
 TRIBUTARY ARMOR ACRES
 WETLAND BACKFILL ACRES

WETLAND 20
 150 SF RIPRAP FILL
 0.003 ACRES
 7 Cy

70 LF OUTFALL DITCH CLEANOUT
 EST. EXC. 25 CY

(STREAM 25 WITHIN IMPACT)
 TREE CUTTING FOR TEMPORARY
 CONSTRUCTION ACCESS 0.018 AC.

PROJECT BOUNDARY

PROJECT BOUNDARY

PERMITTED PLANS

All required OFD maintenance will be performed
 in accordance with USACE RGL 07-02.



| LEGEND |
|----------------------------|
| --- LIMITS OF CONSTRUCTION |
| --- STREAM LIMITS |
| --- RIPRAP |
| --- WETLANDS |

APPLICATION BY SCDOT
 PROJECT ID P027002: I-77 WIDENING
 AND REHABILITATION (MM15-MM27)
 RICHLAND COUNTY, SC
 DATE: 8/2016
 SHEET: II OF 31
 REVISION DATE: 11/18/16

IMPACTS THIS SHEET
 WETLAND FILL 0.002 ACRES
 TRIBUTARY ARMOR LF
 TRIBUTARY ARMOR ACRES
 WETLAND BACKFILL ACRES

90 LF OUTFALL DITCH CLEANOUT
 EST. EXC. 60 CY
 TREE CUTTING FOR TEMPORARY
 CONSTRUCTION ACCESS 0.039 AC.

WETLAND 21
 100 SF RIPRAP FILL
 0.002 ACRES

PROJECT BOUNDARY

1465

1460

INTERSTATE 77 SOUTHBOUND

INTERSTATE 77 NORTHBOUND

N 0° 36' 13" W

PROJECT BOUNDARY

WETLAND 22
 (NO IMPACTS THIS SHEET)



PERMITTED PLANS

All required OFD maintenance will be performed
 in accordance with USACE RGL 07-02.

| LEGEND | |
|--------|------------------------|
| --- | LIMITS OF CONSTRUCTION |
| --- | STREAM LIMITS |
| | RIPRAP |
| | WETLANDS |

APPLICATION BY SCDOT
 PROJECT ID P027002: I-77 WIDENING
 AND REHABILITATION (MM15-MM27)
 RICHLAND COUNTY, SC
 DATE: 8/2016
 SHEET: 12 OF 31
 REVISION DATE: 11/18/16

IMPACTS THIS SHEET
 WETLAND FILL 0.022 ACRES
 TRIBUTARY ARMOR 23 LF
 TRIBUTARY ARMOR 0.008 ACRES
 WETLAND BACKFILL 0.008 ACRES

PROJECT BOUNDARY

STREAM 28
 CRANE CREEK
 (NO IMPACTS)

1470

STREAM 26
 (CRANE CREEK)
 23 LF ARMOR OUTSIDE WETLAND 22
 106 CY

WETLAND 22
 942 SF RIPRAP FILL
 0.022 ACRES
 35 CY
 PROJECT BOUNDARY
 (STREAM 26 WITHIN IMPACT)
 TREE CUTTING FOR TEMPORARY
 CONSTRUCTION ACCESS 0.034 AC.



LEGEND
 LIMITS OF
 CONSTRUCTION
 STREAM LIMITS
 RIPRAP
 WETLANDS

PERMITTED PLANS

APPLICATION BY SCDOT
 PROJECT ID P027002: I-77 WIDENING
 AND REHABILITATION (MM15-MM27)
 RICHLAND COUNTY, SC
 DATE: 8/2016
 SHEET: 13 OF 31
 REVISION DATE: 11/18/16

IMPACTS THIS SHEET
 WETLAND FILL ----- ACRES
 TRIBUTARY ARMOR .18 LF
 TRIBUTARY ARMOR 0.008 ACRES
 WETLAND BACKFILL ----- ACRES

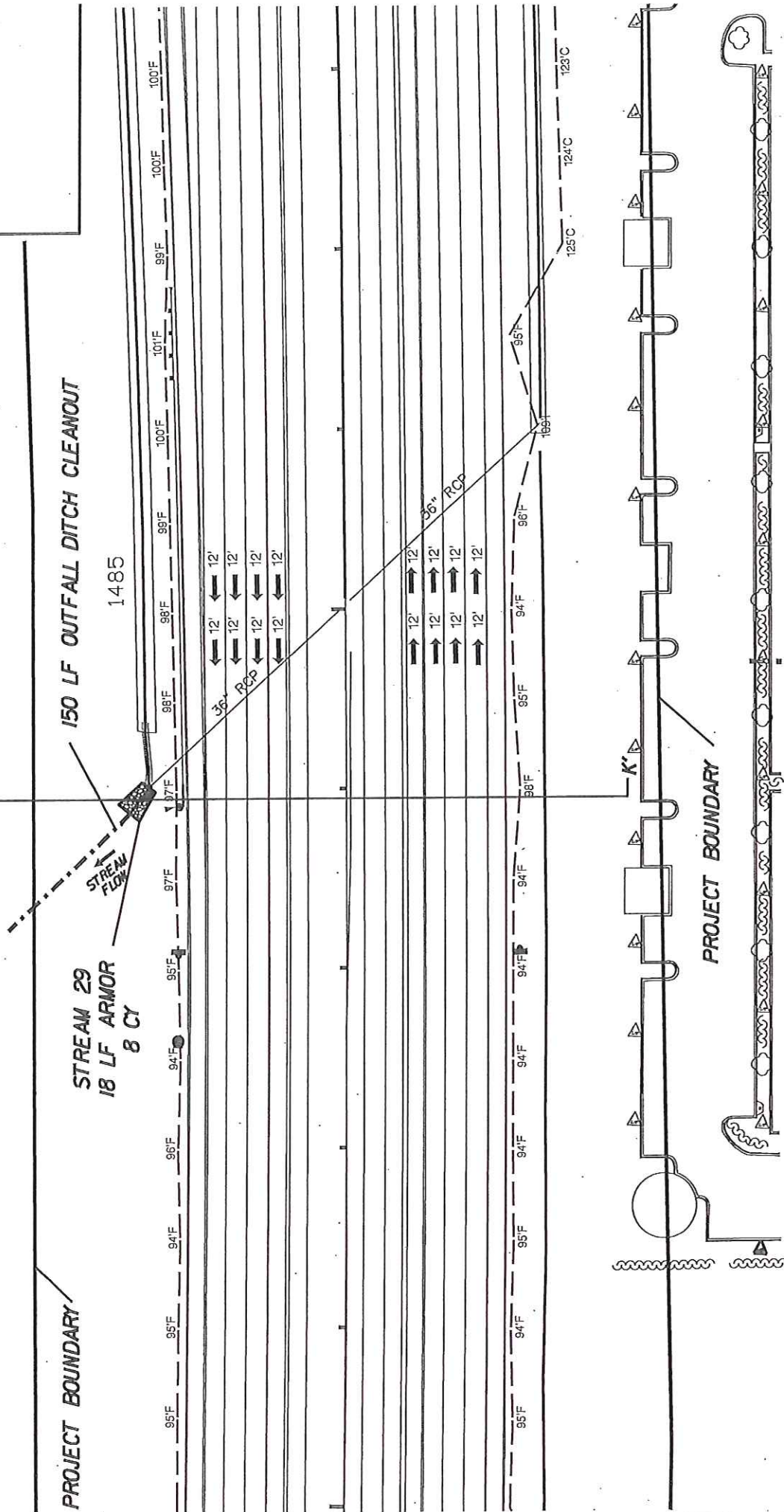

PERMITTED PLANS

All required OFD maintenance will be performed
 in accordance with USACE RGL 07-02.

APPLICATION BY SCDOT
 PROJECT ID P027002: I-77 WIDENING
 AND REHABILITATION (MM15-MM27)
 RICHLAND COUNTY, SC
 DATE: 8/2016
 SHEET: 14 OF 31
 REVISION DATE:

| LEGEND |
|----------------------------|
| --- LIMITS OF CONSTRUCTION |
| --- STREAM LIMITS |
| --- RIPRAP |
| --- WETLANDS |

IMPACTS THIS SHEET
WETLAND FILL 0000 ACRES
TRIBUTARY ARMOR LF
TRIBUTARY ARMOR ACRES
WETLAND BACKFILL ACRES

WETLAND 23
SF RIPRAP FILL
0.001 AC
3 CY

1110 LF OUTFALL DITCH CLEANOUT

PROJECT BOUNDARY

**PROJECT
BOUNDARY**

LEGEND

--- LIMITS OF CONSTRUCTION

--- STREAM LIMITS

 RIPRAP

 WETLANDS

PERMITTED PLANS

*All required OFD maintenance will be performed
In accordance with USACE RGL 07-02.*

APPLICATION BY SCDOT
PROJECT ID P027002: I-77 WIDENING
AND REHABILITATION (MM15-MM27)
RICHLAND COUNTY, SC
DATE: 8/2016
SHEET: 15 OF 31
REVISION DATE:

I-77
STA. 1173+07.66

LIMITS OF CONSTRUCTION

LIMITS OF CONSTRUCTION

STREAM 2
STREAM 2

1/2" = 1' HORIZ

STREAM ARMOR IMPACT

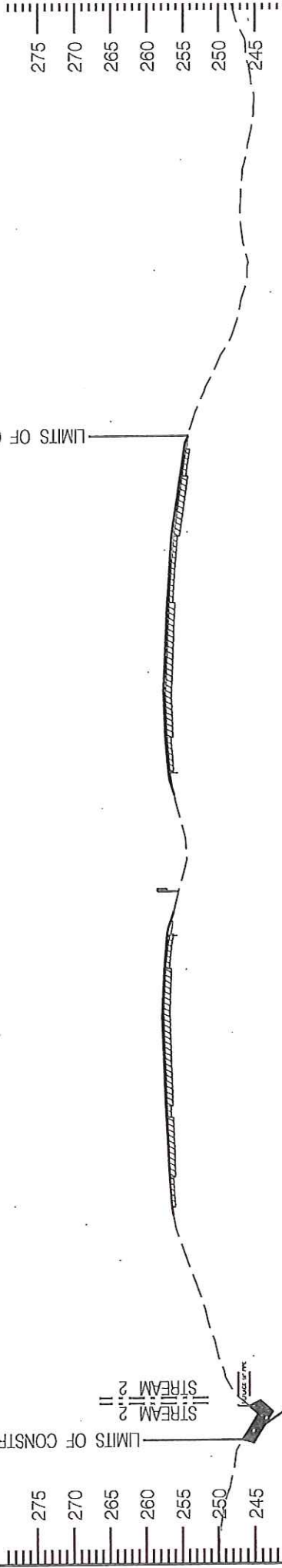

PERMITTED PLANS

SECTION A-A'

APPLICATION BY SCDOT
PROJECT ID P027002: I-77 WIDENING
AND REHABILITATION (MMI5-MM27)
RICHLAND COUNTY, SC
DATE: 8/2016
SHEET: 16 OF 31
REVISION DATE:

LEGEND

- LIMITS OF CONSTRUCTION
- STREAM LIMITS
- ▨ RIPRAP

I-77
STA 1278+80.13

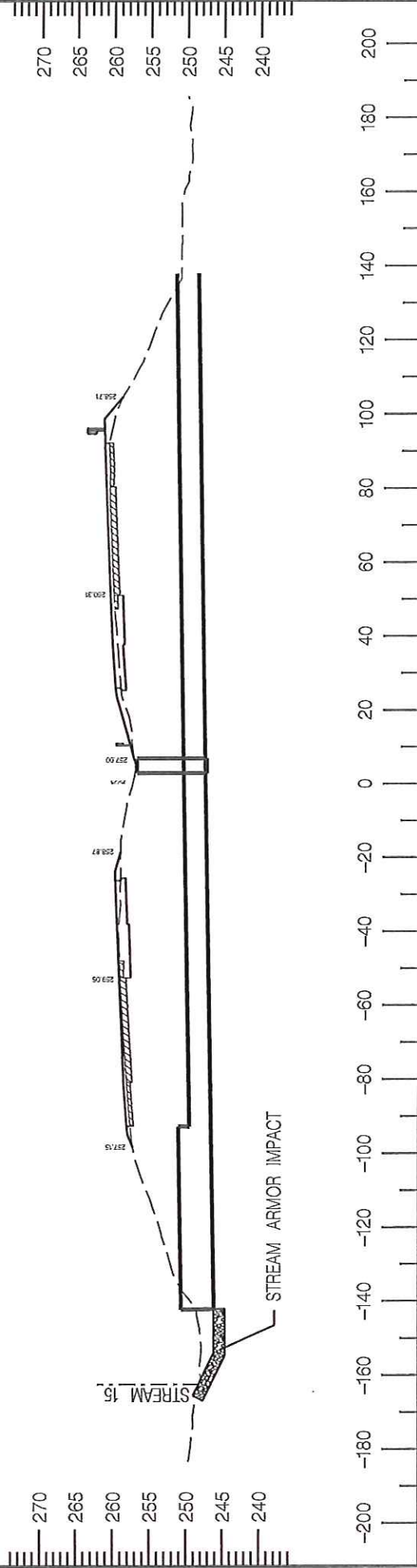

PERMITTED PLANS

SECTION B-B'

APPLICATION BY SCDOT
PROJECT ID P027002: I-77 WIDENING
AND REHABILITATION (MM15-MM27)
RICHLAND COUNTY, SC
DATE: 8/2016
SHEET: 17 OF 31
REVISION DATE: 10/27/16

LEGEND
LIMITS OF
CONSTRUCTION
STREAM LIMITS
RIPRAP

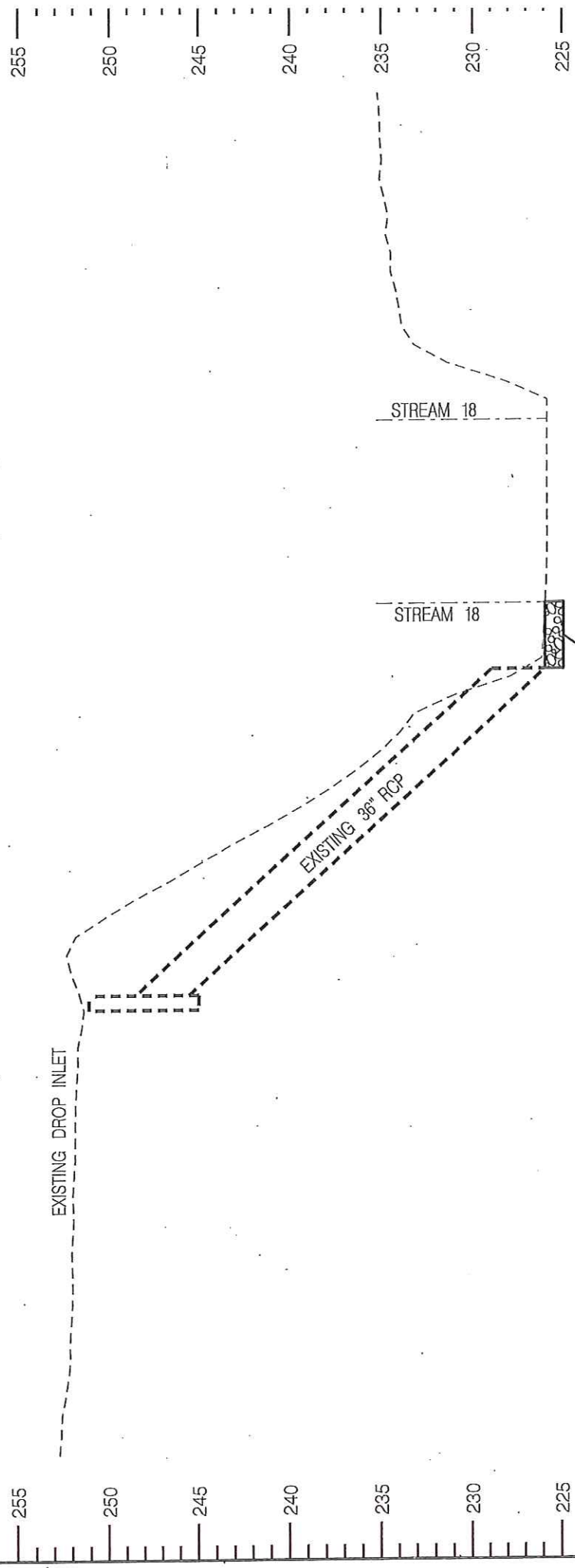

PERMITTED PLANS

APPLICATION BY SCDOT
PROJECT ID P027002: I-77 WIDENING
AND REHABILITATION (MM15-MM27)
RICHLAND COUNTY, SC
DATE: 8/2016
SHEET: 18 OF 31
REVISION DATE:

LEGEND

--- LIMITS OF CONSTRUCTION

--- STREAM LIMITS

RIPRAP

SECTION C-C

I-77
STA. 1355+69.44

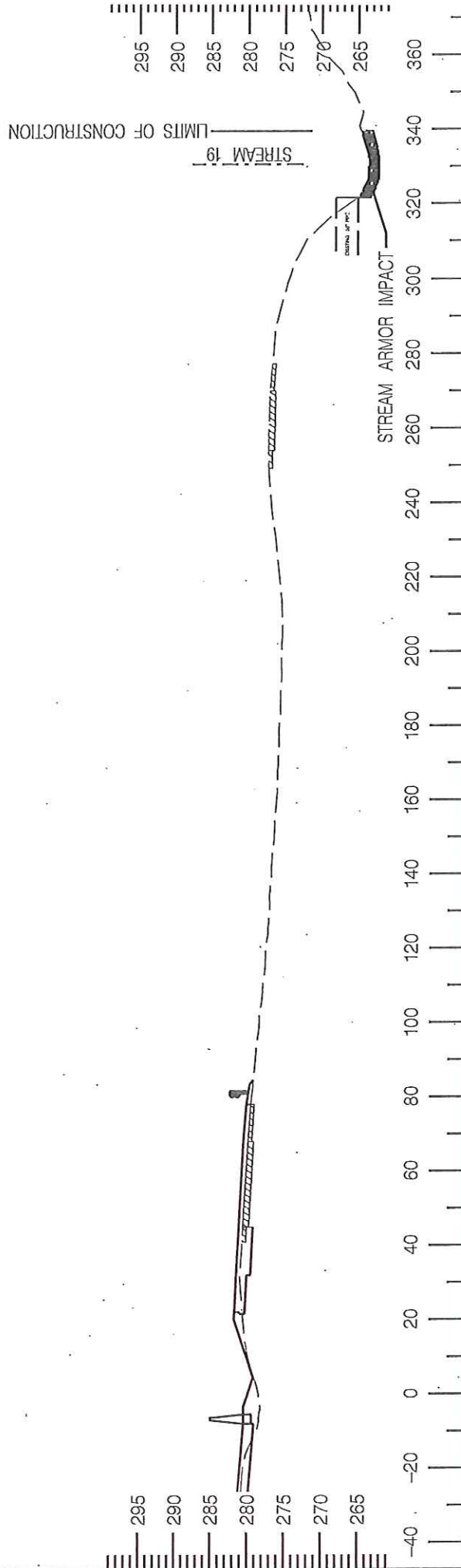

PERMITTED PLANS

SECTION D-D

APPLICATION BY SCDOT
PROJECT ID P027002: I-77 WIDENING
AND REHABILITATION (MM15-MM27)
RICHLAND COUNTY, SC
DATE: 8/2016
SHEET: 19 OF 31
REVISION DATE:

LEGEND

- LIMITS OF CONSTRUCTION
- STREAM LIMITS
- RIPRAP

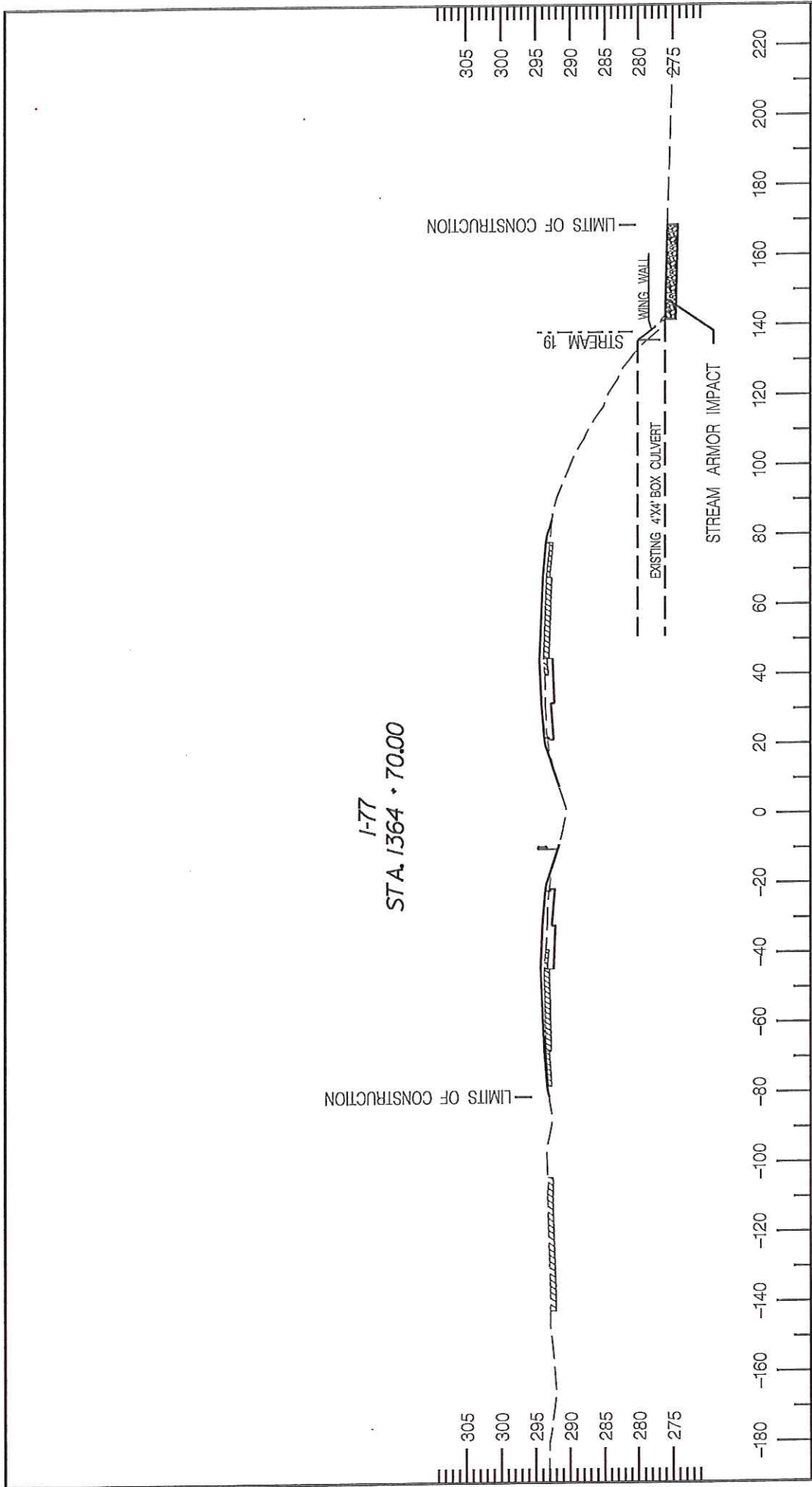

PERMITTED PLANS

SECTION E-E'

APPLICATION BY SCDOT
PROJECT ID P027002: I-77 WIDENING
AND REHABILITATION (MM15-MM27)
RICHLAND COUNTY, SC
DATE: 8/2016
SHEET: 20 OF 31
REVISION DATE: 11/18/16

LEGEND

--- LIMITS OF CONSTRUCTION

--- STREAM LIMITS

RIPRAP

I-77
STA. 1407 + 20.00

LIMITS OF CONSTRUCTION

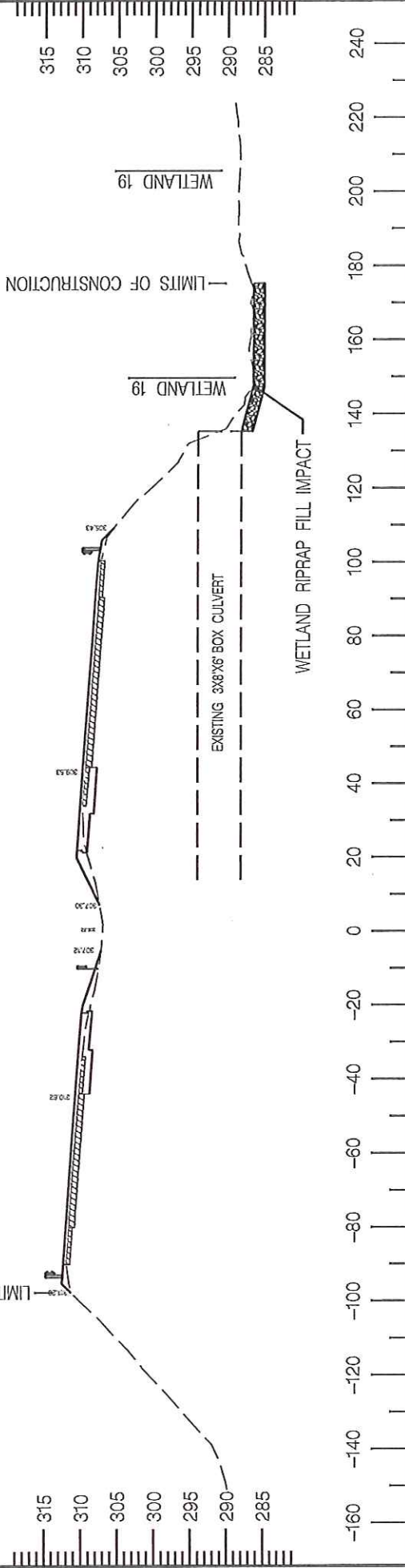

PERMITTED PLANS

SECTION F-F'

APPLICATION BY SCDOT
PROJECT ID P027002: I-77 WIDENING
AND REHABILITATION (MM15-MM27)
RICHLAND COUNTY, SC
DATE: 8/2016
SHEET: 21 OF 31
REVISION DATE: 10/27/16

LEGEND
LIMITS OF
CONSTRUCTION
STREAM LIMITS
RIPRAP

I-77
STA. 1415 + 80.00

— LIMITS OF CONSTRUCTION

— LIMITS OF CONSTRUCTION

WETLAND 20

WETLAND 20

EXISTING 24" RCP

REPLACE 24" RCP

WETLAND BACKFILL IMPACT

WETLAND RIPRAP FILL IMPACT

325
320
315
310
305
300
295

325
320
315
310
305
300
295

180 160 140 120 100 80 60 40 20 0 -20 -40 -60 -80 -100 -120 -140 -160 -180 -200 -220

PERMITTED PLANS

SECTION G-G

APPLICATION BY SCDOT
PROJECT ID P027002: I-77 WIDENING
AND REHABILITATION (MM15-MM27)
RICHLAND COUNTY, SC
DATE: 8/2016
SHEET: 22 OF 31
REVISION DATE:

| LEGEND | |
|--------|------------------------|
| --- | LIMITS OF CONSTRUCTION |
| - - - | STREAM LIMITS |
| | RIPRAP |
| XXXXX | WETLAND BACKFILL |

I-77
STA. 1423 + 15.00

LIMITS OF CONSTRUCTION

LIMITS OF CONSTRUCTION

WETLAND 20'

EXISTING 30' RCP

WETLAND RIPRAP FILL IMPACT

335
330
325
320
315
310
305

335
330
325
320
315
310
305

200 180 160 140 120 100 80 60 40 20 0 -20 -40 -60 -80 -100 -120 -140 -160 -180 -200

PERMITTED PLANS

APPLICATION BY SCDOT
PROJECT ID P027002: I-77 WIDENING
AND REHABILITATION (MM15-MM27)
RICHLAND COUNTY, SC
DATE: 8/2016
SHEET: 23 OF 31
REVISION DATE:

SECTION H-H'

LEGEND
LIMITS OF CONSTRUCTION
STREAM LIMITS
RIPRAP

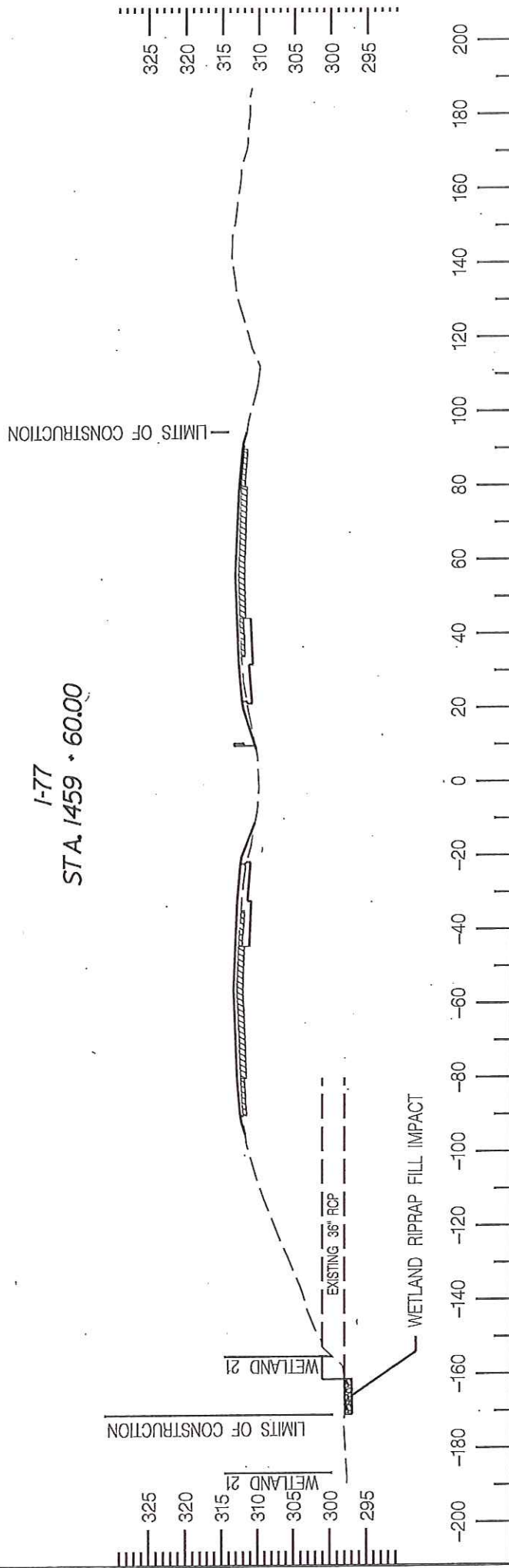

PERMITTED PLANS

SECTION 1-1'

APPLICATION BY SCDOT
PROJECT ID P027002: I-77 WIDENING
AND REHABILITATION (MM15-MM27)
RICHLAND COUNTY, SC
DATE: 8/2016
SHEET: 24 OF 31
REVISION DATE:

LEGEND

--- LIMITS OF CONSTRUCTION

--- STREAM LIMITS

--- RIPRAP



SECTION J-J'

APPLICATION BY SCDOT
PROJECT ID P027002: I-77 WIDENING
AND REHABILITATION (MM15-MM27)
RICHLAND COUNTY, SC
DATE: 8/2016
SHEET: 25 OF 31
REVISION DATE: 10/27/16

I-77
STA. 1484 + 00.00

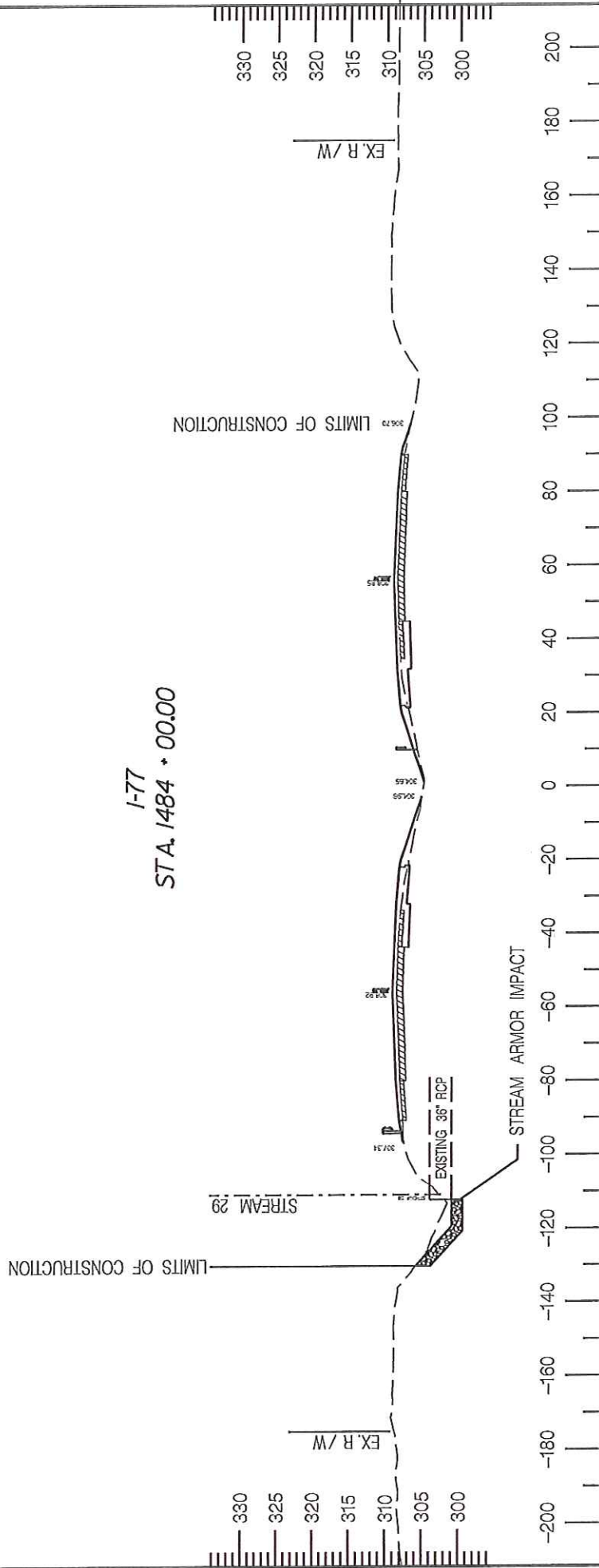

PERMITTED PLANS

SECTION K-K'

APPLICATION BY SCDOT
PROJECT ID P027002: I-77 WIDENING
AND REHABILITATION (MM15-MM27)
RICHLAND COUNTY, SC
DATE: 8/2016
SHEET: 26 OF 31
REVISION DATE: 10/27/16

LEGEND
LIMITS OF
CONSTRUCTION
STREAM LIMITS
RIPRAP

I-77
STA 1503+18.61

WETLAND 23
LIMITS OF CONSTRUCTION

WETLAND RIPRAP FILL IMPACT

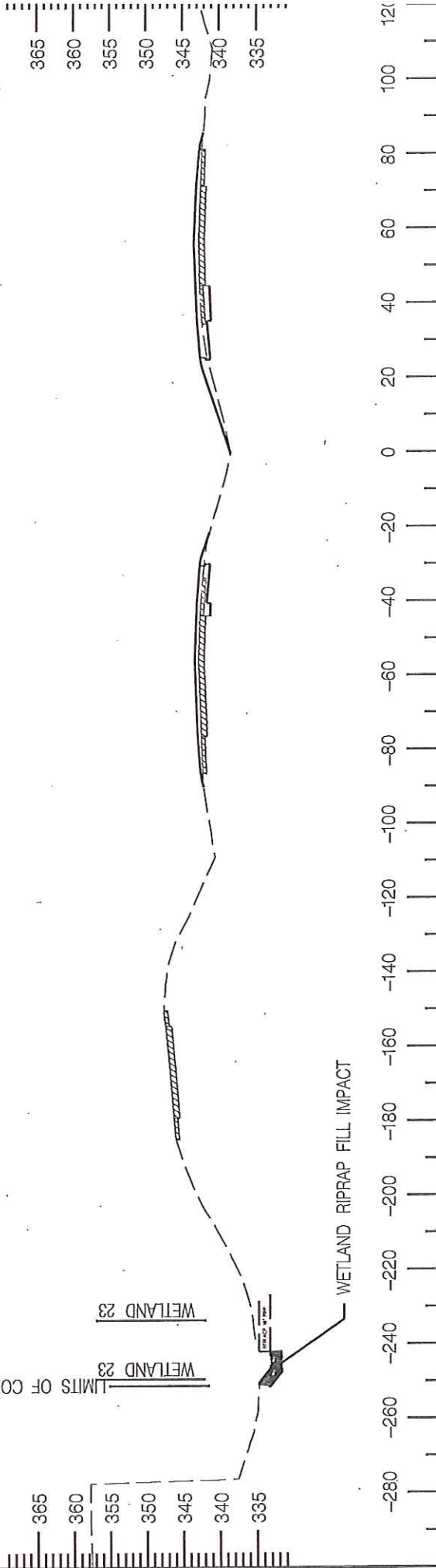

PERMITTED PLANS

SECTION L-L'

APPLICATION BY SCDOT
PROJECT ID P027002: I-77 WIDENING
AND REHABILITATION (MM15-MM27)
RICHLAND COUNTY, SC
DATE: 8/2016
SHEET: 27 OF 31
REVISION DATE:

LEGEND

--- LIMITS OF CONSTRUCTION
--- STREAM LIMITS
RIPRAP



| Activity | Hours |
|---------------------|-------|
| Reading | 120 |
| Watching TV | 180 |
| Playing video games | 240 |
| Doing homework | 60 |

BRIDGE PLAN AND PROFILE
INTERSTATE 77 NB OVER WINDSOR LAKE

APPLICATION BY SCDOT
 PROJECT ID P027002: I-77 WIDENING
 AND REHABILITATION (MM15-MM27)
 RICHLAND COUNTY, SC
 DATE: 8/2016
 SHEET: 30 OF 31
 REVISION DATE:

BRIDGE PLAN AND PROFILE
 INTERSTATE 77 NB OVER LITTLE JACKSON CREEK

PERMITTED
 PLANS

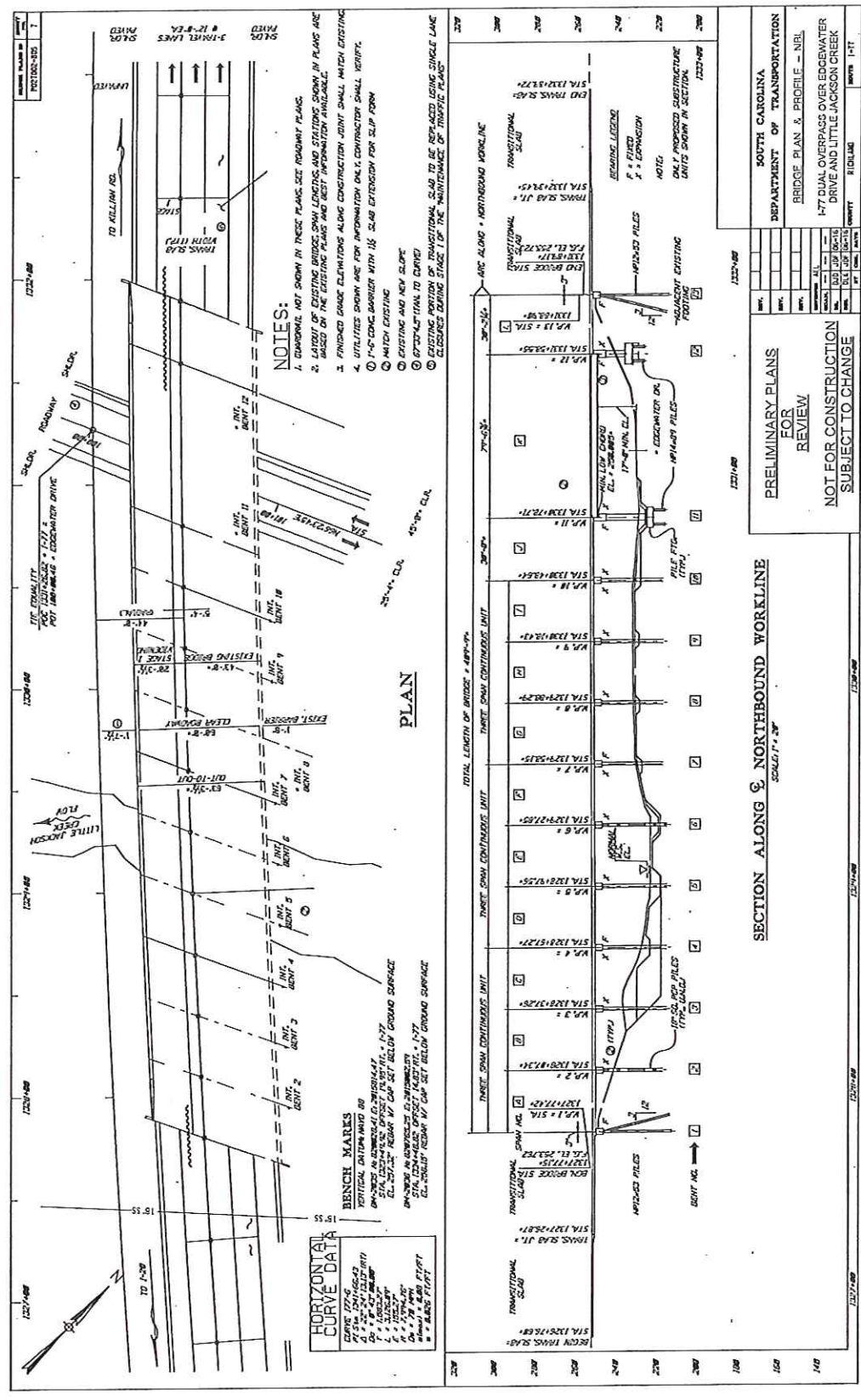

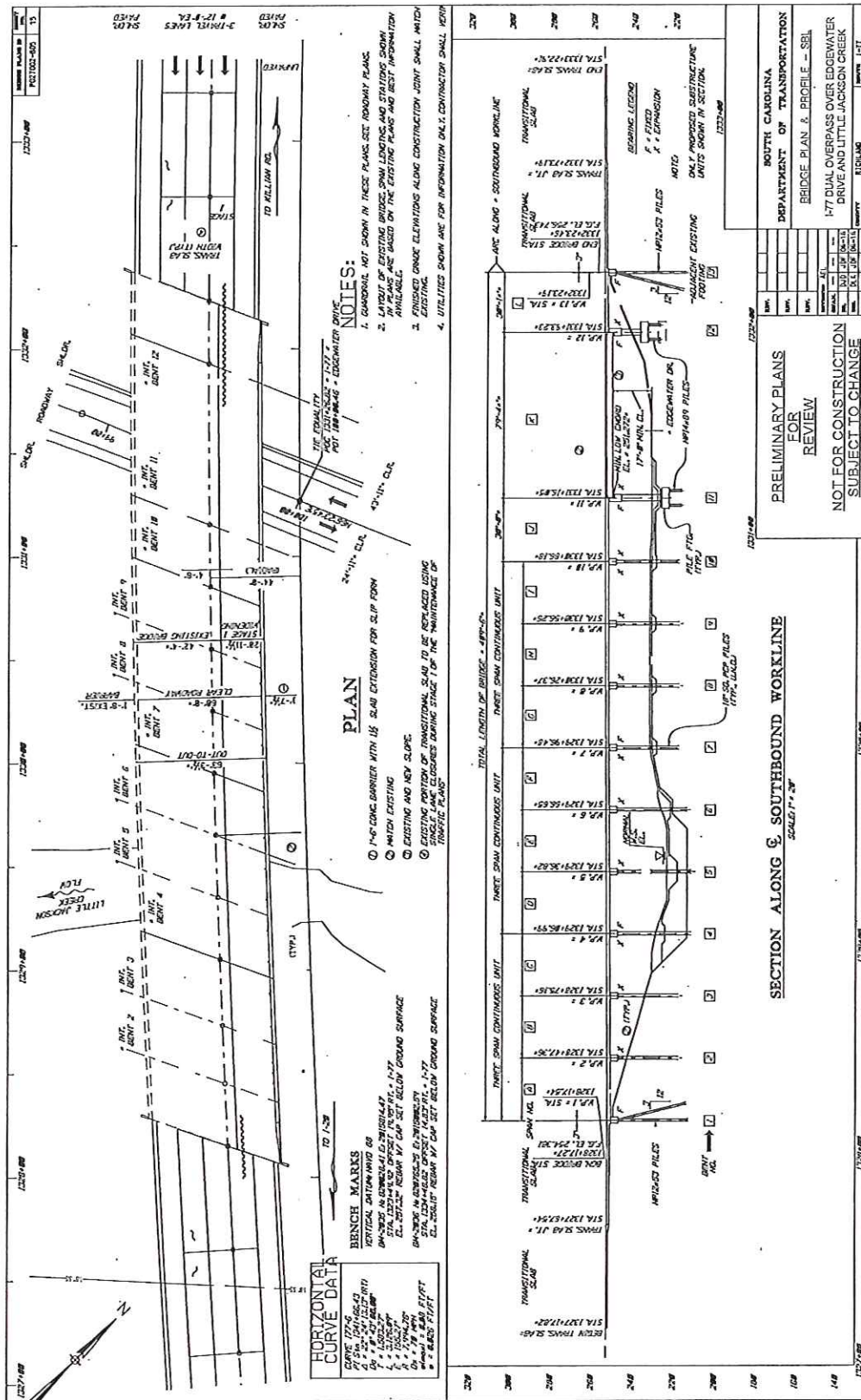

APPLICATION BY SCDOT
 PROJECT ID P027002: I-77 WIDENING
 AND REHABILITATION (MM15-MM27)
 RICHLAND COUNTY, SC
 DATE: 8/2016
 SHEET: 31 OF 31
 REVISION DATE:

BRIDGE PLAN AND PROFILE
 INTERSTATE 77 SB OVER LITTLE JACKSON CREEK

PERMITTED
 PLANS

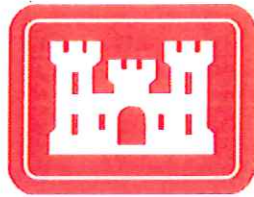

**REGIONAL GENERAL PERMITS FOR ACTIVITIES ASSOCIATED WITH
LINEAR TRANSPORTATION PROEJCTS
WITHIN WATERS OF THE US, LOCATED WITHIN THE STATE OF SOUTH
CAROLINA**

Authority: Pursuant to Section 10 of the Rivers and Harbors Act of March 3, 1899 (33 U.S.C. 403) and/or Section 404 of the Clean Water Act (33 U.S.C. 1344), the Charleston District, US Army Corps of Engineers (Corps) is authorizing the discharge of dredged and/or fill material in waters of the United States (US), including navigable waters of the US, as identified in the herein Regional General Permits, within the boundaries of the Charleston District in the State of South Carolina.

Purpose: The purpose of these Regional General Permits (RGPs) is to provide a simplified and expeditious means to authorize activities in waters of the US, including wetlands, that are similar in nature and cause only minimal individual and cumulative impacts, for specific transportation projects undertaken by the South Carolina Department of Transportation (SCDOT), within the State of South Carolina.

Description: These RGPs authorize the South Carolina Department of Transportation to conduct activities required for the improvement, expansion, or maintenance of existing linear transportation projects in waters of the US, including navigable waters of the US, provided they meet the terms and conditions described herein. Only one RGP can be utilized for each single and complete project, defined by the stated purpose of the proposed project.

| Charleston District Regional General Permits for Linear Transportation Projects | | |
|---|--|-----------------|
| RGP # | Project Purpose | Type of Project |
| SAC 2015- 1280 | Road Widening | Improvement |
| SAC 2015- 1281 | Intersection Improvements | Improvement |
| SAC 2015- 1282 | Bridge Replacements | Improvement |
| SAC 2015- 1283 | Roadway Improvements (to include shoulder improvements, addition of bike lanes, sidewalks or multi-use pathways, etc.) | Improvement |
| SAC 2015- 1284 | Roadway Maintenance Activities and Rip-Rap/ Scour Protection (roadway, causeway, bridge approaches, etc.) | Maintenance |
| SAC 2015- 1285 | Pipes and Culverts (replacements, extensions, etc.) | Maintenance |
| SAC 2015- 1286 | Cleaning and Repairing Existing Outfalls and Roadway Ditches | Maintenance |

SAC 2015- 1280 Road Widening

Activities required for the expansion of existing linear transportation projects for the purposes of widening an existing roadway for additional vehicular capacity (additional travel lanes) in waters of the US, including "navigable waters of the US", as well as the addition of bike lanes and pedestrian/ multi-use pathways associated with road widening projects. Permanent and/or temporary impacts to waters of the US, including wetlands, for a single and complete project are not to exceed 3.0 acres of total impacts which can include up to 3.0 acres of non-tidal impacts, 0.5 acre of tidal water impacts, and 300 linear feet of non-tidal, waters of the US.

Authorized activities include the placement of fill in waters of the US for suitable road base, pipe and culvert extensions, stabilization measures (i.e. rip-rap), etc. This RGP authorizes temporary structures, fills, and work necessary to expand the existing linear transportation project, in accordance with all terms and conditions listed herein to ensure the project results in only minimal impacts within the project area, as well as to adjacent properties. This RGP also authorizes the installation of utility lines (when those utility lines are being installed due to the improvement, expansion, or maintenance of existing linear transportation projects) and the associated excavation, backfill, or bedding for the utility lines, in all waters of the US, provided there is no change in pre-construction contours. A "utility line" is defined as any pipe or pipeline for the transportation of any gaseous, liquid, liquescent, or slurry substance, for any purpose, and any cable, line, or wire for the transmission for any purpose of electrical energy, telephone, and telegraph messages, and radio and television communication. The term "utility line" does not include activities that drain a water of the US, such as drainage tile or french drains.

Notification: SCDOT must submit a pre-construction notification to the Charleston District Engineer and may only commence work upon written verification from the Corps of Engineers that the project is consistent with the terms and conditions of the RGP. (See Section III. Pre-Construction Notification Requirements) (Sections 10 and 404)

SAC 2015- 1281 Intersection Improvements

Activities required for the modification of existing transportation intersections for the purposes of improving the safety and/or traffic flow of vehicles at intersections to include the addition of turn lanes, slight shifts in alignment or alterations in the configuration of roadways or lanes, etc. in waters of the US, including "navigable waters of the US". Permanent and/or temporary impacts to waters of the US, including wetlands, for a single and complete project are not to exceed 3.0 acres of total impacts, which can include up to 3.0 acres of non-tidal impacts, 0.5 acre of tidal water impacts, and 300 linear feet of non-tidal, waters of the US.

Authorized activities include the placement of fill in waters of the US for suitable road base, pipe and culvert extensions, stabilization measures (i.e. rip-rap), etc. This RGP authorizes temporary structures, fills, and work necessary to conduct construction activities, in accordance with all terms and conditions listed herein to ensure the project results in only minimal impacts within the project area, as well as to adjacent properties. This RGP also authorizes the installation of utility lines (when those utility lines are being installed due to the improvement, expansion, or maintenance of existing linear transportation projects) and the associated excavation, backfill, or bedding for the utility lines, in all waters of the US, provided there is no change in pre-construction contours. A "utility line" is defined as any pipe or pipeline for the transportation of any gaseous, liquid, liquescent, or slurry substance, for any purpose, and any cable, line, or wire for the transmission for any purpose of electrical energy, telephone, and telegraph messages, and radio and television communication. The term "utility line" does not include activities that drain a water of the US, such as drainage tile or french drains.

Notification: SCDOT must submit a pre-construction notification to the Charleston District Engineer and may only commence work upon written verification from the Corps of Engineers that the project is consistent with the terms and conditions of the RGP. (See Section III. Pre-Construction Notification Requirements) (Sections 10 and 404)

SAC 2015- 1282 Bridge Replacements

Activities required for the replacement of existing bridges in waters of the US, including "navigable waters of the US" and includes widening causeways and/or bridge abutments to allow for additional capacity (vehicular travel lanes and/or pedestrian access). This RGP includes bridge replacements on existing alignment, shifts in alignment, and includes improving existing bridges to allow for additional vehicular capacity (additional travel lanes). Permanent and/or temporary impacts to waters of the US, including wetlands, for a single and complete project are not to exceed 3.0 acres of total impacts which can include up to 3.0 acres of non-tidal impacts, 0.5 acre of tidal water impacts, and 300 linear feet of non-tidal, waters of the US.

Authorized activities include the placement of fill in waters of the US for suitable causeway, bridge approaches and/or bridge abutments, stabilization measures, (i.e. rip-rap), sheet pile walls, bulkheads, or other retaining walls, etc. This RGP authorizes temporary structures, fills, and work necessary to replace existing bridges in accordance with all terms and conditions listed herein to ensure the project results in only minimal impacts within the project area, as well as to adjacent properties. This RGP also authorizes the installation of utility lines (when those utility lines are being installed due to the improvement, expansion, or maintenance of existing linear transportation projects) and the associated excavation, backfill, or bedding for the utility lines, in all waters of the US, provided there is no change in pre-construction contours. A "utility line" is defined as any pipe or pipeline for the transportation of any gaseous, liquid, liquescent, or slurry substance, for any purpose, and any cable, line, or wire for the transmission for any purpose of electrical energy, telephone, and telegraph messages, and radio and television communication. The term "utility line" does not include activities that drain a water of the US, such as drainage tile or french drains.

For proposed bridge replacements that include shifts in alignment, it will be solely the Corps' discretion when a shift in alignment becomes such that an alternatives analysis is required (for example, a proposed alignment will adversely impact a tidal creek not currently impacted by the existing structure) and/or the proposed alignment is not considered an improvement or expansion of an existing linear transportation project, but a new alignment and as such will be evaluated for authorization via a Nationwide Permit or a Standard, Individual Permit.

Notification: SCDOT must submit a pre-construction notification to the Charleston District Engineer and may only commence work upon written verification from the Corps of Engineers that the project is consistent with the terms and conditions of the RGP. (See Section III. Pre-Construction Notification Requirements) (Sections 10 and 404)

SAC 2015- 1283 Roadway Improvements (to include shoulder improvements, addition of bike lanes, sidewalks or multi-use pathways, etc.)

Activities required for the improvements of existing roadways, for purposes other than increasing vehicular capacity (additional travel lanes), which require fill in waters of the US, including "navigable waters of the US" or where the project purpose is to improve an existing linear transportation project by the addition of bike lanes, sidewalks or multiuse pathways, shoulder improvement activities, etc. Permanent and/or temporary impacts to waters of the US, including wetlands, for a single and complete project are not to exceed 2 acres of total impacts, which can include up to 2 acres of non-tidal wetland/water impacts, 0.5 acre of tidal water impacts, and up to 300 linear feet of waters of the US.

This RGP can be used for the installation of bike lanes, sidewalks and/or multi-use pathways not associated with increasing vehicular capacity as well as shoulder improvement activities needed for safety purposes, the addition of turn lanes, the addition of guardrails, or other improvements to existing roadway shoulders.

This RGP also authorizes fill for the purposes of protecting side slopes from erosion/scour, etc., replacing or extending culverts and/or pipes, etc. This RGP also authorizes temporary structures, fills, and work necessary to conduct construction activities, in accordance with all terms and conditions listed herein to ensure the project results in only minimal impacts within the project area, as well as to adjacent properties.

Notification: SCDOT must submit a pre-construction notification to the Charleston District Engineer and may only commence work upon written verification from the Corps of Engineers that the project is consistent with the terms and conditions of the RGP. (See Section III. Pre-Construction Notification Requirements) (Sections 10 and 404)

SAC 2015- 1284 Roadway Maintenance Activities and Rip-Rap/ Scour Protection (roadway, causeway, bridge approaches, etc.)

Activities required for the protection and maintenance of existing roadway surfaces, to include existing causeways, bridge approaches, etc. which require fill in waters of the US, including "navigable waters of the US" to include the installation of rip-rap (or other stabilization materials), sheet pile walls, bulkheads, or other retaining walls, as well as fill for road shoulder rehabilitation activities. Permanent and/or temporary impacts to waters of the US, including wetlands, for a single and complete project are not to exceed 2 acres of total impacts, which can include up to 2 acres of non-tidal wetland/water impacts, 0.5 acre of tidal water impacts, and up to 200 linear feet of waters of the US.

This RGP also authorizes temporary structures, fills, and work necessary to conduct construction activities, in accordance with all terms and conditions listed herein to ensure the project results in only minimal impacts within the project area, as well as to adjacent properties.

Notification: SCDOT must submit a pre-construction notification to the Charleston District Engineer prior to commencing the activity. (See Section III. Pre-Construction Notification Requirements) (Sections 10 and 404)

SAC 2015- 1285 Pipes and Culverts (replacements, extensions, etc.)

Activities required for the improvements or replacements of existing pipes and culverts associated with existing roadway shoulders which require fill in waters of the US, including "navigable waters of the US". Permanent and/or temporary impacts to waters of the US, including wetlands, for a single and complete project are not to exceed 1 acre of total impacts which can include up to 1 acre of non-tidal wetland/water impacts, 0.5 acre of tidal water impacts, and up to 100 linear feet of waters of the US.

This RGP also authorizes the installation of rip-rap (or other erosion protection), wing walls, head walls, outfall aprons, etc. for the purposes of protecting areas around culverts and/or pipes and temporary fills associated with replacement or improvements of pipes and culverts during construction. This RGP authorizes temporary structures, fills, and work necessary to conduct construction activities, in accordance with all terms and conditions listed herein to ensure the project results in only minimal impacts within the project area, as well as to adjacent properties.

Notification: SCDOT must submit a pre-construction notification to the Charleston District Engineer prior to commencing the activity. (See Section III. Pre-Construction Notification Requirements) (Sections 10 and 404)

SAC 2015- 1286 Cleaning and Repairing Existing Structures and Roadway Ditches

Activities required for the cleaning and repairing existing structures in waters of the US and roadway ditches (determined to be waters of the US) associated with existing roadways, which require fill in waters of the US, including "navigable waters of the US". Permanent and/or temporary impacts to waters of the US, including wetlands, for a single and complete project are not to exceed 1.5 acres of total impacts, which can include up to 1.5 acres of non-tidal wetland/water impacts, 0.5 acre tidal water impacts, and up to 300 linear feet of waters of the US.

Authorized activities include modifying the existing cross-sectional configuration of currently serviceable drainage ditches constructed in waters, the installation of rip-rap (or other erosion protection) for the purposes of protecting road base and areas around culverts and/or pipes and temporary fills associated with replacement or improvements of pipes and culverts during construction. This RGP authorizes temporary structures, fills, and work necessary to conduct construction activities, in accordance with all terms and conditions listed herein to ensure the project results in only minimal impacts within the project area, as well as to adjacent properties.

Note: Maintenance of existing ditches (to include excavations of accumulated sediments back to original contours, re-shaping of side slopes, armoring or piping previously armored or piped sections within the same footprint of previously authorized work, and/or the replacement of existing control structures, where the original function is not changed and the capacity is not increased) is considered an exempt activity under Section 404(f)(1)(C) of the Clean Water Act so long as the activity is consistent with Section 404(f)(2) and 33 CFR.3234 and 40 CFR 232.3. These do not allow any discharges into a water of the US that is:

- part of an activity whose purpose is to convert an area of the waters of the US into a use to which it was not previously subject;
- where the flow or circulation of waters of the US may be impaired;
- the reach of such waters reduced;
- where the proposed discharge will result in significant discernible alterations to flow or circulation (the presumption is that flow or circulation may be impaired by such alteration).

Notification: SCDOT must submit a pre-construction notification to the Charleston District Engineer prior to commencing the activity. (See Section III. Pre-Construction Notification Requirements) (Sections 10 and 404)

I. General Conditions

1. Activities which are not specified in these Regional General Permits or which exceed their limitations will require authorization under a Department of the Army Standard, Individual Permit or Nationwide Permit authorization from the Charleston District, US Army Corps of Engineers. The District Engineer may also require authorization under a Department of the Army Standard, Individual Permit on a case-by-case basis if it is determined that authorization under a Regional General Permit might be contrary to the public interest.
2. This General Permit does not authorize the interference with any existing or proposed Federal project and SCDOT will not be entitled to compensation for damages or injury to the structures or work authorized herein which may be caused by or result from existing or future operations undertaken by the US in the public interest.
3. These Regional General Permits do not convey any property rights, either in real estate or material, or any exclusive privileges; and do not authorize any injury to property or invasion of rights or any infringement of Federal, State, or local laws or regulations, nor does it obviate the requirement to obtain other Federal, State, local assent or to comply with any applicable standards required by ordinance for the activities authorized herein. Other Federal, State, or local agencies are not limited by this document and may impose more stringent requirements than those stated herein as they see fit.
4. SCDOT shall allow the District Engineer or his authorized representative(s) to make periodic inspections at any time deemed necessary in order to assure that the activity being performed under authority of these permits are in accordance with the terms and conditions prescribed herein. The Charleston District reserves the right to require post-construction engineering drawings and/or surveys of any work authorized by these Regional General Permits, as deemed necessary.
5. Upon receipt of a notice from the District Engineer for failure to comply with the terms, conditions, or standards of any given Regional General Permit, SCDOT must, within 60 days, without expense to the US, and in such manner as directed by the District Engineer or his authorized representative(s), effect compliance with the terms, conditions, and standards or remove the previously authorized structure/fill.
6. All activities identified and authorized herein shall be consistent with the terms and conditions of these Regional General Permits; any variance not specifically identified and authorized herein shall constitute a violation of the terms and conditions of these permits which may result in the modification, suspension, or revocation of the authorization, as set forth below and in the institution of such legal proceedings as the US Government may consider appropriate.

Authorization of a specific work or structure authorized herein may be summarily suspended in whole or in part upon a finding by the District Engineer that immediate suspension would be in the general public interest or there has been a violation of any terms and conditions of this permit. Such suspension shall be effective upon receipt by SCDOT of a written notice thereof, which shall indicate:

- (i.) The extent of the suspension;
- (ii.) The reasons for this action;
- (iii.) Any corrective or preventative measures to be taken by SCDOT which are deemed necessary by the District Engineer to abate imminent hazards to the general public interest.

SCDOT shall take immediate action to comply with the provisions of this notice. Within ten (10) days following the receipt of this notice of suspension, SCDOT may request a meeting with the District Engineer or a public hearing to present information relevant to a decision whether their permit should be reinstated, modified, or revoked. If a public hearing is requested it shall be conducted pursuant to procedures prescribed by the Chief of Engineers. After completion of the public hearing or within a reasonable time after issuance of the suspension notice to SCDOT if no hearing is requested, the authorization of the specific work or structure will be reinstated, modified, or revoked. Any modification, suspension, or revocation of authorization under these Regional General Permits shall not be the basis for any claim for damages against the US.

7. As determined by the District Engineer, or his designee, there will be no unreasonable interference with navigation or the right of the public to riparian access by the existence or use of activities authorized by these Regional General Permits.
 - a. No authorized activity may cause more than a minimal adverse effect on navigation.
 - b. SCDOT understands and agrees that if future operations by the US require the removal, relocation, or other alteration of the structure or work herein authorized, or if, in the opinion of the Secretary of the Army or his/her authorized representative, said structure or work shall cause unreasonable obstruction to the free navigation of the navigable waters, SCDOT will be required, upon due notice from the Charleston District, to remove, relocate, or alter the structural work or obstructions caused thereby, without expense to the US. No claim shall be made against the US on account of any such removal or alteration.
8. The Charleston District may impose other special conditions on a project authorized pursuant to these Regional General Permits that are determined necessary to minimize adverse navigational and/or environmental effects or based on any other factor of the public interest. Failure to comply with all conditions of the authorization, including additional special conditions, constitutes a permit violation and may subject SCDOT, or his/her contractor, to criminal, civil, or administrative penalties and/or restoration.
9. Authorization under any of the Regional General Permits does not obviate the need to obtain other Federal, state or local authorizations required by law or to comply with all Federal, state, or local laws.
10. SCDOT will ensure that a copy of this Regional General Permit document, the accompanying authorization letter and all approved permit drawings are at the work site at all times. These copies must be made available to any regulatory representative upon request. Although SCDOT may assign various aspects of the work to different contractors or sub-contractors, all contractors and sub-contractors shall be expected to comply with all conditions of the Regional General Permits.

II. Special Conditions

The following Special Conditions are applicable to ALL the Regional General Permits (RGP) issued to SC Department of Transportation described in this document. This RGP contains certain limitations intended to protect the environment including natural and cultural resources. However, conformance with the conditions contained in the permit does not necessarily guarantee authorization. In cases

where the District Engineer, or his designee, considers it necessary, a Standard, Individual Department of the Army permit will be required.

1. Water quality.

- a. All activities authorized by these Regional General Permits that involve the discharge of dredged or fill material in waters of the US will be consistent with applicable water quality standards, effluent limitations, and standards of performance, prohibitions, pre-treatment standards and management practices established pursuant to the Clean Water Act (33 U.S.C. 1344) and applicable State and local law.
- b. SCDOT must make every reasonable effort to conduct the work authorized herein in a manner to ensure that there is no more than a minimal adverse effect on water quality.
- c. For projects potentially impacting impaired waters, Outstanding Resource Water (ORW), shellfish harvesting waters and other sensitive waters, the SCDOT must implement best management practices and post construction stormwater treatment to provide a reasonable assurance that the proposed project will not contribute to impairments or degrade water quality. A stormwater management plan must be submitted to SCDHEC in accordance with requirements of the SCDOT MS4 NPDES Stormwater Permit.
- d. No activity may use unsuitable material (e.g. trash, debris, car bodies, asphalt, etc.). Material used for construction or discharged must be free from toxic pollutants in toxic amounts (see Section 307 of the Clean Water Act).

2. Historic properties.

- a. Applicant must submit a statement to the Corps regarding the authorized activity's potential to cause effects to any historic properties (i.e. any prehistoric or historic district, site, building, structure, or object) listed in, or determined to be eligible for listing on, the National Register of Historic Places, including previously unidentified properties. The statement must say which historic properties may be affected by the proposed work or include a vicinity map indicating the location of the historic properties or the potential for the presence of historic properties. Assistance regarding information on the location or potential for the presence of historic resources can be sought from the South Carolina Department of Archives and History and the National Register of Historic Places. Where SCDOT has identified historic properties which the proposed activity may have the potential to cause effects and so notified the Charleston District, the applicant shall not begin the activity until notified by the Charleston District that the activity has no potential to cause effects or that consultation under Section 106 of the NHPA has been completed.
- b. Prospective permittee should be aware that Section 110(k) of the NHPA (16 U.S.C. § 470(h)-2(k)) prevents the Corps from granting a permit or other assistance to an applicant who, with intent to avoid the requirements of Section 106 of the NHPA, has intentionally significantly adversely affected a historic property to which the permit would relate, or having legal power to prevent it, allowed such significant adverse effect to occur, unless the Corps, after consultation with the Advisory Council on Historic Preservation (ACHP), determines that circumstances justify granting such assistance despite the adverse effects created or permitted by the applicant. If circumstances justify granting the assistance, the Charleston District is required to notify the ACHP and provide documentation specifying the circumstances, explaining the degree of damage to the integrity of any historic properties affected, and proposed mitigation. This documentation must include any views obtained from the applicant, State Historic Preservation Officer, Tribal Historic Preservation Officer,

appropriate Indian tribes if the undertaking occurs on or affects historic properties on tribal lands or affects properties of interest to those tribes, and other parties known to have legitimate interest in the impacts to the permitted activity on historic properties. If SCDOT, during construction or work authorized herein, encounters a previously unidentified archaeological or other cultural resource, he/she must immediately stop work and notify the Charleston District of what has been found. Coordination with the South Carolina Department of Historic Resources will commence and SCDOT will subsequently be advised when he/she may recommence work.

3. Endangered species.
 - a. No activity is authorized which:
 - (i) Is likely to jeopardize the continued existence of any threatened or endangered species or threatened species, or species proposed for such designation, as identified under the Endangered Species Act of 1973, or which will result in the destruction or adverse modification of designated critical habitat of such species;
 - (ii) "May affect" a listed species or critical habitat, unless Section 7 (Federal Endangered Species Act) consultation addressing the effects of the proposed activity has been completed.
 - (iii) Involves the "take" of a threatened or endangered species as defined under the ESA without separate authorization (e.g., a Biological Opinion with "incidental take" provisions) from the U.S. Fish and Wildlife Service or the National Marine Fisheries Service.
 - b. Applicants shall include, in their permit applications, information regarding the presence of any federally listed threatened or endangered species or designated critical habitat in the vicinity of the project site that might be affected by the proposed work.
4. Essential Fish Habitat.
 - a. The Magnuson-Stevens Fishery Conservation and Management Act (MSFCMA), as amended by the Sustainable Fisheries Act of 1996 (Public Law 104-297; 11 October 1996), requires all Federal agencies to consult with the National Marine Fisheries Services (NMFS) regarding any of their actions authorized, funded, or undertaken or proposed to be authorized, funded, or undertaken that may adversely affect Essential Fish Habitat (EFH). SCDOT must notify the District Engineer if the activity authorized by this General Permit may adversely affect EFH including indirect affects to EFH from actions outside the EFH. The activity is not authorized until the District Engineer determines that the requirements of the Magnuson-Stevens Fisheries Conservation and Management Act have been satisfied.
 - b. Any projects that involve activities, including structures, excavation, discharges of dredged or fill material, etc. that are proposed in tidal waters require early coordination with the Charleston Office of the NMFS Habitat Conservation Division located at 219 Fort Johnson Road, Charleston SC 29412. An EFH assessment and copies of all coordination must be provided as described in Section III. (3) SCDOT cannot begin work until written approval is received from the Corps.
5. Anadromous Fish. Activities authorized under these RGP's must be avoided to the maximum extent practicable during the months of February, March, April, May and June in waters where anadromous fish spawn or migrate. Activities that result in the physical destruction (e.g.,

excavate, fill, or smother downstream by substantial turbidity) of a spawning area are not authorized under these RGPs.

6. Migratory Bird Breeding Areas. Activities in waters of the US that serve as breeding areas for migratory birds must be avoided to the maximum extent practicable.
7. Floodplains. SCDOT is advised that development activities in a 100-year floodplain, as designated in the Federal Emergency Management Agency's (FEMA) Flood Insurance Study Data, are subject to the floodplain management regulations of the National Flood Insurance Program [(NFIP) (44 CFR)]. The NFIP further prohibits any development within a designated floodway, including placement of fill that results in any increase in base flood elevations. SCDOT must also comply with the FEMA-U.S. Federal Highway Agreement on Floodplain Management. A statement ensuring compliance with applicable regulations must be included in the Pre-Construction Notification. See Section III (3).
8. SCDOT must coordinate with the appropriate state and/or federal agency when a project represents an intrusion into Outstanding Resource Waters, Wild and Scenic Rivers, Trout Streams (as defined by State Regulations 61-68 and 61-69), Wildlife Management Areas and National Estuarine Sanctuaries, Designated Shellfish Grounds, State Heritage Trust Preserves, State Parks, National Wildlife Refuge, or protected lands (previous mitigation/ restoration area). Detailed project information impacting these sensitive areas shall be presented at an interagency coordination meeting (or provided directly to appropriate agencies) during the early phases of development. The notification/application, as described in Section III.(3)(k) shall contain a summary and/or copy of the coordination that occurred.
9. Minimal impacts. SCDOT must make every reasonable effort to conduct the work authorized herein in a manner so as to avoid and minimize any adverse impact to fish, wildlife, and other environmental resources.
 - a. No activity may substantially disrupt the necessary life-cycle movements of those species of aquatic life indigenous to the water body, including those species that normally migrate through the area. Pipes or culverts placed in streams and wetlands must be appropriately sized and installed in a manner that prevents erosion and allows adequate passage of the aquatic community and provide unimpeded flow of flood waters. Culverts and pipes placed in tidal waters must be sized and positioned to maintain fish passage and allow for unimpeded tidal flow.
 - b. Activities, including structures and work in navigable waters of the US or discharges of dredged or fill material, must avoid and minimize potential impacts to shellfish resources to the greatest extent possible. Activities should occur in areas with the least amount of shellfish or in areas void of shellfish resources, if possible. Direct encroachment on any natural shellfish beds should be avoided.
 - c. All activities or structures proposed in waters of the US must be designed to maintain preconstruction downstream flow conditions (e.g., location, capacity, and flow rates) in freshwaters. For activities in tidal waters, preconstruction bi-directional flow conditions must be maintained or improved. Furthermore, the activity must not permanently restrict or impede the passage of normal or expected high flows and the structure or discharge of dredged or fill material must withstand expected high flows. The activity must, to the maximum extent practicable, provide for retaining excess flows from the site, provide for maintaining surface flow rates from the site similar to pre-construction conditions, and provide for not increasing

water flows from the project site, relocating water, or redirecting water flow beyond preconstruction conditions. Stream channelizing will be reduced to the minimal amount necessary, and the activity must, to the maximum extent practicable, reduce adverse effects such as flooding or erosion downstream and upstream of the project site, unless the activity is part of a larger system designed to manage water flows. Tidal waters should not be channelized. In most cases, it will not be a requirement to conduct detailed studies and monitoring of water flow.

- d. Appropriate measures must be taken to maintain normal downstream flows and minimize flooding to the maximum extent practicable, when temporary structures, work, and discharges, including cofferdams, are necessary for construction activities, or dewatering of construction sites. Temporary fills must consist of materials, and be placed in a manner, that will not be eroded by expected high flows. Temporary fills must be removed in their entirety and the affected areas returned to pre-construction elevations. The areas affected by temporary fills must be re-vegetated, as appropriate.
- e. Stream crossings are required to accommodate bankfull flows by maintaining the existing bankfull channel cross sectional area. Flows that exceed bankfull flow must be accommodated by placement of additional culverts above the bankfull elevation.
- f. Appropriate soil erosion and sediment controls must be used and maintained in effective operating condition during construction, and all exposed soil and other fills, as well as any work below the ordinary high water mark or high tide line, must be permanently stabilized at the earliest practicable date. SCDOT is encouraged to perform work within waters of the US during periods of low-flow or no-flow conditions.
- g. Prior to the beginning of any construction activities, appropriate erosion control measures, such as silt fences, silt barriers or other suitable devices, must be placed between the construction area and affected waterways (including wetlands); and maintained in a functioning capacity until the area is permanently stabilized.
- h. All steps necessary must be taken to prevent oil, tar, trash, debris and other pollutants from entering adjacent wetlands and/or waterways. A spill response plan and all related spill materials should be on-site during all phases of construction.
- i. Construction access areas must be clearly identified in the permit application or, construction access must consist of minimal clearing for installation of elevated working platform(s), timber mat(s) or barge(s). Impacts will be temporary and minor in nature. All impacts for construction access count towards the thresholds allowed under these Regional General Permits.
- j. Construction activities must avoid encroachment into any waters of the US not designated as impact areas.
- k. Side slopes must be designed and constructed to minimize impacts to aquatic resources to the maximum extent practicable.
- l. SCDOT must ensure that the wetland boundaries are clearly identified (by flagging, fencing, or other means of identification) for the construction contractor.

- m. Once initiated, projects must be carried to completion in an expeditious manner in order to minimize the period of disturbance and upon completion, all disturbed areas must be permanently stabilized with vegetative cover and/or rip-rap, as appropriate.
10. Mitigation. SCDOT will submit a mitigation plan in accordance with the 2008 Mitigation Rule and the *2010 SAC Guidelines for Preparing a Mitigation Plan* (or the current documents superseding either of these two documents).
- a. The activity must be designed and constructed to avoid and minimize adverse effects, both temporary and permanent, to waters of the US to the maximum extent practicable at the project site.
 - b. Mitigation in all forms (avoiding, minimizing, rectifying, reducing, or compensating for resources losses) will be required to the extent necessary to ensure that the adverse effects to the aquatic environment are minimal.
 - c. Compensatory mitigation will be required in accordance with the *2010 SAC Guidelines for Preparing a Mitigation Plan* (or the current SAC Guidance/Proceedures superseding this document), for all wetland losses that exceed 1/10-acre unless the District Engineer determines in writing that either some other form of mitigation would be more environmentally appropriate or the adverse effects of the proposed activity are minimal, and provides a project-specific waiver of this requirement. For wetland losses of 1/10-acre or less, the District Engineer may determine on a case by case basis that compensatory mitigation is required to ensure that the activity results in minimal adverse effects on the aquatic environment.
 - d. These Regional General Permits allow for SCDOT to perform stream and/or wetland restoration activities associated with a project-specific mitigation plan approved and authorized by the Corps, provided all work in waters of the US is included in the pre-construction notification. SCDOT will not have to submit for a separate permit for activities in waters of the U.S. associated with the restoration of former waters, the enhancement of degraded tidal and non-tidal wetlands and riparian areas, and the restoration and enhancement of tidal/ non-tidal streams and tidal/ non-tidal open waters if the work is part of an approved mitigation plan. These activities may include installation of ditch plugs, the placement of in-stream habitat structures, modifications of stream bed and/or banks to restore or create meanders, or the creation of riffle and pool stream structures.
11. Single and complete project. All projects authorized under a Regional General Permit must be a single and complete project and meet the requirements for independent utility. A project that is determined to be single and complete will not be segmented or "piece meal" in order to qualify for multiple Regional General Permits.

III. Pre-Construction Notification Requirements

- 1. The applicant shall submit a complete Pre-Construction Notification (PCN) package to the Corps, requesting verification that a proposed project is authorized under the terms and conditions of one of the Regional General Permits described herein. The PCN shall not be deemed complete until

either (1) a Wetland Determination is approved by the Corps or (2) the Corps has verified that the depiction of waters of the US is accurate.

2. The applicant shall submit a PCN Form (Enclosure 1). This form is to assist the applicant in submitting complete and proper information. Please note that this is not an exhaustive list of information that may be required as each project has unique components; more information may be required to complete a PCN Form for any given project. All information provided in the form shall be succinct, accurate, and project specific.
3. Contents of a Complete PCN:
 - a. A complete Joint Federal and State Application Form;
 - b. Completed PCN Form;
 - c. Wetland Determination (see PCN Form for additional details);
 - d. A statement as to whether the Federal Highway Administration has completed a NEPA document for the proposed project. If so, a copy should be provided;
 - e. Proposed Project Plans to include a location map, plan view and cross sectional diagrams depicting the existing transportation facility and the proposed activities. The proposed plans should depict the entire project with specific detail provided for impacts to waters of the US. Cross sectional diagrams should be provided for every typical wetland fill and all open water crossings. All proposed bridge replacement projects should also include bridge profile drawings. Appropriate dimensions of the project as well as acreages or linear feet of impacts should be depicted clearly on the plans, as well as a project specific title block.
 - f. A detailed discussion of how impacts were avoided and minimized from the initial phase of the project plans to the project plan that is currently being proposed.
 - g. Information pertaining to the presence and/or the projects potential affects to historic properties (to assist in complying with Section 106 of the [National Historic Preservation Act of 1966](#)). Copies of any coordination with SHPO should be provided, to include material submitted to SHPO for review, as well as response(s) received. Copies of screening forms and supplemental materials should also be provided if the project was reviewed under an existing Section 106 Programmatic Agreement with SHPO;
 - h. Biological Assessment Report to include an assessment of potential impacts to Federally Threatened and Endangered Species and copies of habitat surveys. Copies of any coordination with USFWS and/or NMFS should be provided, to include material submitted to USFWS and/or NMFS for review, as well as the response(s) received;
 - i. Essential Fish Habitat (EFH) Assessment or statement stating why no EFH Assessment was conducted. Copies of any coordination with NMFS should be provided, to include material submitted to NMFS for review, as well as the response(s) received;
 - j. Mitigation Plan (to comply with the 2008 Mitigation Rule and the 2010 SAC Guidelines for Preparing a Mitigation Plan or the current documents superseding either of these two documents);

- k. Documentation of coordination that occurred with resource agencies, as required by II. Special Condition 6.

4. Pre-Construction Notification Timing.

- a. For projects considered Improvement Projects, specifically SAC 2015-1280, SAC 2015-1281, SAC 2015-1282, and SAC 2015-1283 (Improvement Projects): The applicant shall not begin work on a proposed project until receipt of written verification from the Corps that the activity may proceed under one of the Regional General Permits described herein.
- b. For projects considered Maintenance Projects, specifically (Maintenance Projects), SAC 2015-1284, SAC 2015-1285, and SAC 2015-1286: If the Corps has not requested additional information, nor approved a request for authorization for one of the RGPs, the applicant may commence work 45 calendar days past the date from the District Engineer's receipt of the complete PCN.

Note: It is SCDOT's responsibility (through FHWA, as appropriate) to determine and document that the project will have "no effect" on listed species or that consultation required under Section 7 of the Endangered Species Act (see 33 CFR 330.4(f)) is complete; **and** that the project has "no potential to cause effects" on historic properties or that consultation required under Section 106 of the National Historic Preservation Act (see 33 CFR 330.4(g)) is complete **and** that the project will cause "no adverse effects" to EFH, or that consultation under the Magnuson-Stevens Act is complete. If the PCN is considered incomplete due to potential impacts to federally threatened or endangered species and/or critical habitat (Federal Endangered Species Act), historic properties (Section 106 of the [National Historic Preservation Act of 1966](#), or essential fish habitat (EFH), SCDOT cannot begin the activity until receiving written notification from the Corps that consultation requirements have been met.

In addition, if the District Engineer notifies SCDOT in writing (within 45 calendar days of receipt of a PCN) that an individual permit is required, SCDOT cannot begin the activity in waters of the US until an individual permit has been obtained.

IV. PROHIBITED ACTIVITIES:

All work that exceeds the terms and conditions specified herein is prohibited unless an Individual or Nationwide Department of the Army Permit has been obtained from the Corps of Engineers. All work for purposes other than those specified herein is expressly not authorized by this document.

V. PENALTIES FOR VIOLATIONS:

Authorization obtained under these Regional General Permits limits the size, length and use of structures. Any deviation from the specifications, or other terms or conditions of the General Permit shall constitute a violation of Section 10 of the Rivers and Harbors Act of 1899 and/or Section 404 of the Clean Water Act, and may result in the District Engineer seeking judicial relief to have SCDOT remove the structure or work and/or restore the project area to its former condition, as well as the imposition of penalties as provided by law.

VI. LIMITS OF FEDERAL LIABILITY:

In issuing this permit, the Federal Government does not assume any liability for the following:

- a. Damages to the permitted project or uses thereof as a result of other permitted or unpermitted activities or from natural causes.
- b. Damages to the permitted project or uses thereof as a result of current or future activities undertaken by or on behalf of the US in the public interest.
- c. Damages to persons, property, or to other permitted or unpermitted activities or structures caused by the activity authorized by this permit.
- d. Design or construction deficiencies associated with the permitted work.
- e. Damage claims associated with any future modification, suspension, or revocation of this permit.

VI. REVOCATION OF THE GENERAL PERMIT:

This permit may be revoked by issuance of a public notice at any time the District Engineer determines that the cumulative effects of the activities authorized herein have an adverse effect on the public interest. Following such revocation, any future activities in areas covered by these General Permits will be processed as Individual or Nationwide Permits.

VII. DURATION OF THE GENERAL PERMIT.

This General Permit will cover activities started within five (5) years and completed within six (6) years after the date of issuance, unless these RGPs are revoked in the interim. At the end of the first year and every succeeding year, the Corps of Engineers will review activities authorized by these Regional General Permits to determine if significant cumulative impacts have resulted. If the District Engineer determines revocation of this permit, in whole or in part, may be in order due to cumulative impacts, a public notice of the intention will be issued and after a review of all additional data submitted, action will be taken to amend, modify or revoke this permit as appropriate. Revocation of the General Permit will not affect the work that had been authorized when the General Permit was in effect if such work is in accordance with the provisions contained herein.

This permit becomes effective when the Federal official, designated to act for the Secretary of the Army, has signed below.

This permit shall become effective on the date of the District Engineer's signature,

BY AUTHORITY OF THE SECRETARY OF THE ARMY:

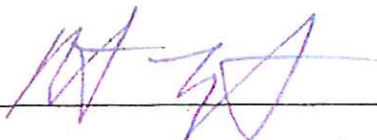

Matthew W. Luzzatto, P.E., PMP
Lieutenant Colonel, U.S. Army
Commander and District Engineer

JUL 20 2018

Date

Pre-Construction Notification Form for SCDOT GP SAC 2015-1280, SAC 2015-1281, SAC 2015-1282, SAC 2015-1283 SAC 2015-1284, SAC 2015-1285, and SAC 2015-1286

Project Name _____ SAC # _____
County: _____

The following must be completed with each RGP Request. There should be a box checked for each numbered item with all blanks filled in with appropriate information. If a blank is not applicable, state NA. The PCN will not be considered complete unless an answer is provided for every numbered item and the appropriate information listed for each item is enclosed.

1. ☐ What is the purpose of the project? _____

2. ☐ Completed Joint Federal and State Application Form (enclosed). If additional space is needed, additional sheets may be attached, referencing specific sections of the Joint Application, as appropriate. # 41 is not required for RGP Applications.
3. Wetland Determination. (See Page 1 of the RGP "Type of Project").
☐ For Improvement Projects, the PCN packet must contain a copy of the Wetland Determination Letter and copy of the referenced JD map, drawing, or plat.
SAC _____ dated _____ is enclosed.

☐ For Maintenance Projects, the PCN packet must contain a (1) Signed Jurisdictional Determination Request form (Approximate-Preliminary), to include information consistent with Charleston District's requirements for delineations and jurisdictional determination submittals (see <http://www.sac.usace.army.mil/missions/regulatory.aspx>).
4. ☐ Federal Highway Administration has completed a NEPA document entitled _____
_____ and dated _____.
A copy of the NEPA document is included in PCN packet.

☐ Federal Highway Administration has not completed a NEPA document because ☐ there is no federal funding associated with this project, or ☐ it is incomplete at the time of DA submittal.
5. ☐ Proposed Plans (enclosed). A location map, plan view, and cross sectional diagram should be provided. For bridge replacement projects, a bridge profile is needed.
6. ☐ Impacts. Total Impacts to Wetlands are _____ acre(s) and/or _____ linear feet of waters of the US. This includes _____ acre(s) of impacts to tidally-influenced waters/ wetlands.
7. ☐ Provide a detailed discussion of how impacts were avoided and minimized from the initial phase of the project plans to the project plan that is currently being proposed.

8. Historic Properties. See Section II (2).

Note: Attach additional sheets, if needed.

☐ There are no Section 106 Properties that will be affected by the proposed project (no potential to cause effects).

☐ There are Section 106 Properties in the area but they will not be impacted by the proposed project. Provide copies of all correspondence with SHPO. Explain: _____

9. Threatened and Endangered Species. See Section II (3).

☐ There will be no effect on any federally threatened or endangered species or critical habitat. A Biological Assessment is included.

☐ The proposed project is not likely to adversely affect (list appropriate federally threatened or endangered species) _____

The Biological Assessment and copies of all correspondence with USFWS and/or NMFS is included.

10. ☐ There will be no impacts to EFH.

☐ The project will impact _____ acres of EFH. The EFH Assessment and copies of all correspondence with NMFS is enclosed. Any NMFS Conservation Recommendations must be clearly addressed and incorporated into the project in order for the PCN to be considered complete.

11. Floodplain Management Statement: Provide a statement that the proposed project complies with any applicable Federal Emergency Management Agency (FEMA) Flood Insurance Program regulations, and/or any State, County, or local regulations and whether the proposed project may cause increases in the base flood elevations to adjacent properties. _____

12. ☐ In order to compensate for the impacts to WOTUS, the following is proposed as compensatory mitigation. Compensatory Mitigation Worksheets are enclosed. _____

Prepared By: _____
Consultant or SCDOT Representative Name (Printed) and Signature

Date: _____

Reviewed By: _____
SCDOT Representative Name (Printed) and Signature

Date: _____

Note: Attach additional sheets, if needed.



Catherine E. Helgel, Director

Promoting and protecting the health of the public and the environment

July 7, 2016

Corps of Engineers
69 A Hagood Ave
Charleston SC 29403

Re: Certification in Accordance with Section 401 of the Clean Water Act, as amended and the Coastal Zone Management Program (48-39-10 et. seq., and 15 CFR 93)

Corps of Engineers

Approval of Regional General Permits that provide a simplified and expeditious means to authorize specific activities for existing SCDOT roadways that cause only minimal individual and cumulative impacts in waters including wetlands.

Waters within the boundaries of South Carolina

P/N SAC 2015-1280-1286

Dear Sir or Madam:

The South Carolina Department of Health and Environmental Control (DHEC) has reviewed plans for this project and determined there is a reasonable assurance that the proposed project will be conducted in a manner consistent with the Certification requirements of Section 401 of the Federal Clean Water Act, as amended, and the Coastal Zone Management Act (48-39-10 et. seq., and 15 CFR 93).

In accordance with the provisions of Section 401, we certify that this project, subject to the indicated conditions, is consistent with applicable provisions of 303 of the Federal Clean Water Act, as amended. We also certify that there are no applicable effluent limitations under Sections 301(b) and 302, and that there are no applicable standards under Sections 306 and 307.

This certification is subject to the following conditions:

1. Access to bridge construction sites must be attained from highland, from the portion of the bridge already completed (end on end construction) or from temporary work trestles, floating barges or mats instead of barge canals or causeways.
2. Bridge scupper drains must not be placed directly over the waterbody, if practical. Additionally, drains must be placed at an appropriate distance apart as design criteria allow.
3. Proof of purchase or debiting of any required mitigation credits must be submitted to OCRM prior to beginning work.

4. In the event that any historic or cultural resources and/or archaeological materials are found during the course of work, the applicant must notify the State Historic Preservation Office and the South Carolina Institute of Archaeology and Anthropology. Historic or cultural resources consist of those sites listed in the National Register of Historic Places and those sites that are eligible for the National Register. Archaeological materials consist of any items, fifty years old or older, which were made or used by man. These items include, but are not limited to, stone, metal and glass objects, and human skeletal materials.

DHEC reserves the right to impose additional conditions on this Certification to respond to unforeseen, specific problems that might arise and to take any enforcement action necessary to ensure compliance with State water quality standards.

Sincerely,

Wade Cantrell for Heather Preston

Heather Preston, Director
Division of Water Quality
Bureau of Water

cc: U.S. Army Corps of Engineers,
Charleston District Office
SC DHEC, Statewide-All EQC District Offices
Jennifer Hughes
OCRM

Permit Number: _____

Name of Permittee: _____

Date of Issuance: _____

Upon completion of the activity authorized by this permit and any mitigation required by the permit, sign this certification and return it to the following address:

U.S. Army Corps of Engineers
Regulatory Division
69A Hagood Avenue
Charleston, South Carolina 29403-5107

Please note that your permitted activity is subject to a compliance inspection by an U.S. Army Corps of Engineers representative. If you fail to comply with this permit you are subject to permit suspension, modification, or revocation.

=====

I hereby certify that the work authorized by the above referenced permit has been completed in accordance with the terms and conditions of the said permit, and required mitigation was completed in accordance with the permit conditions.

Signature of Permittee