

INDEX OF SHEETS

1. Title Sheet
2. Bridge Plan & Profile (1)
3. Bridge Plan & Profile (2)
4. Bridge Plan & Profile (3)
5. Bridge Plan & Profile (4)
6. Bridge Typical Section



South Carolina Department of Transportation

PROPOSED PLANS
FOR
BEAUFORT COUNTY
PROJECT ID P026862
US 21 (SEA ISLAND PARKWAY)
REPLACE BRIDGE OVER
HARBOR RIVER

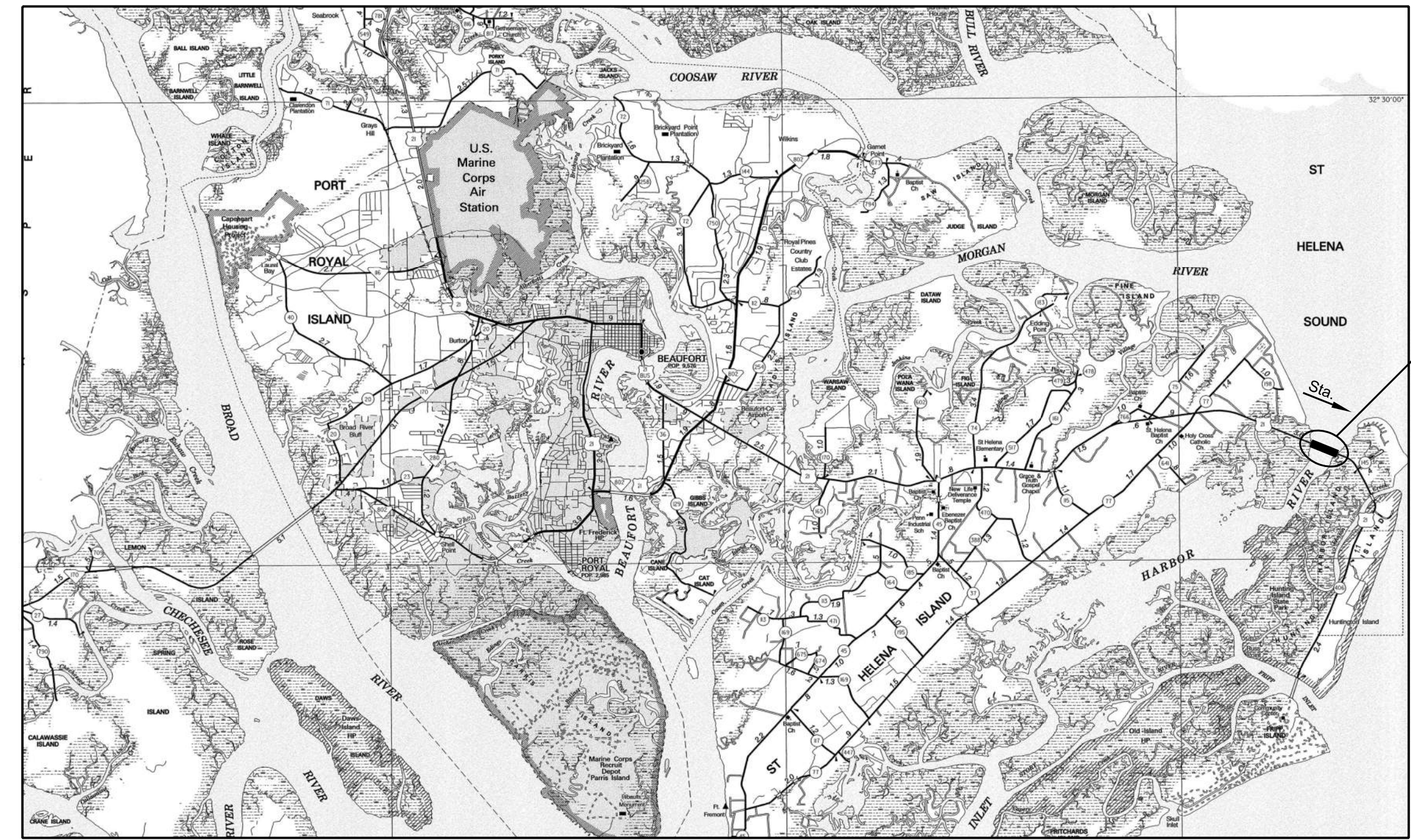

SITE LOCATION
 CONSTRUCT 3062'-0"
 (P.S. CONCRETE BEAM)
 BRIDGE FROM STA. 68+54.00
 TO STA. 104+56.00 ALONG CL
 US 21 RELOC.

Approximate Location of Bridge is	
Latitude	32° - 24' - 16"
Longitude	80° - 27' - 13"

3 DAYS BEFORE DIGGING IN
 SOUTH CAROLINA
CALL 811
 SOUTH CAROLINA 811 (SC811)
 WWW.SC811.COM
 ALL UTILITIES MAY NOT BE A MEMBER OF SC811

ASSET ID 925

TRAFFIC DATA

_____ ADT _____ V.P.D.

_____ ADT _____ V.P.D.

TRUCKS _____%

CONCEPTUAL PLANS
DO NOT USE FOR CONSTRUCTION

NET LENGTH OF ROADWAY	0.619 MILES
NET LENGTH OF BRIDGES	0.682 MILES
NET LENGTH OF PROJECT	1.301 MILES
LENGTH OF EXCEPTIONS	N/A MILES
GROSS LENGTH OF PROJECT	1.301 MILES

NOTE: EXCEPT AS MAY OTHERWISE BE SPECIFIED ON THE PLANS OR IN THE SPECIAL PROVISIONS, ALL MATERIALS AND WORKMANSHIP ON THIS PROJECT SHALL CONFORM TO THE SOUTH CAROLINA DEPARTMENT OF TRANSPORTATION STANDARD SPECIFICATIONS FOR HIGHWAY CONSTRUCTION (2007 EDITION) AND THE STANDARD DRAWINGS FOR ROAD CONSTRUCTION IN EFFECT AT THE TIME OF THE RELEASE OF THE FINAL RFP.

CONSULTING ENGINEERING FIRM

HDR

HDR ENGINEERING, INC. OF THE CAROLINAS
 4400 LEEDS AVENUE, SUITE 450
 NORTH CHARLESTON, SOUTH CAROLINA 29405

ENGINEER OF RECORD

FOR CONSTRUCTION : _____ DATE _____

P.I. = 67+25.26
 Δ = 413'04" (RT)
 L = 883.38'
 T = 441.89'
 R = 12,000.00'

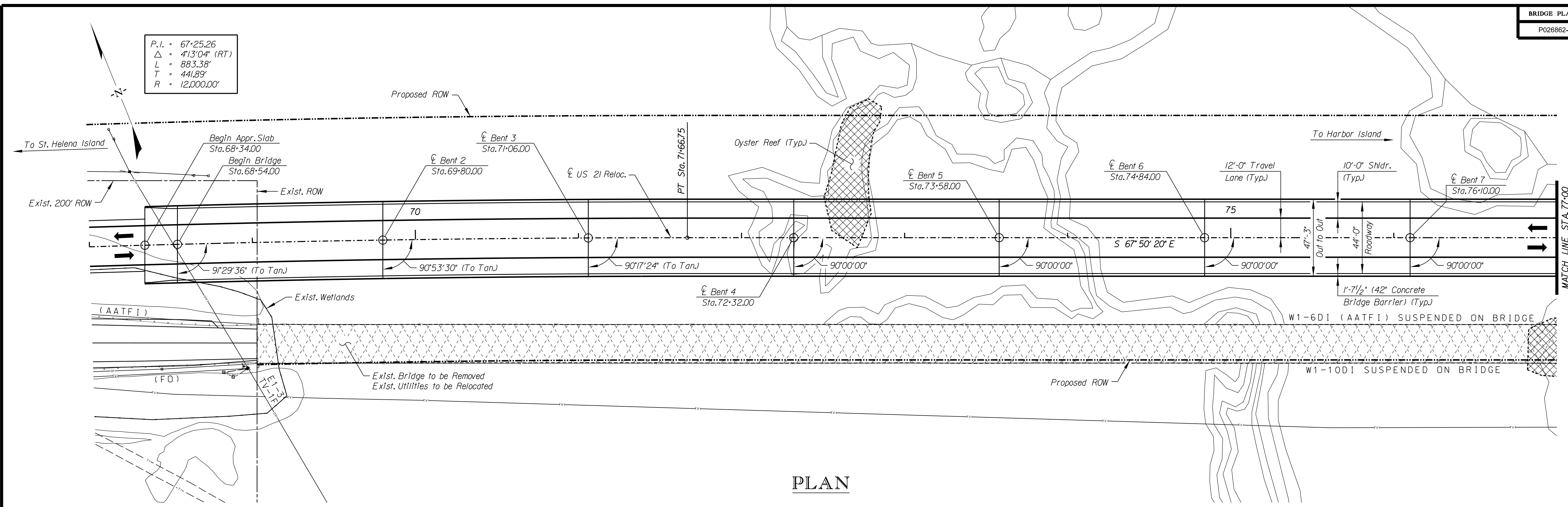

PLAN

3,602'-0" Total Bridge Length

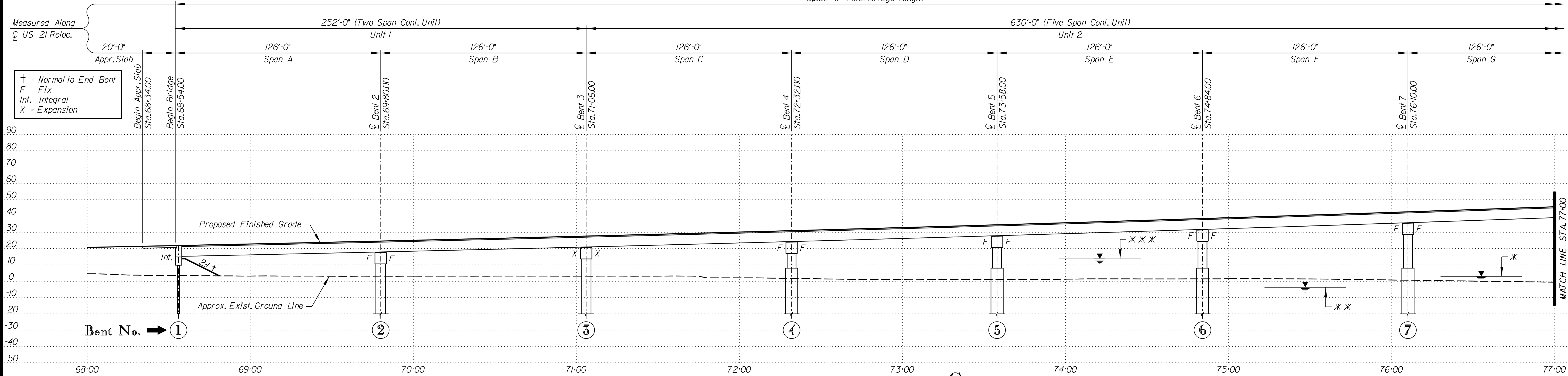

SECTION ALONG PROPOSED C

Legend:
 X - Mean Higher High Tide Elev. +2.97 (NAVD88)
 X X - Mean Lower Low Tide Elev. -3.72 (NAVD88)
 X X X - 10 Yr. Tidal Surge and Wave Height Elev. +13.7 (NAVD88)

CONCEPTUAL PLANS
 DO NOT USE FOR CONSTRUCTION

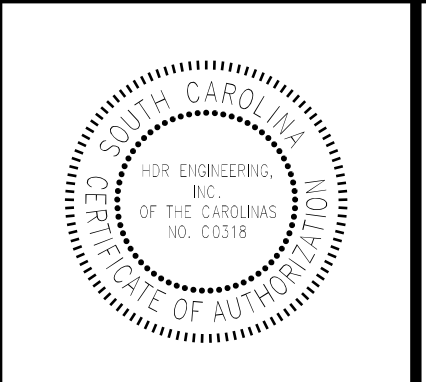
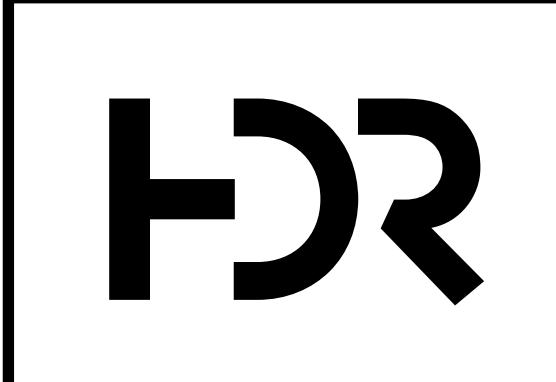

REV.			
REV.			
REV.			
REVIEWED	B. CARTER		
QUAN.			
DR.	WST	BNC	03/17
DES.	TKA	BNC	01/17
BY	CHK.	DATE	

SOUTH CAROLINA
 DEPARTMENT OF TRANSPORTATION
 BRIDGE PLAN AND
 PROFILE (1)
 US 21 BRIDGE REPLACEMENT
 OVER HARBOR RIVER
 COUNTY : BEAUFORT ROUTE : US 21 (SEA ISLAND PARKWAY)

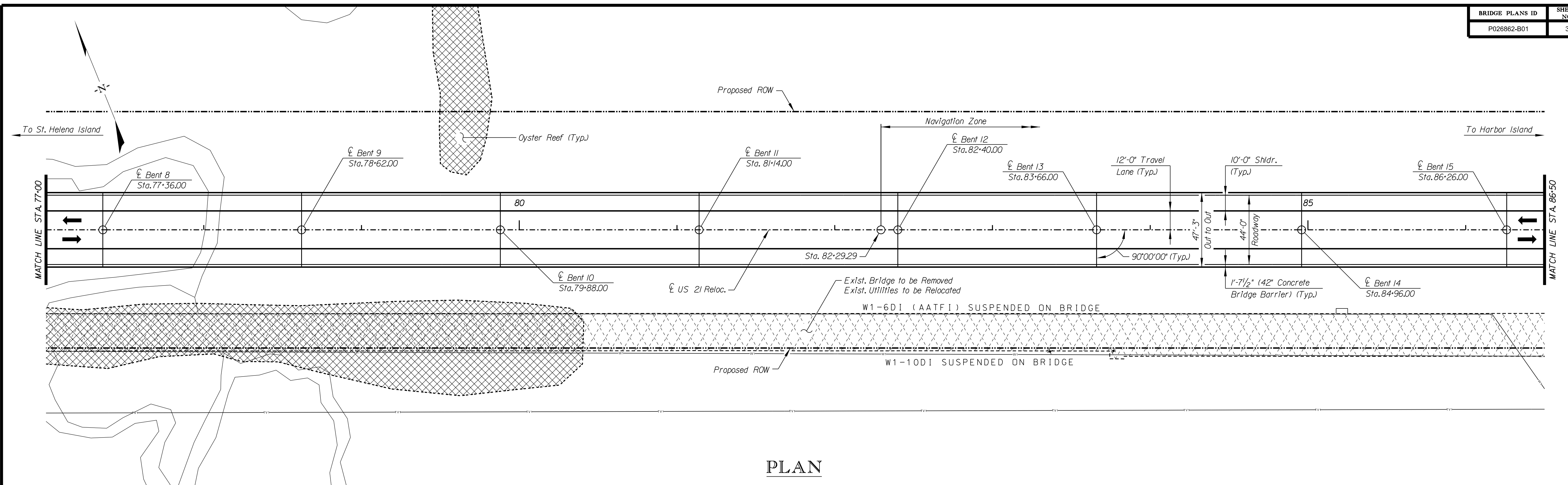

PLAN

3,602'-0" Total Bridge Length

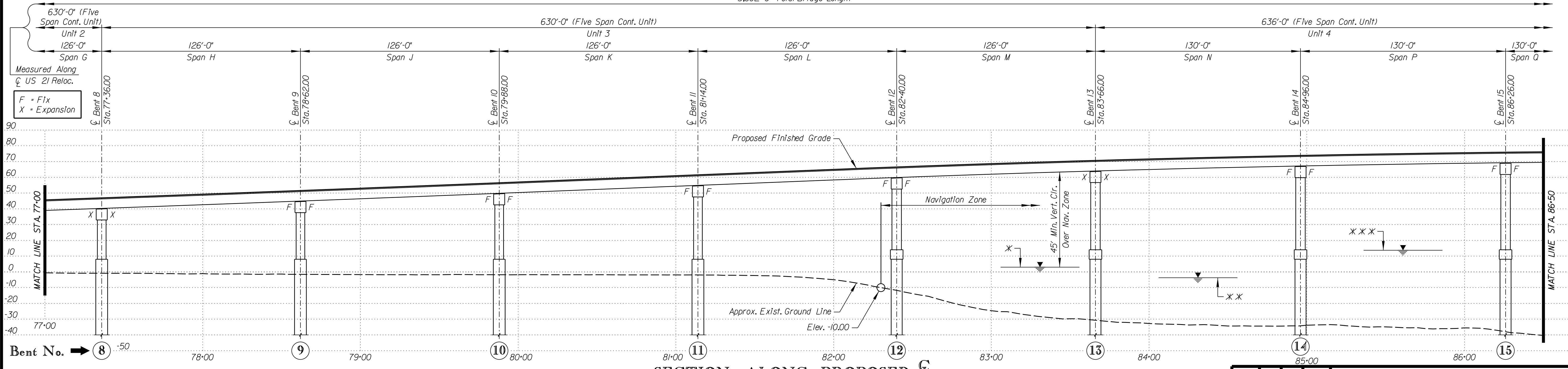

SECTION ALONG PROPOSED CL

Legend:
 * - Mean Higher High Tide Elev. +2.97 (NAVD88)
 ** - Mean Lower Low Tide Elev. -3.72 (NAVD88)
 *** - 10 Yr. Tidal Surge and Wave Height Elev. +13.7 (NAVD88)

CONCEPTUAL PLANS
 DO NOT USE FOR CONSTRUCTION

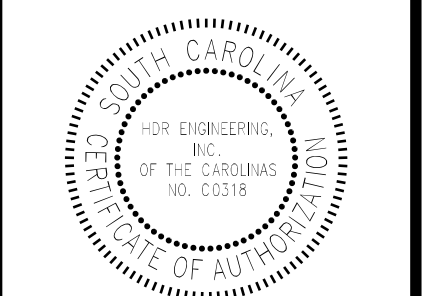

REV.			
REV.			
REV.			
REVIEWED	B. CARTER		
QUAN.			
DR.	WST	BNC	03/17
DES.	TKA	BNC	01/17
BY	CHK.	DATE	

SOUTH CAROLINA
 DEPARTMENT OF TRANSPORTATION
 BRIDGE PLAN AND
 PROFILE (2)
 US 21 BRIDGE REPLACEMENT
 OVER HARBOR RIVER
 COUNTY : BEAUFORT
 ROUTE : US 21 (SEA ISLAND PARKWAY)

P.I. = 112+83.49
 Δ = 38°54'03" (RT)
L = 1,493.68'
T = 776.92'
R = 2,200.00'

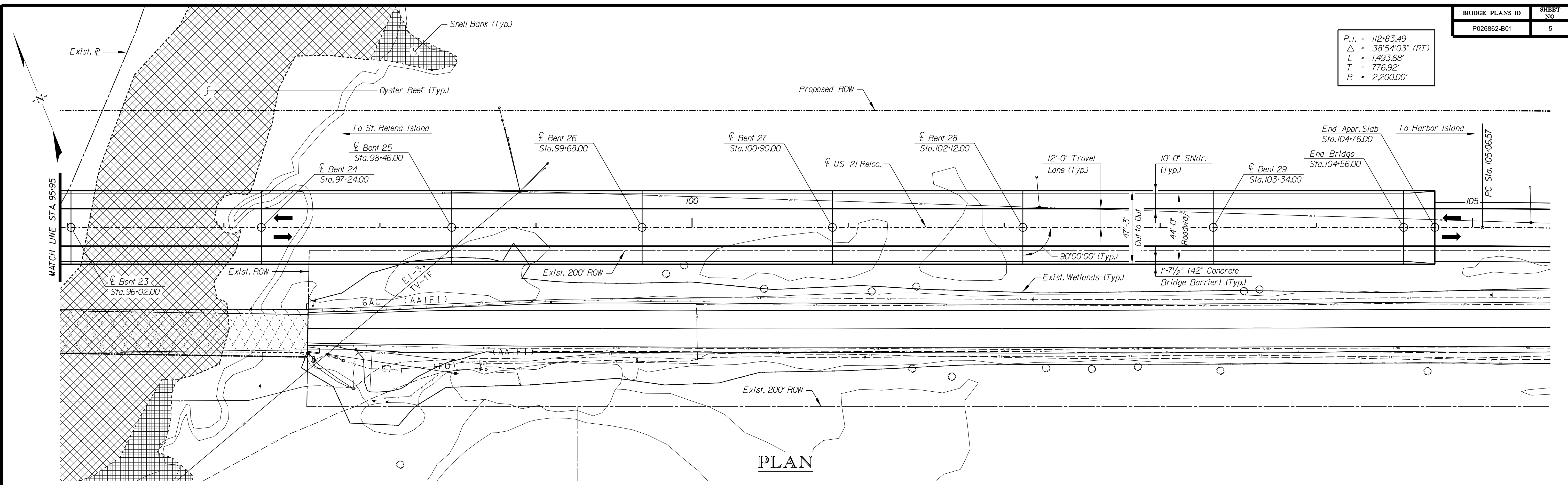

3,602'-0" Total Bridge Length

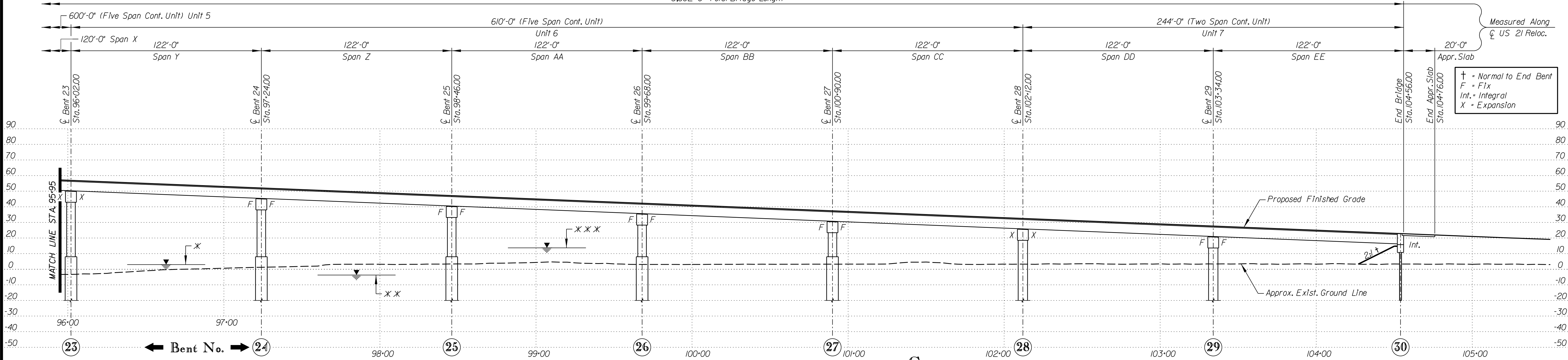

SECTION ALONG PROPOSED CL

Legend:
X - Mean Higher High Tide Elev. +2.97 (NAVD88)
X X - Mean Lower Low Tide Elev. -3.72 (NAVD88)
X X X - 10 Yr. Tidal Surge and Wave Height Elev. +13.7 (NAVD88)

CONCEPTUAL PLANS
DO NOT USE FOR CONSTRUCTION

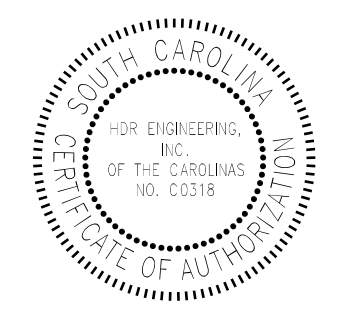
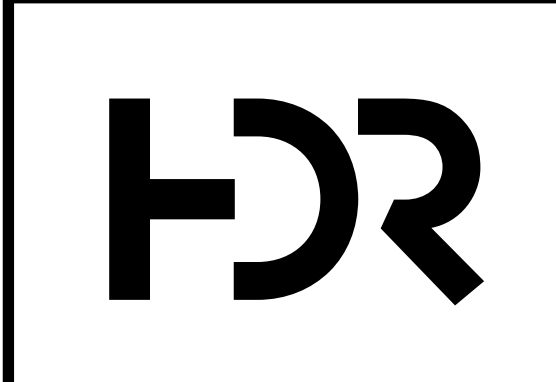

REV.	
REV.	
REV.	
REVIEWED	B. CARTER
QUAN.	
DR.	WST BNC 03/17
DES.	TKA BNC 01/17
BY	CHK. DATE

SOUTH CAROLINA
DEPARTMENT OF TRANSPORTATION
BRIDGE PLAN AND PROFILE (4)
US 21 BRIDGE REPLACEMENT OVER HARBOR RIVER
COUNTY : BEAUFORT ROUTE : US 21 (SEA ISLAND PARKWAY)

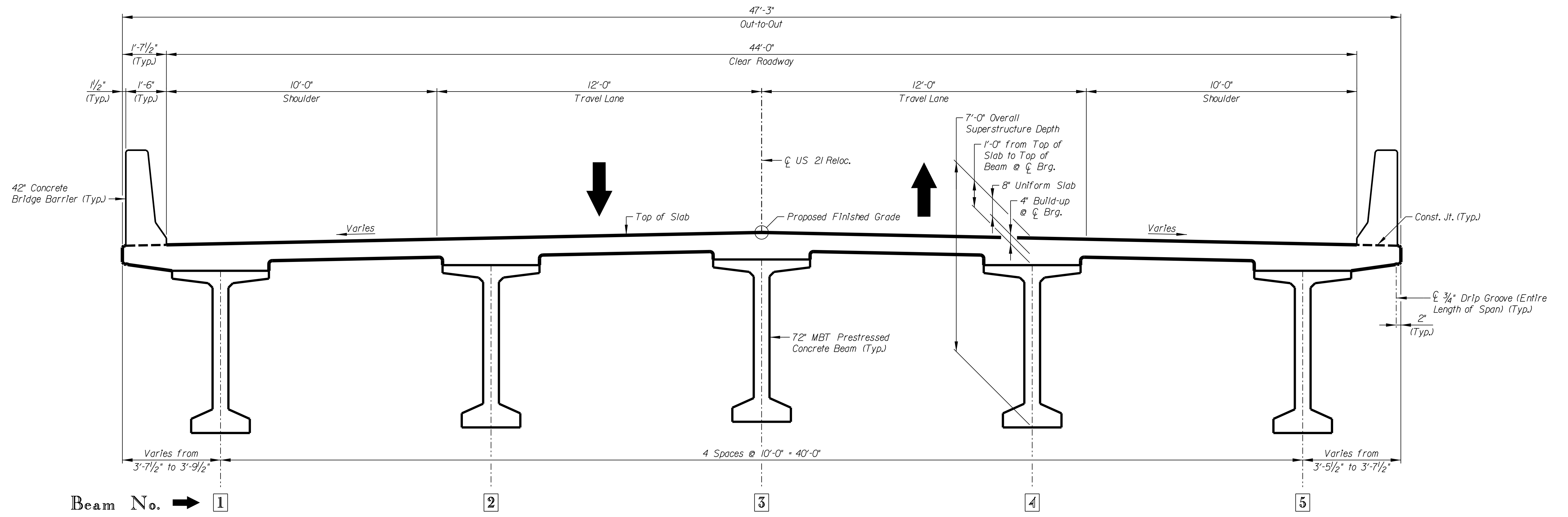

TYPICAL SECTION

CONCEPTUAL PLANS
DO NOT USE FOR CONSTRUCTION

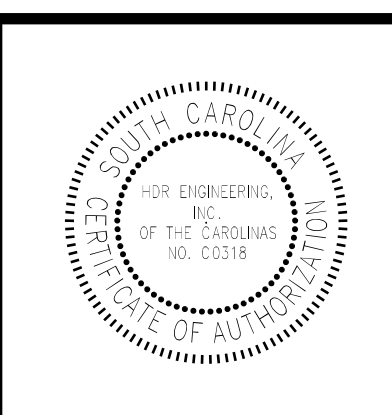
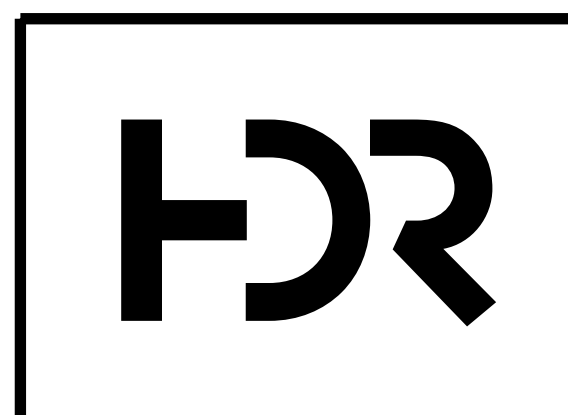

REV.					SOUTH CAROLINA DEPARTMENT OF TRANSPORTATION
REV.					
REV.					
REVIEWED	B. CARTER				
QUAN.					BRIDGE TYPICAL SECTION US 21 BRIDGE REPLACEMENT OVER HARBOR RIVER
DR.	WST	BNC	03/17		
DES.	TKA	BNC	01/17		
BY	CHK.	DATE			
COUNTY : BEAUFORT					ROUTE : US 21 (SEA ISLAND PARKWAY)