



# Log In and Password Reset Procedures

AASHTOWare Project Construction and Materials™  
rev. April 2023



*This page is intentionally left blank*



## Table of Contents

Introduction.....	1
Log In and Password Reset.....	1
SCDOT Employees.....	1
Log In (SCDOT Employees).....	1
Password Reset (SCDOT Employees).....	1
External Users.....	2
Initial Log In (External Users).....	2
Log In (External Users).....	2
Password Reset (External Users).....	2
Need Support .....	4



## Introduction

AASHTOWare Project™ (AWP) is a web-based program consisting of several modules designed to electronically allow the SCDOT to manage the entire lifecycle of construction contracts using a standardized format while providing a collaborative environment.

AASHTOWare Project Construction and Materials™ (PrCM) is a module designed to support the complete construction and materials management process.

## Log In and Password Reset

### SCDOT Employees

#### Log In (SCDOT Employees)

SCDOT Employees can ONLY access PrCM using the following link:

<https://scdot-pr-prod.infotechinc.com/>

After clicking the link, the website may automatically log in using your SCDOT credentials.

If you are not automatically log in, select either your SCDOT account or “Use another account” and log in using your SCDOT network username and password.

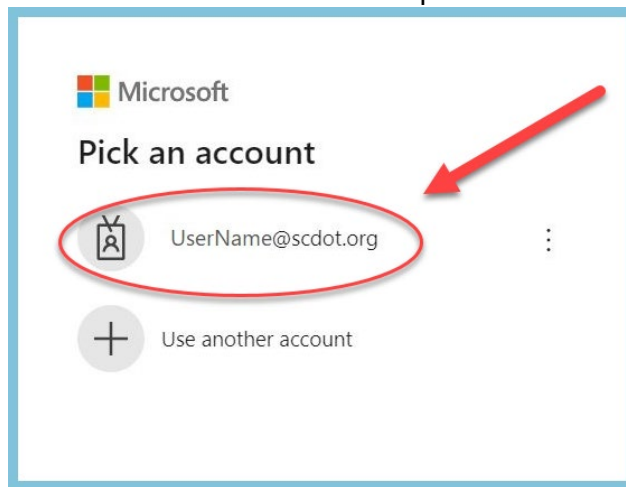

Figure 1 – Internal Log in

#### Password Reset (SCDOT Employees)

SCDOT Employees will not be able to change their SCDOT network password using PrCM.

SCDOT Employee must be change their network password following standard SCDOT password management procedures.

For assistance, please call the SCDOT Helpdesk at (803)737-1670 or submit an online ticket at:

<http://apps.sharepoint.dot.state.sc.us/HelpDeskApp/default.aspx>



## External Users

External users are authorized users not employed by the SCDOT who require access to PrCM.

Examples of external users are:

- Consultants
- Vendors (Contractors)
- FHWA
- Local Agencies.

### Initial Log In (External Users)

First time users must change password before attempting to login. Refer to the section “Password Reset (External Users)”.

### Log In (External Users)

External users access PrCM using the following link:

<https://scdot-pr-prod-ext.infotechinc.com/>

SCDOT Employees will not be able to access PrCM using this link.

Enter your provided username, new password, and press “Log On”.

**5 incorrect login attempts from the login or change password screen will temporarily lock your account for 30 minutes. These 5 attempts also include trying to login to an account with an overdue password change.**

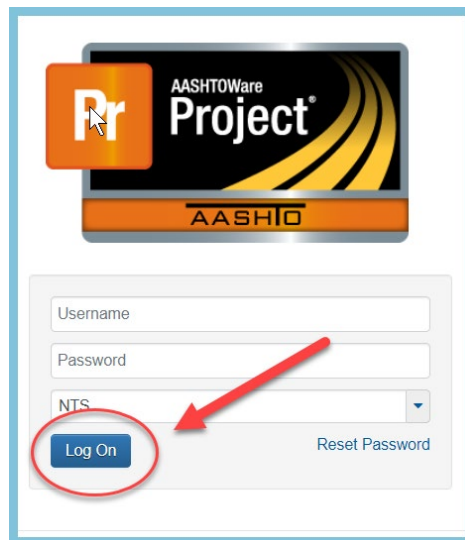

Figure 2 - External Login



### Password Reset (External Users)

Externals users may change their PrCM password using the following link. **Passwords are required to be reset every 90 days. Failure to do so will prevent a user from accessing the system.**

<https://scdot-sts.infotechinc.com/adfs/portal/updatepassword/>

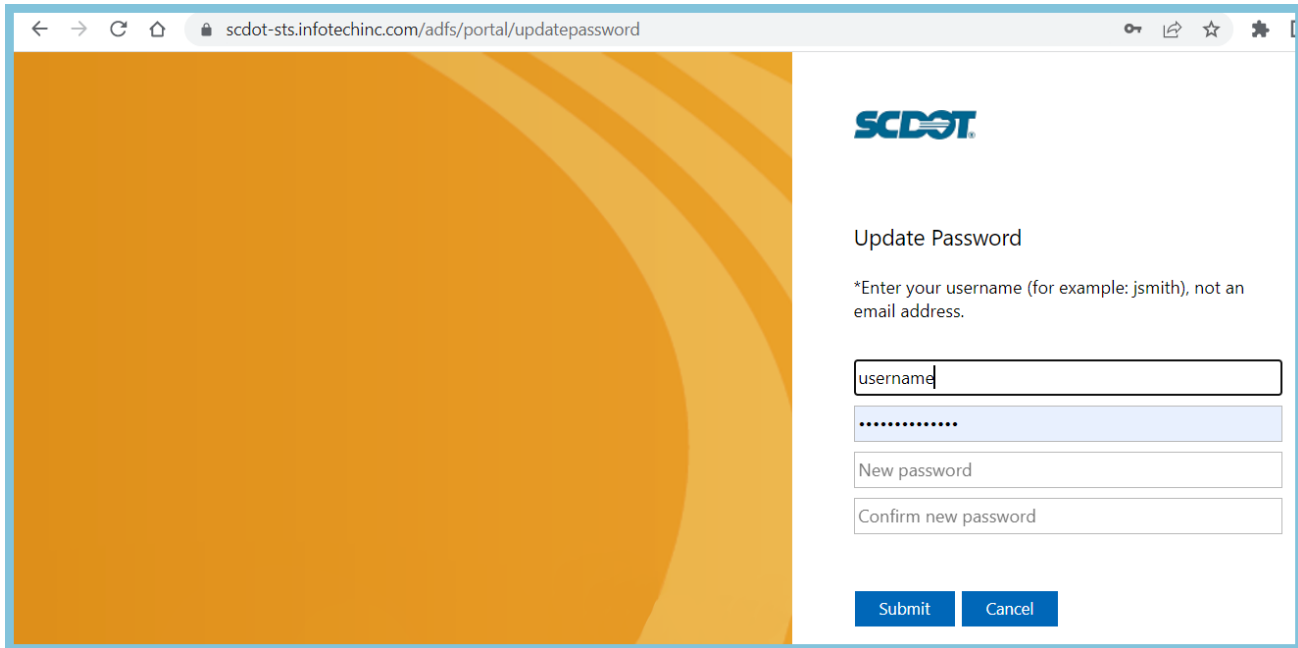

Figure 3 – Reset Password



# Need Support?

*For all AASHTOWare Project  
related support, please contact:*

## **Construction Support**

[AWPConstSupport@scdot.org](mailto:AWPConstSupport@scdot.org)

## **Materials Support**

[AWPMaterialsSupport@scdot.org](mailto:AWPMaterialsSupport@scdot.org)

## **Additional Support**

*For training and additional resources please visit*

<https://www.scdot.org/business/aashtowareproject.aspx>



**South Carolina Department of Transportation**